



FITTING INSTRUCTIONS FOR ECC0257 LHS GENERATOR COVER
KAWASAKI NINJA 400/250 2018-



Page | 1

In this kit there should be:
 1 x Engine Case Cover (ECC0257).
 3 x Engine Case Cover Spacers (S0820).
 3 x M6x35mm long cap head bolts.
 3 x M6 Washers.

PLEASE READ THESE INSTRUCTIONS FULLY BEFORE STARTING

THIS KIT CONTAINS THE ITEMS PICTURED AND LISTED ABOVE.
DO NOT PROCEED UNTIL YOU ARE SURE ALL PARTS ARE PRESENT.

Please note that the way the kit is packed does not necessarily represent the way of mounting to the bike

Please note that in cases where kits are packed with rubber washers holding the components onto the bolt – *the rubber washers should be thrown away!*

THE PARTS SHOWN MAY BE REPRESENTATIVE ONLY (FOR CLARITY OF INSTRUCTIONS ONLY)

Digital copies of these instructions are available to download from www.rg-racing.com

GENERAL TORQUE SETTINGS

M4 BOLT = 8Nm
 M5 BOLT = 12Nm
 M6 BOLT = 15Nm
 M8 BOLT = 20Nm
 M10 BOLT = 40Nm

R&G Racing
 Unit 1, Shelley's Lane, East Worldham, Alton, Hampshire, GU34 3AQ
 Tel: +44 (0)1420 89007 Fax: +44 (0)1420 87301 www.rg-racing.com Email: info@rg-racing.com



Picture 1



Picture 2



Picture 3

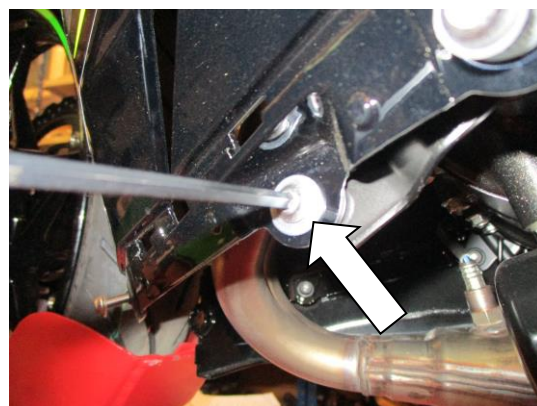

Picture 4

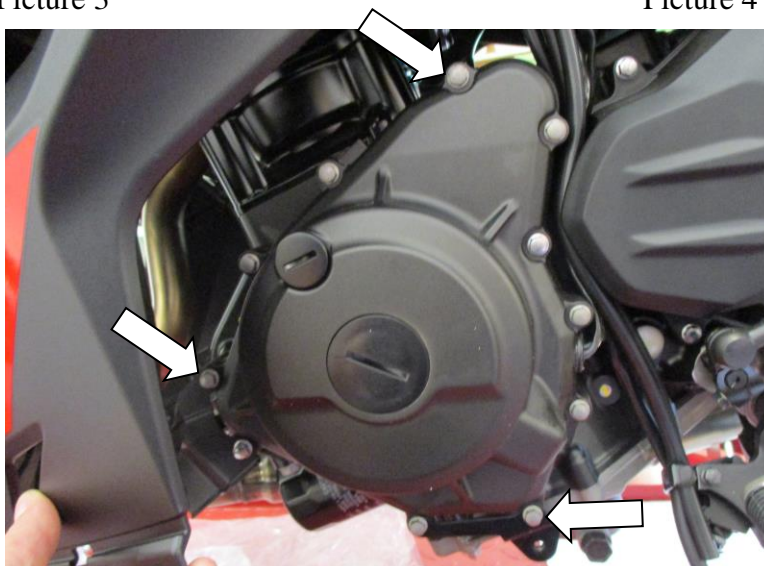

Picture 5



Fitting instructions

- Please make sure the engine is cold before proceeding with the fitting of the R&G cover.
- Fit the three spacers into the three holes of the engine case cover as shown in the diagram below (these should be a tight fit to secure in position while fitting (ensure they are correctly seated before proceeding, once tightened they will remain in position).

Page | 3

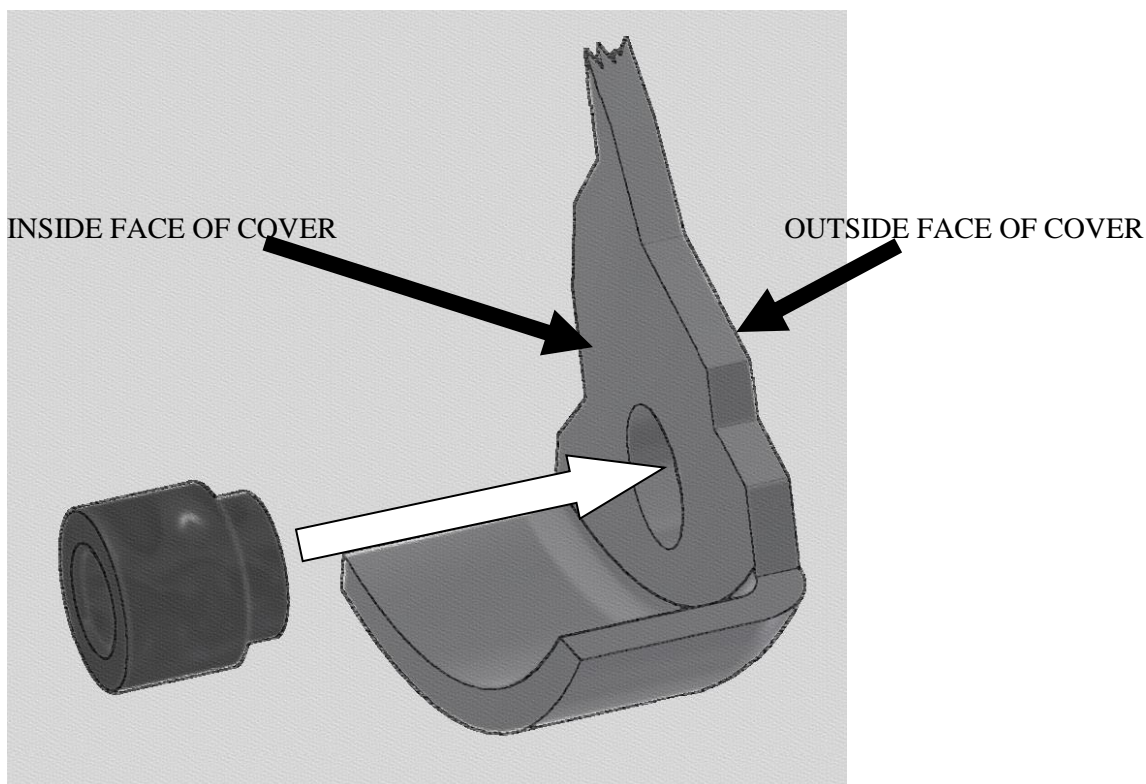

- Remove the plastic pull rivet arrowed in picture 1.
- Remove the three bolts arrowed in pictures 2 and 3, then remove the lower fairing/belly pan.
- Remove the fairing bolt arrowed in picture 4.
- Gently ease fairing away from the engine and remove the three bolts arrowed in picture 5, hold the cover loosely over the case to help identify the correct ones. **DO NOT REMOVE ALL OF THE CASE BOLTS.**
- Carefully offer up the R&G cover to the engine and carefully fit it over the engine casing. Ensure that the three R&G bolts are lined up with the holes in the engine casing, and then push on as far as it will go.
- Fit the bolts with washers through the Engine Case Cover and into the engine case.
- With a 5mm Allen key tighten the bolts equally so that they pull the cover into place. **DO NOT FULLY TIGHTEN.**
- Finally use a torque wrench set at 10 Nm (7 Lb ft) to fully tighten.
- Refit the fairings as original and refit all the removed bolts and tighten.

R&G Racing

Unit 1, Shelley's Lane, East Worldham, Alton, Hampshire, GU34 3AQ

Tel: +44 (0)1420 89007 Fax: +44 (0)1420 87301 www.rg-racing.com Email: info@rg-racing.com



- It is suggested that you check the tightness of the mounting bolts on a regular basis i.e. when cleaning, after the first heat cycle of the engine and then once a month.
- NOTE for the cleaning of this product you should only use a soft polishing cloth and a mild general cleaning agent.
- AVOID HARMFUL CHEMICALS. IF IN DOUBT DO NOT USE AS THEY COULD ALTER THE STRENGTH OF THE COVER.
- R&G will accept no liability if the above procedure and torque settings are not followed.

ISSUE 1 23/05/2018 (NSY)

CONSUMER NOTICE

The catalogue description and any exhibition of samples are only broad indications of the Products and R&G may make design changes which do not diminish their performance or visual appeal and supplying them in such state shall conform to the order. The Buyer acknowledges no representation or warranty (other than as to title) has been given or will apply to the Products other than those in R&G's order or confirmation and the Buyer confirms it has chosen the Products as being of merchantable quality and suitable for its particular purposes. Where R&G fits the Products or undertakes other services it shall exercise reasonable skill and care and rectify any fault free of charge unless the workmanship has been disturbed. The Buyer is responsible for ensuring that the warranty on the motorcycle is not affected by the fitting of the Products. On return of any defective Products R&G shall at its option either supply a replacement or refund the purchase money but shall not be liable if the Products have been modified or used or maintained otherwise than in accordance with R&G's or manufacturer's instructions and good engineering practice or if the defect arises from accident or neglect. Other than identified above and subject to R&G not limiting its liability for causing death and personal injury, it shall not be liable for indirect or consequential loss and otherwise its liability shall be limited to the amounts paid by the Buyer for the Products or the fitting or service concerned. These terms do not affect the Buyer's statutory rights.

R&G RACING RETURNS POLICY (NON-FAULTY GOODS)

Returns must be pre-authorized (if not pre-authorized the return will be rejected). Goods may only be returned direct to us if they were purchased direct from us (customer must prove if necessary). Otherwise to be returned to original vendor. Goods must be in re-sellable condition, in the opinion of R&G Racing. All returns are subject to a 25% restocking and handling fee (25% of the gross value exc. P&P – at the prevailing price at time of purchase). The customer must pay any and all carriage charges. No returns of discontinued products, unless within 14 days of purchase. This policy does not affect your statutory rights and does not refer to faulty goods.

R&G Racing

Unit 1, Shelley's Lane, East Worldham, Alton, Hampshire, GU34 3AQ

Tel: +44 (0)1420 89007 Fax: +44 (0)1420 87301 www.rg-racing.com Email: info@rg-racing.com



NOTICE DE MONTAGE POUR ECC0257
PROTECTION CARTER GAUCHE
KAWASAKI NINJA 400/250 2018-

Page | 5



Le kit doit contenir :

- 1 x Protection carter moteur (ECC0257).
- 3 x Entretoises de protection carter moteur (S0820).
- 3 x M6x35mm Boulons.
- 3 x M6 Rondelles.

LIRE ATTENTIVEMENT LA NOTICE AVANT DE PROCÉDER AU MONTAGE

Le kit contient les articles exposés ci-dessous, vérifier que toutes les pièces soient présentes avant de procéder au montage.

La façon dont le kit est emballé ne correspond pas forcément à la façon de monter les pièces sur la moto.

LES PARTIES PRÉSENTÉES PEUVENT ÊTRE UNIQUEMENT REPRESENTATIVES (POUR LA CLARTE DES INSTRUCTIONS UNIQUEMENT)

Notez que si les kits sont emballés avec des rondelles en caoutchouc servant à tenir les composants, ces rondelles doivent être jetées)

Notice disponible au téléchargement sur www.rg-racing.com

VALEURS DE SERRAGE RECOMMANDÉES

M4 BOULON = 8Nm
M5 BOULON = 12Nm
M6 BOULON = 15Nm

R&G Racing

Unit 1, Shelley's Lane, East Worldham, Alton, Hampshire, GU34 3AQ
Tel: +44 (0)1420 89007 Fax: +44 (0)1420 87301 www.rg-racing.com Email: info@rg-racing.com



M8 BOULON = 20Nm
M10 BOULON = 40Nm



Photo 1



Photo 2



Photo 3

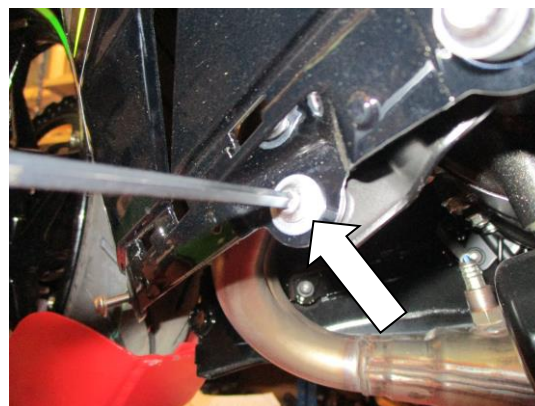

Photo 4

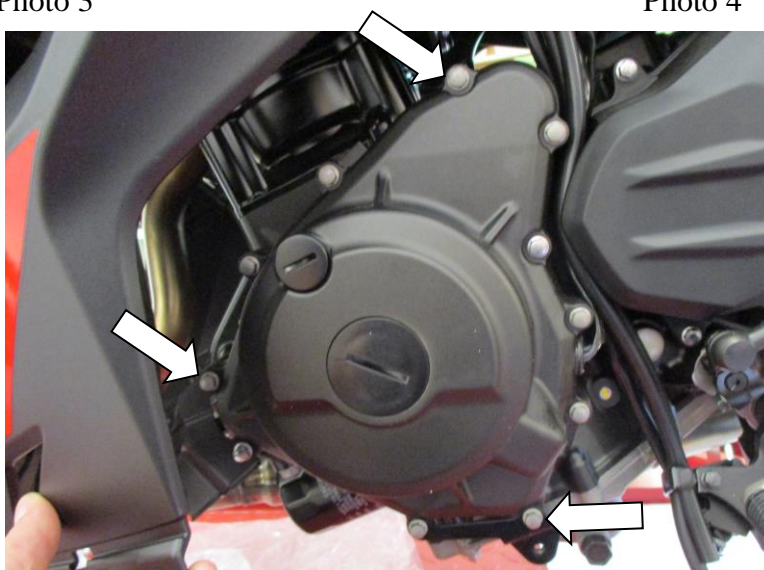

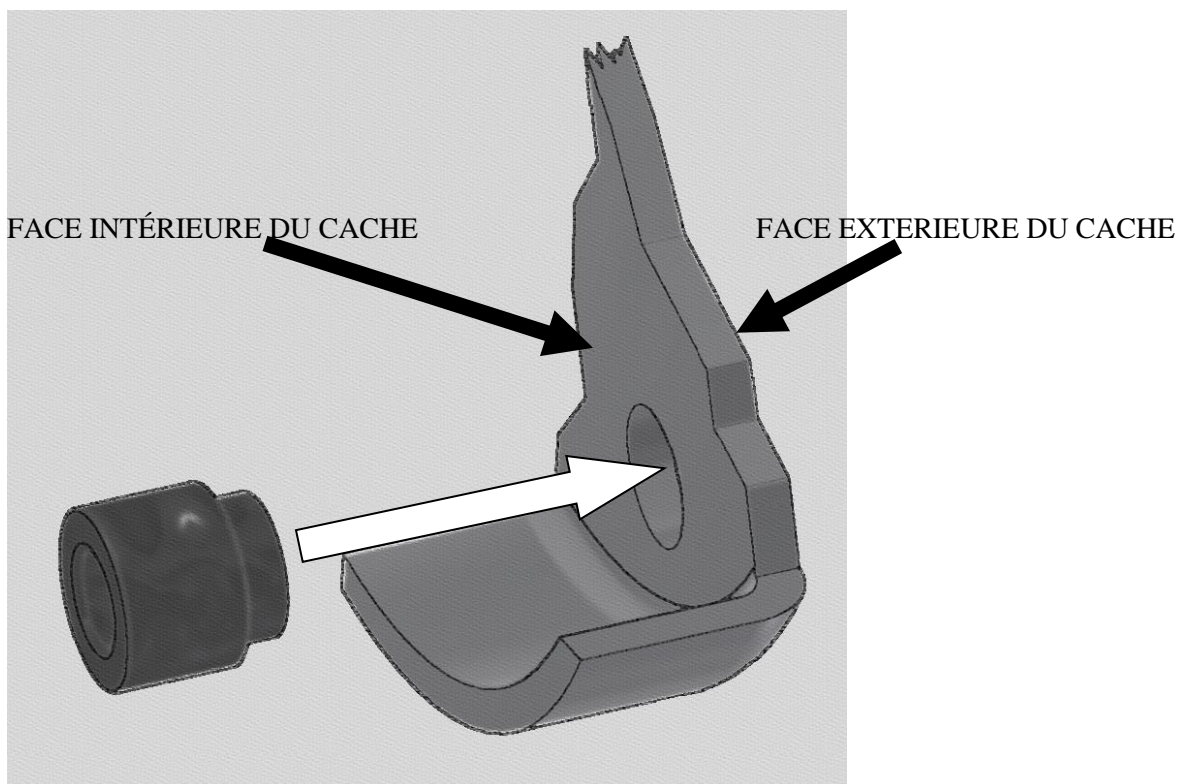

Photo 5

NOTICE DE MONTAGE :

Page | 7

- Veiller à ce que le moteur soit froid.
- Insérer les 3 entretoises dans les 3 trous de la protection carter moteur, voir schéma ci-dessous. Elles doivent se positionner correctement pour fixer la position au cours du montage (Veiller à ce qu'elles soient correctement positionnées, une fois serrées elles resteront en position).



- Enlever le rivet indiqué sur la photo 1.
- Enlever les 3 boulons indiqués sur les photos 2 et 3, puis enlever le ventre creux de carénage.
- Enlever le boulon de carénage, voir photo 4.
- Enlever le carénage du moteur puis enlever les 3 boulons, voir photo 5, tenir le couvercle autour du carter pour aider à les identifier. **NE PAS ENLEVER TOUS LES BOULONS DE CARTER.**
- Monter la protection R&G sur le carter moteur. Veiller à ce que les 3 boulons R&G soient alignés up avec les trous du carter moteur, puis poussez jusqu'à la limite.
- Insérer les boulons avec rondelles dans la protection carter moteur puis dans le carter moteur.
- A l'aide d'une clé Allen 5mm, serrer les boulons de façon identique de façon à ce que la cache se mette en place. **NE PAS SERRER COMPLETEMENT.**
- Utiliser une clé dynamométrique à 10 Nm (7 Lb ft) pour bloquer.

R&G Racing

Unit 1, Shelley's Lane, East Worldham, Alton, Hampshire, GU34 3AQ

Tel: +44 (0)1420 89007 Fax: +44 (0)1420 87301 www.rg-racing.com Email: info@rg-racing.com



- Remonter les carénages de la moto en procédant à l'inverse du démontage, et serrer.
- Nous vous suggérons de vérifier le serrage au moins une fois par mois, lors du nettoyage par exemple.
- NOTE : Pour le nettoyage, vous devriez utiliser uniquement un chiffon doux et un agent nettoyant doux.
- Ne pas utiliser d'agents chimiques qui pourraient altérer l'efficacité de la protection.
- R&G n'acceptera aucune responsabilité en cas de mauvais couple de serrage ou d'utilisation inappropriée d'agents nocifs.

ISSUE 1 23/05/2018 (NSY)

CONSUMER NOTICE

The catalogue description and any exhibition of samples are only broad indications of the Products and R&G may make design changes which do not diminish their performance or visual appeal and supplying them in such state shall conform to the order. The Buyer acknowledges no representation or warranty (other than as to title) has been given or will apply to the Products other than those in R&G's order or confirmation and the Buyer confirms it has chosen the Products as being of merchantable quality and suitable for its particular purposes. Where R&G fits the Products or undertakes other services it shall exercise reasonable skill and care and rectify any fault free of charge unless the workmanship has been disturbed. The Buyer is responsible for ensuring that the warranty on the motorcycle is not affected by the fitting of the Products. On return of any defective Products R&G shall at its option either supply a replacement or refund the purchase money but shall not be liable if the Products have been modified or used or maintained otherwise than in accordance with R&G's or manufacturer's instructions and good engineering practice or if the defect arises from accident or neglect. Other than identified above and subject to R&G not limiting its liability for causing death and personal injury, it shall not be liable for indirect or consequential loss and otherwise its liability shall be limited to the amounts paid by the Buyer for the Products or the fitting or service concerned. These terms do not affect the Buyer's statutory rights.

R&G RACING RETURNS POLICY (NON-FAULTY GOODS)

Returns must be pre-authorized (if not pre-authorized the return will be rejected). Goods may only be returned direct to us if they were purchased direct from us (customer must prove if necessary). Otherwise to be returned to original vendor. Goods must be in re-sellable condition, in the opinion of R&G Racing. All returns are subject to a 25% restocking and handling fee (25% of the gross value exc. P&P – at the prevailing price at time of purchase). The customer must pay any and all carriage charges. No returns of discontinued products, unless within 14 days of purchase. This policy does not affect your statutory rights and does not refer to faulty goods.

R&G Racing

Unit 1, Shelley's Lane, East Worldham, Alton, Hampshire, GU34 3AQ

Tel: +44 (0)1420 89007 Fax: +44 (0)1420 87301 www.rg-racing.com Email: info@rg-racing.com



MONTAGEANLEITUNG FÜR ECC0257 MOTORGEHÄUSE-ABDECKUNG (LINKS)
KAWASAKI NINJA 400/250 2018-

Page | 9



Dieser Kit beinhaltet:

- 1 x Motorgehäuse-Abdeckung (ECC0257)
- 3 x Distanzhalter (S0820)
- 3 x M6x35mm Inbusschrauben
- 3 x M6 Unterlegscheiben

BITTE LESEN SIE DIE MONTAGEANLEITUNG DURCH, BEVOR SIE MIT DER MONTAGE BEGINNEN:

ALLE KIT-TEILE SIND UNTEN ABGEBILDET UND GEKENNZEICHNET. BEVOR SIE MIT DER MONTAGE BEGINNEN, ÜBERPRÜFEN SIE, DASS ALLE TEILE VORHANDEN SIND.

Hinweis: Die Verpackung der Teile stellt nicht die Reihenfolge der Montage dar.

Hinweis für Kits mit Plastikunterlegscheiben an den Schrauben – *Diese Plastikunterlegscheiben werden nicht für den Einbau benötigt!*

DIE UNTEN ABGEBILDETEN TEILE DIENEN LEDIGLICH ZUR ERKLÄRUNG

Eine digitale Version dieser Montageanleitung kann auf folgender Seite heruntergeladen werden: www.rg-racing.com

ANZUGSDREHMOMENT:

- M4 SCHRAUBE = 8 NM
- M5 SCHRAUBE = 12NM
- M6 SCHRAUBE = 15NM
- M8 SCHRAUBE = 20NM
- M10 SCHRAUBE = 40NM

R&G Racing

Unit 1, Shelley's Lane, East Worldham, Alton, Hampshire, GU34 3AQ
 Tel: +44 (0)1420 89007 Fax: +44 (0)1420 87301 www.rg-racing.com Email: info@rg-racing.com



Abbildung 1



Abbildung 2



Abbildung 3



Abbildung 4



Abbildung 5

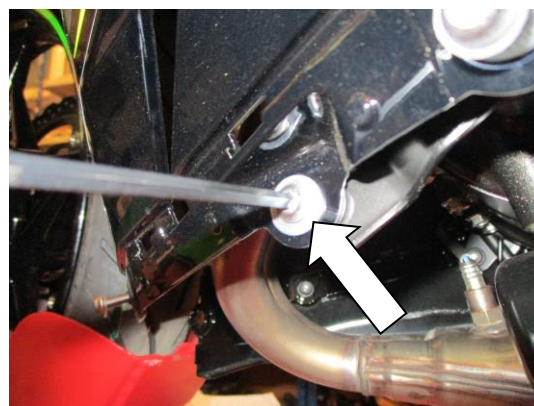

Montageanleitung

- Bitte unbedingt darauf achten, dass der Motor kalt ist, bevor Sie mit der Montage der R&G Abdeckung beginnen.
- Montieren Sie die drei Distanzhalter an den drei Öffnungen in der Motorgehäuse-Abdeckung wie unten in der Zeichnung (enge Passform: bitte überprüfen, dass die Distanzhalter richtig positioniert sind - sobald sie fixiert sind, bleiben sie in Position).

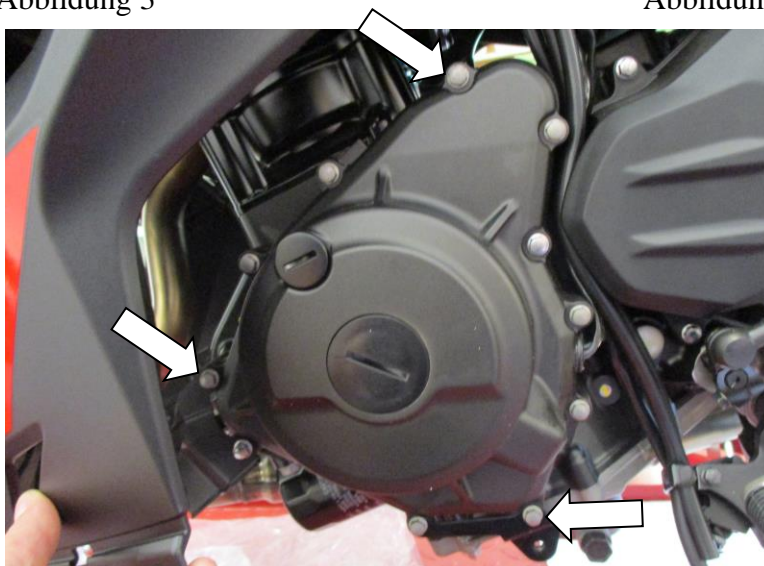
Page | 11

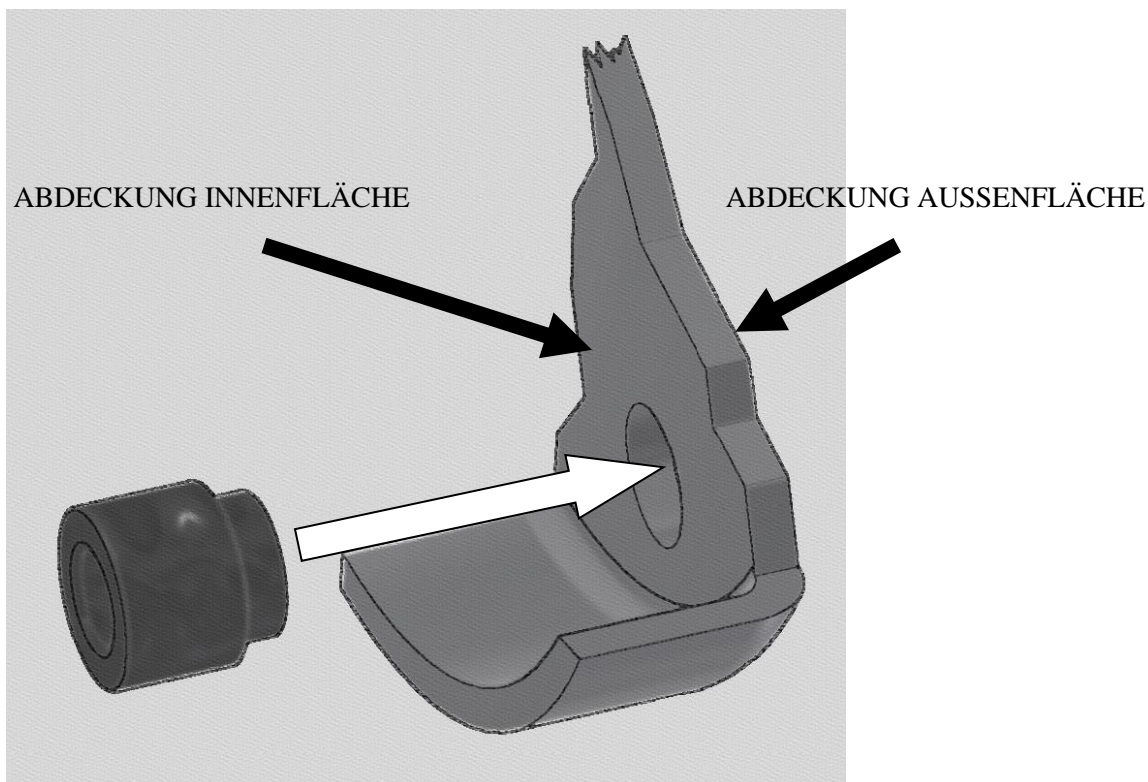

- Entfernen Sie die Plastikniete, die in Abbildung 1 gekennzeichnet ist.
- Entfernen Sie die drei Schrauben, die in den Abbildungen 2 und 3 markiert sind, dann entfernen Sie die untere Verkleidung / das Verkleidungsunterteil.
- Entfernen Sie die Verkleidungsschraube, die in Abbildung 4 mit einem Pfeil gekennzeichnet ist.
- Die Verkleidung vorsichtig vom Motorrad entfernen, und die drei Motorschrauben, die in Abbildung 5 gekennzeichnet sind entfernen. Um die richtigen Schrauben identifizieren zu können, halten Sie die Abdeckung an das Gehäuse. **ENTFERNEN SIE NICHT ALLE SCHRAUBEN AM MOTORGEHÄUSE.**
- Die R&G Abdeckung an den Motor ansetzen und vorsichtig am Gehäuse anbringen. Achten Sie darauf, dass die drei Öffnungen für die Schrauben mit den Bohrungen im Motorgehäuse ausgerichtet sind, dann die Abdeckung soweit wie möglich eindrücken.
- Führen Sie die Schrauben, die mit Unterlegscheiben versehen sind, durch die Motorgehäuse-Abdeckung ins Motorgehäuse.

R&G Racing

Unit 1, Shelley's Lane, East Worldham, Alton, Hampshire, GU34 3AQ

Tel: +44 (0)1420 89007 Fax: +44 (0)1420 87301 www.rg-racing.com Email: info@rg-racing.com



- Ziehen Sie die Schrauben mit einem 5mm Inbusschlüssel gleichmäßig an, sodass sie die Abdeckung in Position ziehen. **NICHT FESTZIEHEN.**
- Benutzen Sie einen Drehmomentschlüssel, der auf 10 N/m (7 Lb/ft) eingestellt ist, um die Schrauben festzuziehen.
- Montieren Sie die Verkleidungen wie ursprünglich wieder und montieren und befestigen Sie alle zuvor entfernten Schrauben wieder.
- Es wird empfohlen, die Festigkeit der Schrauben in regelmäßigen Abständen zu kontrollieren.
- **HINWEIS:** Bei der Reinigung dieses Produkts benutzen Sie nur ein weiches Poliertuch und ein mildes Putzmittel.
- **VERMEIDEN SIE SCHÄDLICHE CHEMIKALIEN. IM ZWEIFELSFALL NICHT BENUTZEN, DA SIE DIE FESTIGKEIT DER ABDECKUNG VERÄNDERN KÖNNEN.**
- R&G übernimmt keine Haftung, wenn die obengenannten Schritte nicht eingehalten werden oder die angegebenen Anzugsdrehmomente nicht angewendet werden.

AUSGABE 1 23/05/2018 (NSY)

CONSUMER NOTICE

The catalogue description and any exhibition of samples are only broad indications of the Products and R&G may make design changes which do not diminish their performance or visual appeal and supplying them in such state shall conform to the order. The Buyer acknowledges no representation or warranty (other than as to title) has been given or will apply to the Products other than those in R&G's order or confirmation and the Buyer confirms it has chosen the Products as being of merchantable quality and suitable for its particular purposes. Where R&G fits the Products or undertakes other services it shall exercise reasonable skill and care and rectify any fault free of charge unless the workmanship has been disturbed. The Buyer is responsible for ensuring that the warranty on the motorcycle is not affected by the fitting of the Products. On return of any defective Products R&G shall at its option either supply a replacement or refund the purchase money but shall not be liable if the Products have been modified or used or maintained otherwise than in accordance with R&G's or manufacturer's instructions and good engineering practice or if the defect arises from accident or neglect. Other than identified above and subject to R&G not limiting its liability for causing death and personal injury, it shall not be liable for indirect or consequential loss and otherwise its liability shall be limited to the amounts paid by the Buyer for the Products or the fitting or service concerned. These terms do not affect the Buyer's statutory rights.

R&G RACING RETURNS POLICY (NON-FAULTY GOODS)

Returns must be pre-authorized (if not pre-authorized the return will be rejected). Goods may only be returned direct to us if they were purchased direct from us (customer must prove if necessary). Otherwise to be returned to original vendor. Goods must be in re-sellable condition, in the opinion of R&G Racing. All returns are subject to a 25% restocking and handling fee (25% of the gross value exc. P&P – at the prevailing price at time of purchase). The customer must pay any and all carriage charges. No returns of discontinued products, unless within 14 days of purchase. This policy does not affect your statutory rights and does not refer to faulty goods.

R&G Racing

Unit 1, Shelley's Lane, East Worldham, Alton, Hampshire, GU34 3AQ

Tel: +44 (0)1420 89007 Fax: +44 (0)1420 87301 www.rg-racing.com Email: info@rg-racing.com