



LP0245

**FITTING INSTRUCTIONS FOR LP0245BK LICENCE PLATE BRACKET
KAWASAKI NINJA 400 2018 (FOR USE WITH STANDARD AND R&G MINI
INDICATORS (8mm))**

Page | 1



**THIS KIT CONTAINS THE ITEMS PICTURED AND LABELLED BELOW.
DO NOT PROCEED UNTIL YOU ARE SURE ALL PARTS ARE PRESENT.**

Please note that the way the kit is packed does not necessarily represent the way of mounting to the bike

THE PARTS SHOWN MAY BE REPRESENTATIVE ONLY (FOR CLARITY OF INSTRUCTIONS ONLY)

Digital copies of these instructions are available to download from www.rg-racing.com

GENERAL TORQUE SETTINGS

M4 BOLT = 8Nm
M5 BOLT = 12Nm
M6 BOLT = 15Nm
M8 BOLT = 20Nm
M10 BOLT = 40Nm

Please note that in cases where kits are packed with rubber washers holding the components onto the bolt – *the rubber washers should be thrown away!*

TOOLS REQUIRED

- Set of metric Allen keys to include 3, 4 and 5mm A/F sizes.
- Socket set to include 8, 12 and 13mm A/F socket and wrench.
 - Phillips driver.
 - Electrical pliers/crimps.
 - Small amount of super glue.

R&G Racing

Unit 1, Shelley's Lane, East Worldham, Alton, Hampshire, GU34 3AQ

Tel: +44 (0)1420 89007 Fax: +44 (0)1420 87301 www.rg-racing.com Email: info@rg-racing.com



LP0245

Page | 2

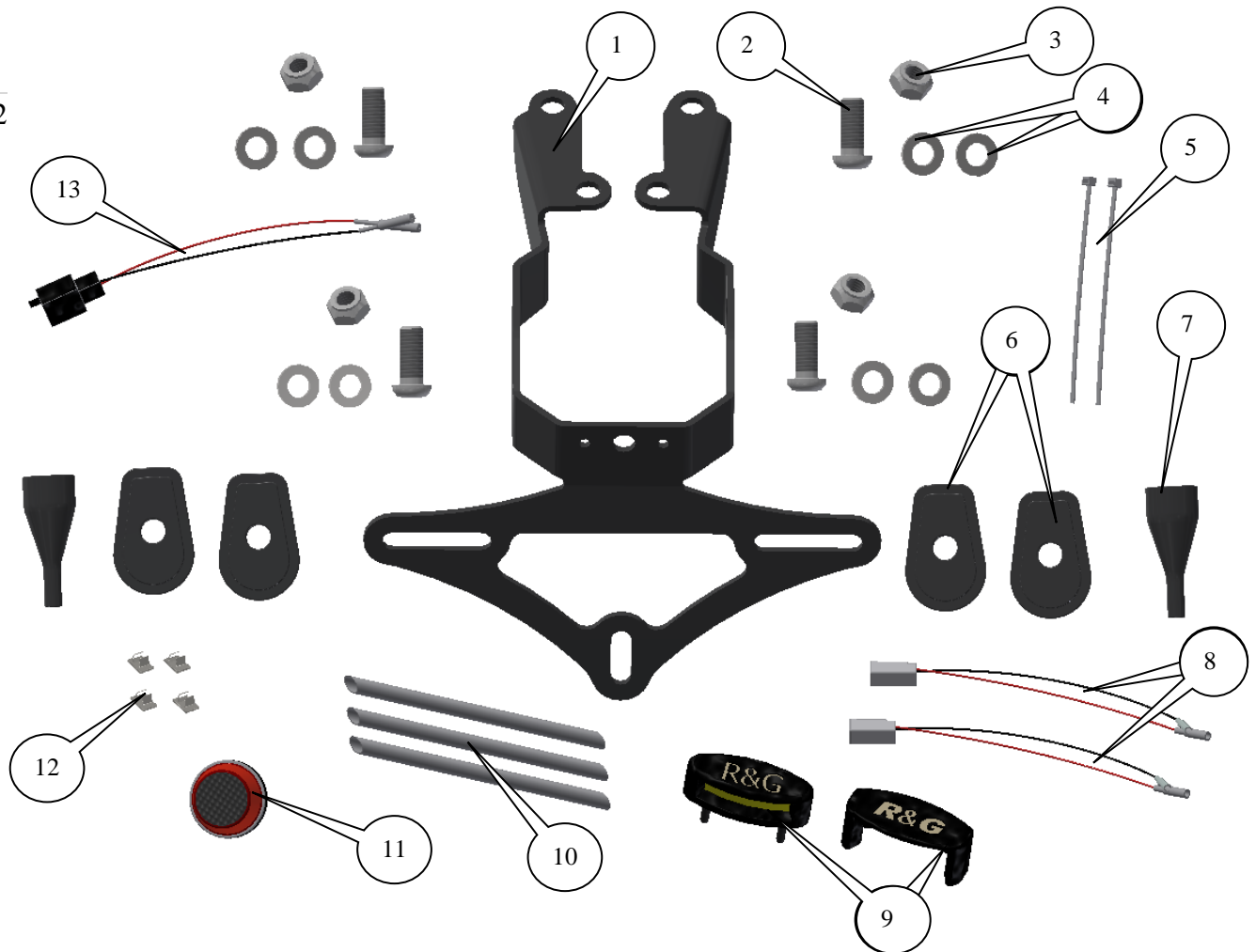

LEGEND

- ITEM 1 = LICENCE PLATE BRACKET (TB0245) (x1).
- ITEM 2 = M8 x 25mm LONG BUTTON HEAD BOLTS (x4).
- ITEM 3 = M8 NYLOC NUTS (x4).
- ITEM 4 = M8 WASHER (x8).
- ITEM 5 = CABLE TIES (x2).
- ITEM 6 = MINI INDICATOR ADAPTORS (I0039) (x4).
- ITEM 7 = SILICON INDICATOR NUT COVERS (IWC0002) (x2).
- ITEM 8 = MINI INDICATOR CONNECTORS (CON0032) (x2).
- ITEM 9 = LICENCE PLATE ILLUMINATOR ASSEMBLY (LA0002) (x1).
- ITEM 10 = 200mm LENGTH OF HEAT SHRINK (x3).
- ITEM 11 = REFLECTOR (REFL 1) (x1).
- ITEM 12 = CABLE CLIPS (x4).
- ITEM 13 = LICENCE PLATE ILLUMINATOR CONNECTOR (CON0007) (x1).

R&G Racing

Unit 1, Shelley's Lane, East Worldham, Alton, Hampshire, GU34 3AQ

Tel: +44 (0)1420 89007 Fax: +44 (0)1420 87301 www.rg-racing.com Email: info@rg-racing.com



LP0245



Picture 1

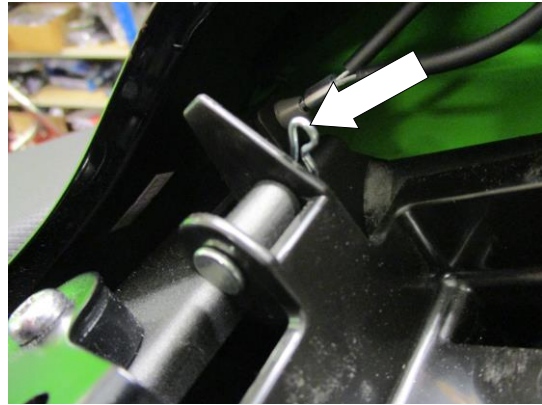

Picture 2

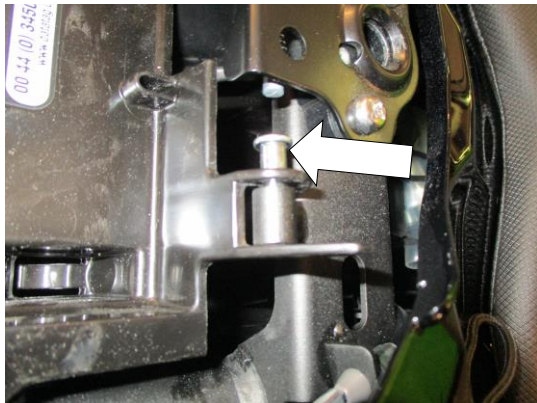

Picture 3

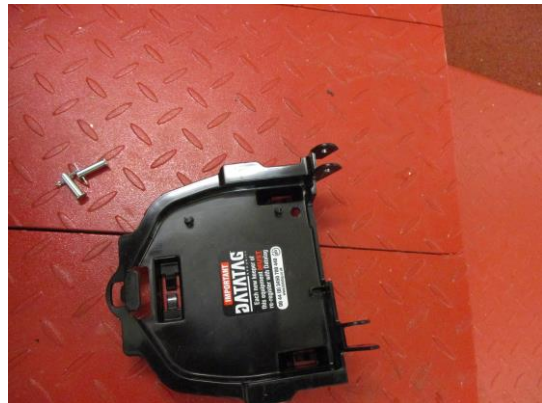

Picture 4

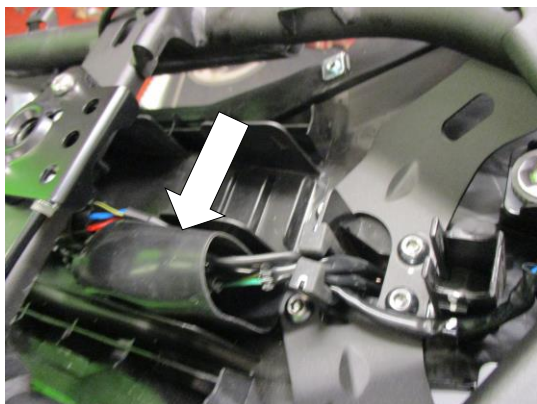

Picture 5

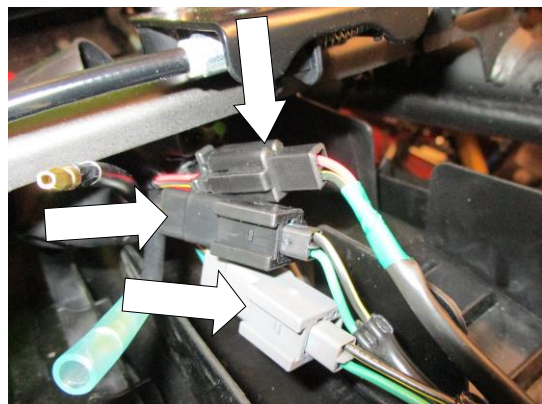

Picture 6



LP0245

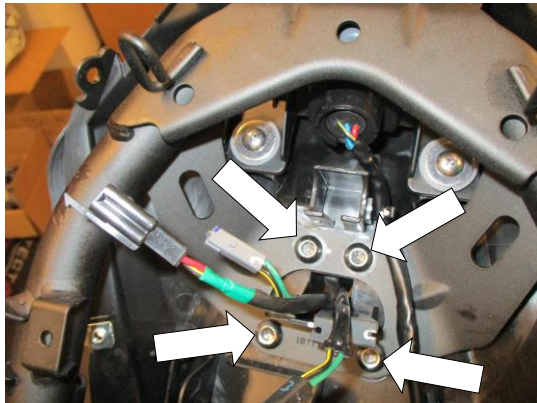

Picture 7



Picture 8



Picture 9



Picture 10



Picture 11



Picture 12



LP0245



Picture 13



Picture 14



Picture 15

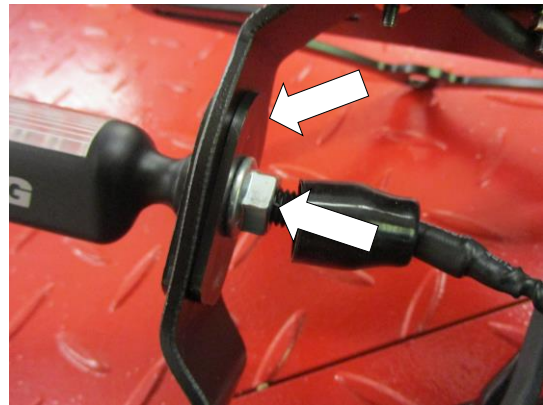

Picture 16

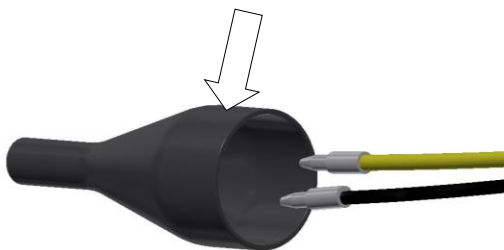

Picture 17

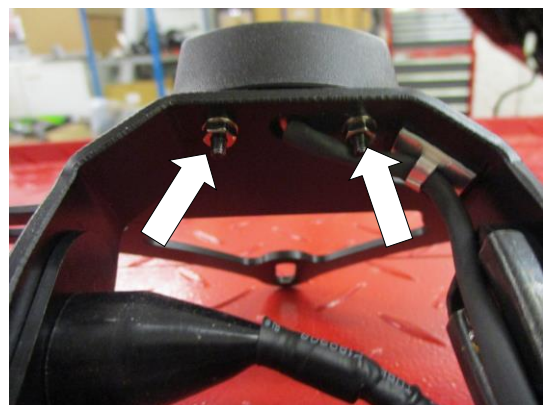

Picture 18



LP0245

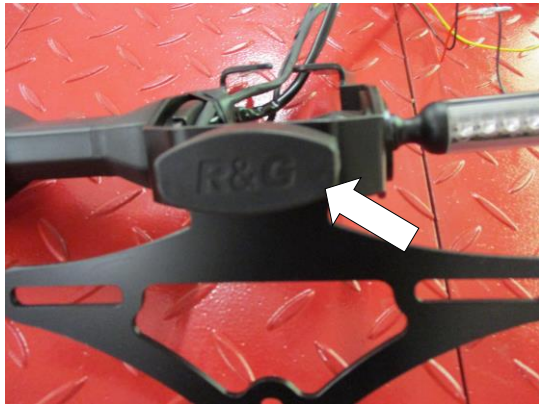

Picture 19



Picture 20



Picture 21

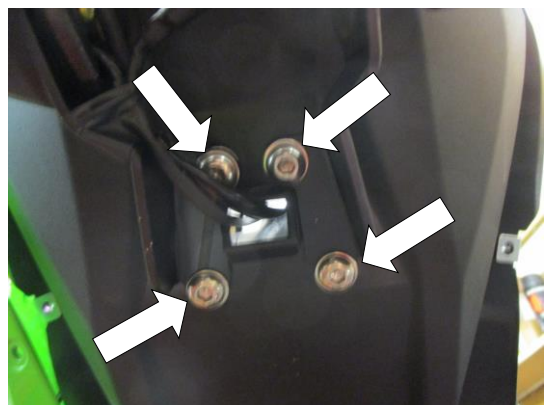

Picture 22

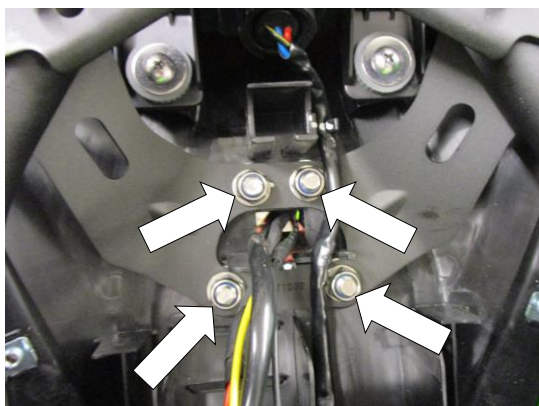

Picture 23



Picture 24



LP0245

Page | 7

FITTING INSTRUCTIONS

- To fit the R&G tail tidy, first remove the seat using the key as shown in picture 1.
- Remove the two 'R' clips indicated in picture 2 and remove the two pins indicated in picture 3.
- Remove the under-seat tray cover as shown in picture 4.
- Slide the rubber plug socket cover along the wiring loom to give access to the indicator and licence plate illuminator as indicated in picture 5.
- Disconnect the three plug sockets as arrowed in picture 6 (indicators and licence plate illuminator).
- Remove the four bolts arrowed in picture 7, while supporting the original licence plate bracket from underneath.
- Carefully lower the original licence plate bracket while feeding the wiring through the hole in the under-tray.

If reusing the original indicators

- Remove the screw arrowed in picture 8.
- Remove the indicator clamp bracket as shown in picture 9.
- Remove the indicator spreader plate as shown in picture 10.
- Gently squeeze the indicator stem and remove the indicator
- Repeat the above steps to remove the opposite indicator.
- Fit the indicators into the new licence plate bracket (item 1) and secure as shown in pictures 11,12,13, and 14.

If using the mini indicators

- To fit the R&G Mini Indicators (R&G mini indicator product code RG370 for bulb type and RG371 for LED type or RG372 for Aero Style led type).
- Position the two indicator adaptors (item 6 –I0039) onto the wiring of each indicator, ensuring the sides facing each other have the raised centre profile, before fitting the flanged nut supplied, as shown in pictures 15 and 16.
- Feed the indicator wiring through the nut/wire cover (item 7) as shown in pictures 16 and 17 (it helps if a small amount of liquid detergent is used) and position the nut cover over the nut.
- Fit one length of heat-shrink (item 10) to the wires of each indicator.

- Fit the R&G licence plate illuminator (item 9) as shown in pictures 18 and 19, please note you will have to fit the light shroud and use a small amount of adhesive to hold it in position. Fit one length of heat-shrink (item 10) to the wire. It is a good idea to reconnect to the wiring loom using the supplied connector (item 13) to check at this stage (if illumination fails, swap the bullet connections around).
- Tidy the wiring to the licence plate bracket using the supplied clips and cable ties (items 5 and 12).
- Offer the new licence plate bracket into position while feeding the wiring through the hole in the under-tray as shown in pictures 20 and 21.
- Fit the four button head bolts with washers (items 2 and 4) through the four holes in the new licence plate bracket as shown in picture 22.
- Secure using the four nuts with washers (items 3 and 4) as shown in picture 23, please ensure the wires are not crushed.

R&G Racing

Unit 1, Shelley's Lane, East Worldham, Alton, Hampshire, GU34 3AQ

Tel: +44 (0)1420 89007 Fax: +44 (0)1420 87301 www.rg-racing.com Email: info@rg-racing.com



LP0245

Page | 8

- Route the wiring as original and reconnect the licence plate illuminator and indicators to the original plug sockets.
- If using led mini indicators, you will have to use a resistor on each indicator (R and G product code RGR0001) to achieve the correct flash rate. It is a good idea to connect the indicators to the main loom using the supplied connectors (item 8) at this stage, if illumination fails please swap the bullet connection around.
- If using bulb mini indicators, it is a good idea to connect the indicators to the main loom using the supplied connectors (item 8) at this stage, if illumination fails please swap the bullet connection around.
- Refit the under-seat tray cover as original (as shown in picture 24).
- Refit the seat as original and licence plate (it may require drilling).
- **IMPORTANT: IF FITTING A FULL-SIZE LICENCE PLATE AND PLACING IT FAR DOWN ON THE LICENCE PLATE HANGER, THERE IS A SMALL CHANCE OF THE LICENCE PLATE HITTING THE BACK WHEEL UNDER HEAVY LOAD AND OVER LARGE BUMPS IN THE ROAD. IT IS YOUR RESPONSIBILITY TO CHECK FOR THIS POSSIBILITY AND TAKE AVOIDING ACTION. FAILURE TO CHECK THIS COULD RESULT IN SERIOUS INJURY.**
- Depending on local laws, attach enclosed reflector (item 11) in an appropriate location.
- Test the license plate illuminator and all lights before riding.

ISSUE 1 19/04/2018 (NSY)

CONSUMER NOTICE

The catalogue description and any exhibition of samples are only broad indications of the Products and R&G may make design changes which do not diminish their performance or visual appeal and supplying them in such state shall conform to the order. The Buyer acknowledges no representation or warranty (other than as to title) has been given or will apply to the Products other than those in R&G's order or confirmation and the Buyer confirms it has chosen the Products as being of merchantable quality and suitable for its particular purposes. Where R&G fits the Products or undertakes other services it shall exercise reasonable skill and care and rectify any fault free of charge unless the workmanship has been disturbed. The Buyer is responsible for ensuring that the warranty on the motorcycle is not affected by the fitting of the Products. On return of any defective Products R&G shall at its option either supply a replacement or refund the purchase money but shall not be liable if the Products have been modified or used or maintained otherwise than in accordance with R&G's or manufacturer's instructions and good engineering practice or if the defect arises from accident or neglect. Other than identified above and subject to R&G not limiting its liability for causing death and personal injury, it shall not be liable for indirect or consequential loss and otherwise its liability shall be limited to the amounts paid by the Buyer for the Products or the fitting or service concerned. These terms do not affect the Buyer's statutory rights.

R&G RACING RETURNS POLICY (NON-FAULTY GOODS)

Returns must be pre-authorized (if not pre-authorized the return will be rejected). Goods may only be returned direct to us if they were purchased direct from us (customer must prove if necessary). Otherwise to be returned to original vendor. Goods must be in re-sellable condition, in the opinion of R&G Racing. All returns are subject to a 25% restocking and handling fee (25% of the gross value exc. P&P – at the prevailing price at time of purchase). The customer must pay any and all carriage charges. No returns of discontinued products, unless within 14 days of purchase. This policy does not affect your statutory rights and does not refer to faulty goods.

R&G Racing

Unit 1, Shelley's Lane, East Worldham, Alton, Hampshire, GU34 3AQ

Tel: +44 (0)1420 89007 Fax: +44 (0)1420 87301 www.rg-racing.com Email: info@rg-racing.com



LP0245

**NOTICE DE MONTAGE LP0245BK SUPPORT DE PLAQUE
KAWASAKI NINJA 400 2018 (POUR CLIGNOTANTS STANDARD ET MINI
CLIGNOTANTS R&G (8mm))**

Page | 9



Le kit contient les articles exposés ci-dessous, vérifier que toutes les pièces soient présentes avant de procéder au montage.

La façon dont le kit est emballé ne correspond pas forcément à la façon de monter les pièces sur la moto.

LES PARTIES PRESENTEES PEUVENT ETRE UNIQUEMENT REPRESENTATIVES (POUR LA CLARTE DES INSTRUCTIONS UNIQUEMENT)

Notice disponible au téléchargement sur www.rg-racing.com

VALEURS DE SERRAGE

- M4 BOULON = 8 Nm
- M5 BOULON = 12Nm
- M6 BOULON = 15Nm
- M8 BOULON = 20 Nm
- M10 BOULON = 40Nm

Notez que si les kits sont emballés avec des rondelles en caoutchouc servant à tenir les composants, *ces rondelles doivent être jetées !*

OUTILS REQUIS

- Clés Allen 3, 4 et 5mm
- Clé à cliquet + douilles 8, 12 et 13mm
- Tournevis cruciforme.
- Pincés électriques.
- Un peu de superglue.

R&G Racing

Unit 1, Shelley's Lane, East Worldham, Alton, Hampshire, GU34 3AQ
Tel: +44 (0)1420 89007 Fax: +44 (0)1420 87301 www.rg-racing.com Email: info@rg-racing.com



LP0245

Page | 10

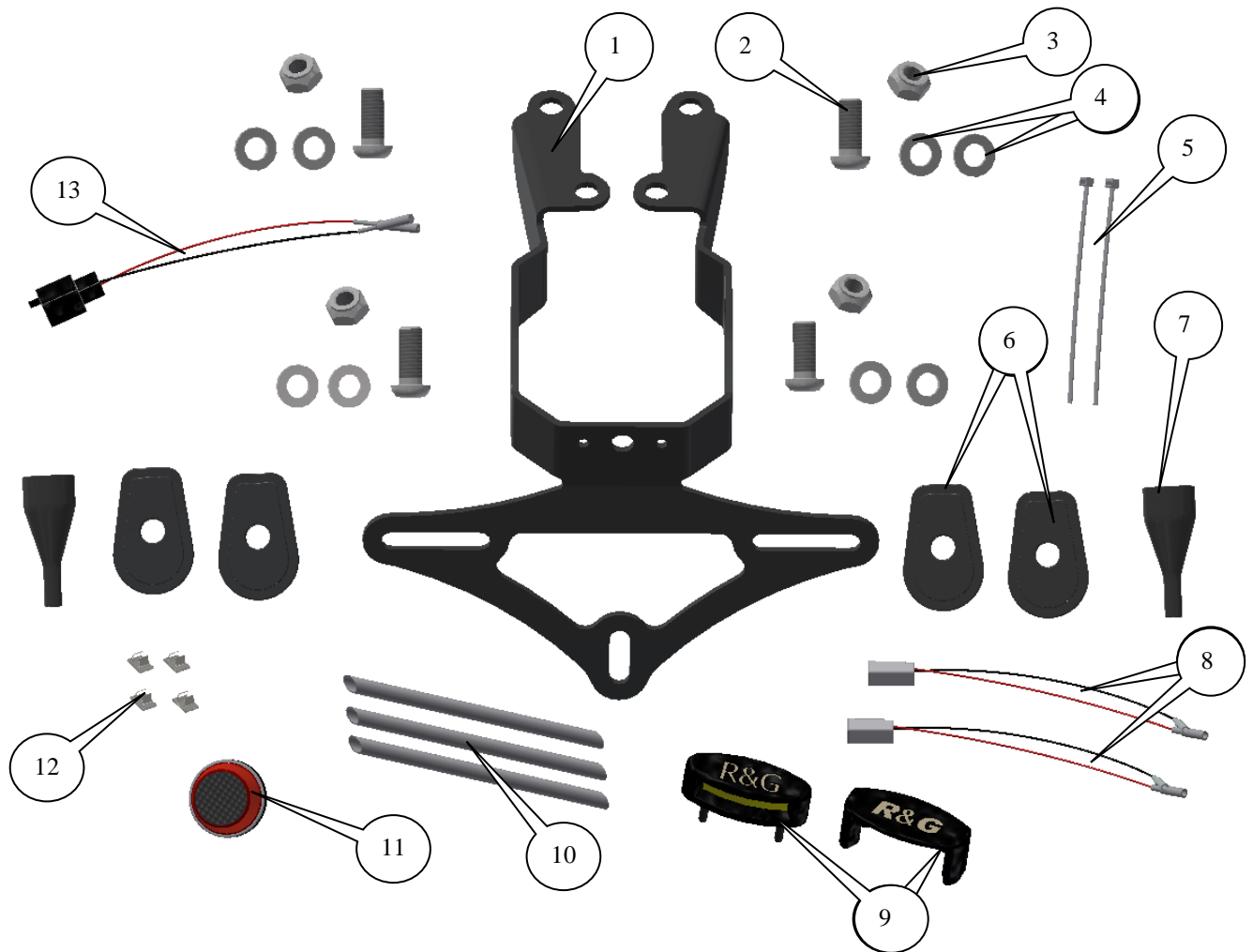

LÉGENDE

ARTICLE 1 = SUPPORT DE PLAQUE (TB0245) (x1).

ARTICLE 2 = M8 x 25mm BOULONS (x4).

ARTICLE 3 = M8 ÉCROUS (x4).

ARTICLE 4 = M8 RONDELLE (x8).

ARTICLE 5 = COLLIERS DE SERRAGE (x2).

ARTICLE 6 = ADAPTATEURS DE MINI CLIGNOTANTS (I0039) (x4).

ARTICLE 7 = CACHES ÉCROU DE CLIGNOTANT EN SILICONE (IWC0002) (x2).

ARTICLE 8 = CONNECTEURS DE MINI CLIGNOTANTS (CON0032) (x2).

R&G Racing

Unit 1, Shelley's Lane, East Worldham, Alton, Hampshire, GU34 3AQ

Tel: +44 (0)1420 89007 Fax: +44 (0)1420 87301 www.rg-racing.com Email: info@rg-racing.com



LP0245

- ARTICLE 9 = ASSEMBLAGE FEU DE PLAQUE (LA0002) (x1).
ARTICLE 10 = 200mm LONGUEUR DE MANCHON THERMO RÉTRACTABLE (x3).
ARTICLE 11 = REFLECTEUR (REFL 1) (x1).
ARTICLE 12 = CLIPS CABLE (x4).
ARTICLE 13 = CONNECTEUR FEU DE PLAQUE (CON0007) (x1).

Page | 11

NOTICE DE MONTAGE

- Pour monter le support de plaque R&G, commencez par enlever le siège à l'aide de la clé, voir photo 1.
- Enlever les 2 clips 'R' indiqués sur la photo 2 puis enlever les 2 pins indiqués sur la photo 3.
- Enlever cache sous plateau, voir photo 4.
- Glisser le cache prise en caoutchouc sur le faisceau de câbles pour donner l'accès au clignotant et au feu de plaque, voir photo 5.
- Déconnecter les 3 prises, voir photo 6 (Clignotants et feu de plaque).
- Enlever les 4 boulons, voir photo 7, tout en supportant le support de plaque d'origine par le dessous.
- Abaisser le support de plaque d'origine tout en passant le fil dans le trou du sous plateau.

Si vous réutilisez les clignotants d'origine

- Enlever la vis, voir photo 8.
- Enlever le support de clignotants, voir photo 9.
- Enlever la plaque d'écartement du clignotant, voir photo 10.
- Tordre légèrement la tige de clignotants puis enlever le clignotant
- Répéter les étapes supérieures pour enlever le clignotant opposé.
- Monter les clignotants sur le nouveau support de plaque (article 1) puis serrer, voir photos 11,12,13, et 14.

Si vous réutilisez les mini clignotants

- Pour monter les mini clignotants R&G (mini clignotant R&G code produit RG370 pour type ampoule et RG371 pour type LED ou RG372 pour LED latérales).
- Positionner les 2 adaptateurs de clignotant (article 6 –I0039) sur le fil de chaque clignotant, en veillant à ce que les côtés qui se font face possèdent le profil central, avant d'insérer l'écrou fourni, voir photos 15 et 16.
- Passer le fil de clignotants dans le cache Écrou/fil (article 7), voir photos 16 et 17 (cela aide d'utiliser un peu de liquide détergent si besoin) et positionner le cache écrou sur l'écrou.
- Appliquer une longueur de manchon thermo rétractable (article 10) sur les fils de chaque clignotant.
- Monter le feu de plaque R&G (article 9), voir photos 18 et 19, notez que vous devrez monter le linceul de feu puis utiliser un peu d'adhésif pour fixer la position. Appliquer une longueur de manchon thermo rétractable (article 10) sur

R&G Racing

Unit 1, Shelley's Lane, East Worldham, Alton, Hampshire, GU34 3AQ
Tel: +44 (0)1420 89007 Fax: +44 (0)1420 87301 www.rg-racing.com Email: info@rg-racing.com



LP0245

Page | 12

le fil. Il est judicieux de reconnecter le faisceau de câbles en utilisant le connecteur fourni (article 13) pour vérifier le fonctionnement (SI l'éclairage échoue, tournez les connecteurs).

- Serrer le fil au support de plaque, en utilisant les clips fournis et colliers de serrage (articles 5 et 12).
- Monter le nouveau support de plaque en position tout en passant le fil dans le trou du sous plateau, voir photos 20 et 21.
- Insérer les 4 boulons avec rondelles (articles 2 et 4) dans les 4 trous du nouveau support de plaque, voir photo 22.
- Fixer à l'aide des 4 écrous avec rondelles (articles 3 et 4), voir photo 23, veiller à ce que les fils ne soient pas coincés.
- Router le fil comme à l'origine et reconnecter le feu de plaque et les clignotants aux prises d'origine.
- Si vous utilisez les mini clignotants à LED, vous devrez utiliser une résistance sur chaque clignotant (Code produit R&G RGR0001) pour obtenir le bon niveau d'éclairage. Il est judicieux de connecter les clignotants au faisceau principal en utilisant les connecteurs fournis (article 8) à ce stade, si l'éclairage échoue, tournez les connecteurs.
- Si vous utilisez les mini clignotants à ampoule, il est judicieux de connecter les clignotants au faisceau principal en utilisant les connecteurs fournis (article 8) à ce stade, si l'éclairage échoue, tournez les connecteurs.
- Remonter le cache sous plateau comme à l'origine (voir photo 24).
- Réinstaller le siège et la plaque (peut nécessiter un perçage).
- **IMPORTANT : Si vous installez une grosse plaque, il y a un risque que la plaque entre en contact avec la roue arrière en cas de choc sur la route (bosse, grosse charge etc..). Il est de votre responsabilité de vérifier que cela ne puisse pas se produire. Ne pas effectuer ces vérifications peut entraîner des dommages ainsi que des blessures graves pour le pilote.**
- Selon les lois locales, attacher le réflecteur rouge (article 11) à l'endroit approprié.
- **Tester le feu de plaque, les clignotants, ainsi que l'ensemble des feux avant de prendre la route.**

ISSUE 1 19/04/2018 (NSY)

CONSUMER NOTICE

The catalogue description and any exhibition of samples are only broad indications of the Products and R&G may make design changes which do not diminish their performance or visual appeal and supplying them in such state shall conform to the order. The Buyer acknowledges no representation or warranty (other than as to title) has been given or will apply to the Products other than those in R&G's order or confirmation and the Buyer confirms it has chosen the Products as being of merchantable quality and suitable for its particular purposes. Where R&G fits the Products or undertakes other services it shall exercise reasonable skill and care and rectify any fault free of charge unless the workmanship has been disturbed. The Buyer is responsible for ensuring that the warranty on the motorcycle is not affected by the fitting of the Products. On return of any defective Products R&G shall at its option either supply a replacement or refund the purchase money but shall not be liable if the Products have

R&G Racing

Unit 1, Shelley's Lane, East Worldham, Alton, Hampshire, GU34 3AQ

Tel: +44 (0)1420 89007 Fax: +44 (0)1420 87301 www.rg-racing.com Email: info@rg-racing.com



LP0245

been modified or used or maintained otherwise than in accordance with R&G's or manufacturer's instructions and good engineering practice or if the defect arises from accident or neglect. Other than identified above and subject to R&G not limiting its liability for causing death and personal injury, it shall not be liable for indirect or consequential loss and otherwise its liability shall be limited to the amounts paid by the Buyer for the Products or the fitting or service concerned. These terms do not affect the Buyer's statutory rights.

Page | 13

R&G RACING RETURNS POLICY (NON-FAULTY GOODS)

Returns must be pre-authorized (if not pre-authorized the return will be rejected). Goods may only be returned direct to us if they were purchased direct from us (customer must prove if necessary). Otherwise to be returned to original vendor. Goods must be in re-sellable condition, in the opinion of R&G Racing. All returns are subject to a 25% restocking and handling fee (25% of the gross value exc. P&P – at the prevailing price at time of purchase). The customer must pay any and all carriage charges. No returns of discontinued products, unless within 14 days of purchase. This policy does not affect your statutory rights and does not refer to faulty goods.

R&G Racing

Unit 1, Shelley's Lane, East Worldham, Alton, Hampshire, GU34 3AQ

Tel: +44 (0)1420 89007 Fax: +44 (0)1420 87301 www.rg-racing.com Email: info@rg-racing.com



LP0245

**MONTAGEANLEITUNG FÜR LP0245BK KENNZEICHENHALTER
KAWASAKI NINJA 400 2018 (VERWENDUNG MIT STANDARDBLINKER
UND R&G MINIBLINKER (8mm))**

Page | 14



**ALLE GELIEFERTEN TEILE SIND UNTEN ABGEBILDET UND GEKENNZEICHNET.
BEVOR SIE MIT DER MONTAGE BEGINNEN, ÜBERPRÜFEN SIE SORGFÄLTIG, DASS
ALLE TEILE VORHANDEN SIND.**

Die Verpackung der Teile stellt nicht die Reihenfolge der Montage dar.

DIE UNTEN ABGEBILDETEN TEILE DIENEN LEDIGLICH ZUR ERKLÄRUNG

**Eine digitale Version dieser Montageanleitung kann auf folgender Seite heruntergeladen werden:
www.rg-racing.com**

ANZUGSDREHMOMENTE:

M4 SCHRAUBE = 8 NM

M5 SCHRAUBE = 12NM

M6 SCHRAUBE = 15NM

M8 SCHRAUBE = 20NM

M10 SCHRAUBE = 40NM

*Hinweis für Kits mit Plastikunterlegscheiben an den Schrauben – Diese
Plastikunterlegscheiben werden nicht für den Einbau benötigt!*

R&G Racing
Unit 1, Shelley's Lane, East Worldham, Alton, Hampshire, GU34 3AQ
Tel: +44 (0)1420 89007 Fax: +44 (0)1420 87301 www.rg-racing.com Email: info@rg-racing.com



LP0245

SIE BENÖTIGEN FOLGENDES WERKZEUG

- Satz Inbusschlüssel inkl. 3, 4 & 5mm Inbusschlüssel
- Steckschlüsselsatz inkl. 8, 12 and 13mm Steckschlüssel
 - Kreuzschlitzschraubendreher
 - Elektroniker Zange
 - etwas Sekundenkleber

Page | 15

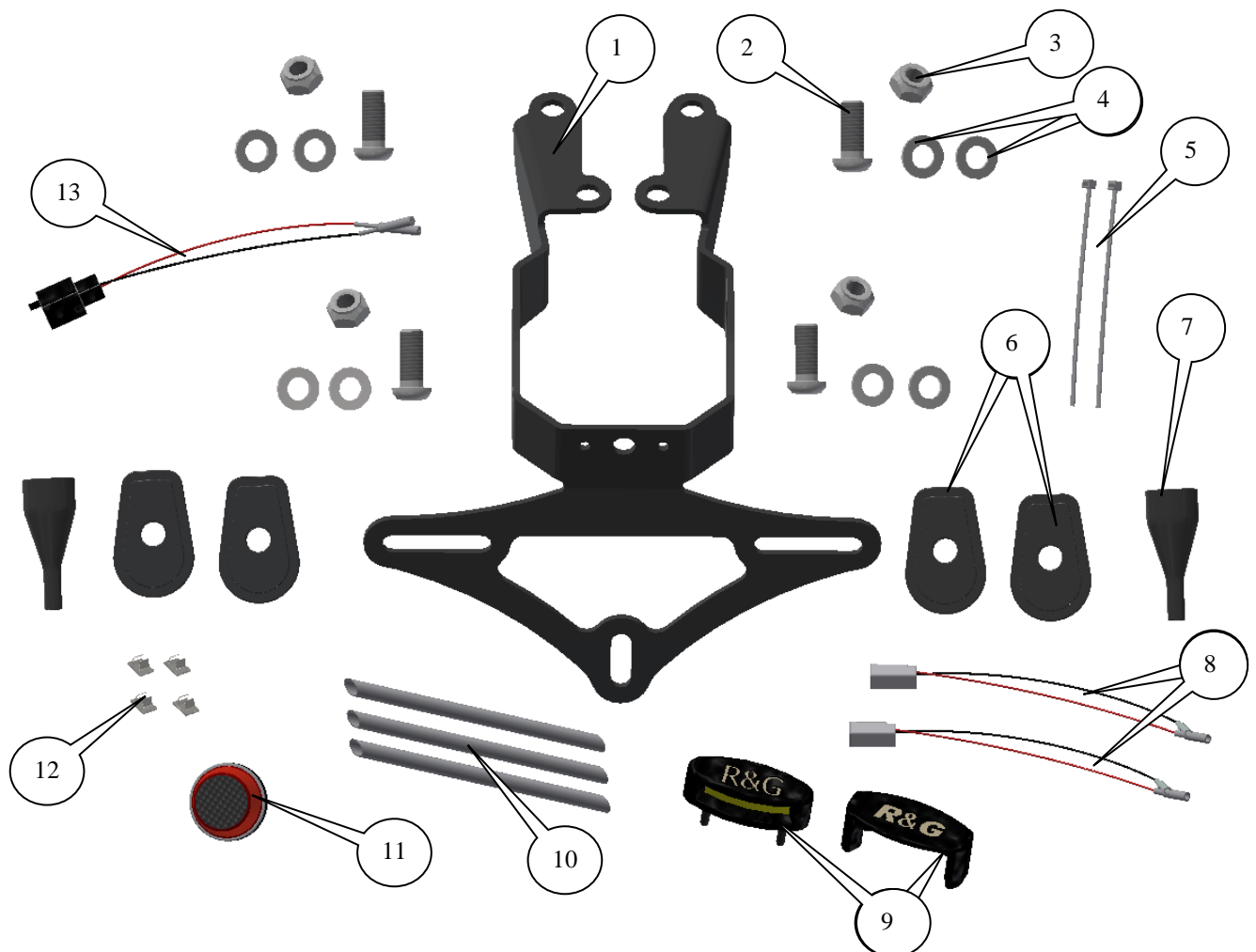

LIEFERUMFANG

- ARTIKEL 1 = KENNZEICHENHALTER (TB0245) (x1)
- ARTIKEL 2 = M8 x 25mm INBUSSCHRAUBEN (x4)
- ARTIKEL 3 = M8 SELBSTSICHERNDE MUTTER (x4)
- ARTIKEL 4 = M8 UNTERLEGSCHIEBEN (x8)

R&G Racing
Unit 1, Shelley's Lane, East Worldham, Alton, Hampshire, GU34 3AQ
Tel: +44 (0)1420 89007 Fax: +44 (0)1420 87301 www.rg-racing.com Email: info@rg-racing.com



LP0245

Page | 16

- ARTIKEL 5 = KABELBINDER (x2)
- ARTIKEL 6 = BLINKER ADAPTER AUS SILIKON (I0039) (x4)
- ARTIKEL 7 = ABDECKUNGEN FÜR DIE MUTTER (BLINKER) AUS SILIKON (IWC0002) (x2)
- ARTIKEL 8 = VERBINDUNGEN FÜR DIE MINIBLINKER (CON0032) (x2)
- ARTIKEL 9 = KENNZEICHENBELEUCHTUNG (LA0002) (x1)
- ARTIKEL 10 = 200mm SCHRUMPFSCHLAUCH (x3)
- ARTIKEL 11 = RÜCKSTRAHLER (REFL 1) (x1)
- ARTIKEL 12 = KABELCLIPS (x4)
- ARTIKEL 13 = VERBINDUNG FÜR DIE KENNZEICHENBELEUCHTUNG (CON0007) (x1)

MONTAGEANLEITUNG:

- Um den R&G Kennzeichenhalter montieren zu können, entfernen Sie zuerst den Sitz. Verwenden Sie hierfür den Schlüssel – siehe Abbildung 1.
- Entfernen Sie die zwei 'R'-Clips, die in Abbildung 2 gekennzeichnet sind, sowie die zwei Pins, die in Abbildung 3 markiert sind.
- Entfernen Sie die untere Sitzabdeckung wie in Abbildung 4 abgebildet.
- Schieben Sie die Abdeckung für die Steckverbinder aus Gummi am Kabelbaum entlang, um Zugang zu den Blinkern und der Kennzeichenbeleuchtung zu ermöglichen– siehe Abbildung 5.
- Trennen Sie die drei Steckverbinder, die in Abbildung 6 mit Pfeilen gekennzeichnet sind (Blinker und Kennzeichenbeleuchtung).
- Entfernen Sie die vier Schrauben, die in Abbildung 7 gekennzeichnet sind – stützen Sie hierbei den Kennzeichenhalter von unten.
- Den Kennzeichenhalter vorsichtig herabsetzen und gleichzeitig die Kabel durch die Öffnung in der unteren Abdeckung führen.

Wenn Sie die original Blinker verwenden

- Entfernen Sie die Schraube, die in Abbildung 8 gekennzeichnet ist.
- Entfernen Sie die Klemmhalterung für den Blinker – siehe Abbildung 9.
- Entfernen Sie die Distanzplatte – siehe Abbildung 10.
- Vorsichtig den Stiel zusammendrücken und den Blinker entfernen.
- Diese Schritte wiederholen, um den zweiten Blinker zu entfernen.
- Montieren Sie die Blinker am neuen Kennzeichenhalter (Artikel 1) und befestigen Sie ihn wie in den Abbildungen 11,12,13, und 14 abgebildet.

Wenn Sie R&G Miniblinker verwenden:

- Die R&G Miniblinker (R&G Artikel-Nr. RG370 = Glühbirne, RG371 = LED, RG372 = Aero LED) montieren Sie wie folgt:
- Positionieren Sie die zwei Blinker-Adapter (Artikel 6 –I0039) an den Kabeln der zwei Blinker. Bitte darauf achten, dass die Flächen mit erhöhter Profilmittte sich gegenüber liegen, bevor Sie die Bundmutter vom Kit montieren – siehe Abbildungen 15 und 16.
- Führen Sie Blinkerkabel durch die Mutter/Kabelabdeckung (Artikel 7) wie in den Abbildungen 16 und 17 abgebildet (etwas Spülmittel kann hierbei helfen) und die Abdeckung für die Mutter an der Mutter anbringen.
- Je eine Länge Schrumpfschlauch (Artikel 10) an den Kabeln für jeden Blinker anbringen.

- Montieren Sie die R&G Kennzeichenbeleuchtung (Artikel 9) wie in den Abbildungen 18 und 19 abgebildet. Bitte beachten Sie, dass die Abdeckung für die Kennzeichenbeleuchtung mit etwas Sekundenkleber in Position befestigt werden muss. 1 x

R&G Racing

Unit 1, Shelley's Lane, East Worldham, Alton, Hampshire, GU34 3AQ

Tel: +44 (0)1420 89007 Fax: +44 (0)1420 87301 www.rg-racing.com Email: info@rg-racing.com



LP0245

Page | 17

Schrumpfschlauch (Artikel 10) am Kabel anbringen. Es empfiehlt sich nun, die Kennzeichenbeleuchtung mittels der mitgelieferten Verbindung (Artikel 13) mit dem Kabelbaum zu verbinden. Falls die Beleuchtung nicht funktionieren sollte, tauschen Sie die Kabelverbinder untereinander.

- Verwenden Sie die mitgelieferten Clips und Kabelbinder (Artikel 5 und 12), um die Kabel für den Kennzeichenhalter ordentlich zu verstauen.
- Den neuen Kennzeichenhalter in Position bringen und die Kabel dabei durch die Öffnung in der unteren Abdeckung führen –siehe Abbildungen 20 und 21.
- Montieren Sie die vier Inbusschrauben mit Unterlegscheiben (Artikel 2 und 4) an den vier Öffnungen im neuen Kennzeichenhalter wie in Abbildung 22 abgebildet.
- Mit den vier Muttern und Unterlegscheiben (Artikel 3 und 4) sichern wie in Abbildung 23 abgebildet – bitte überprüfen Sie, dass die Kabel nicht eingeklemmt sind.
- Verlegen Sie die Kabel wie ursprünglich wieder und verbinden Sie die Kennzeichenbeleuchtung und Blinker mit den original Steckverbindern.
- Wenn Sie LED-Miniblinker verwenden, benötigen Sie je einen Widerstand an jedem Blinker (R&G Artikel: RGR0001), um die richtige Blitzgeschwindigkeit zu bekommen. Es empfiehlt sich, zum jetzigen Zeitpunkt die Blinker mittels der mitgelieferten Verbindungen (Artikel 8) mit dem Kabelbaum zu verbinden. Falls die Beleuchtung nicht funktionieren sollte, tauschen Sie die Kabelverbinder untereinander.
- Wenn Sie Miniblinker mit Glühbirnen verwenden, empfiehlt sich nun, die Blinker mittels der mitgelieferten Verbindungen (Artikel 8) mit dem Kabelbaum zu verbinden. Falls die Beleuchtung nicht funktionieren sollte, tauschen Sie die Kabelverbinder untereinander.
- Montieren Sie die untere Sitzabdeckung wie ursprünglich wieder (siehe Abbildung 24).
- Montieren Sie den Sitz und das amtliche Kennzeichen (Bohrungen im Kennzeichen evtl. notwendig).
- **WICHTIG: WENN EIN GROSSES KENNZEICHEN ZU WEIT NACH UNTEN MONTIERT WIRD, BESTEHT BEI SCHWEREM LAST ODER DURCH GROSSE BODENWELLEN EIN GERINGES RISIKO, DASS DAS KENNZEICHEN AN DAS HINTERRAD STOSSEN KANN. ES LIEGT IN IHRER VERANTWORTUNG DIES ZU ÜBERPRÜFEN UND, WENN NOTWENDIG, VORZUBEUGENDE MASSNAHMEN ZU ERGREIFEN. DIE NICHTBEACHTUNG DIESES SICHERHEITSHINWEIS KANN ZU SCHWEREN VERLETZUNGEN FÜHREN.**
- Entsprechend der gesetzlichen Vorschriften, den mitgelieferten Rückstrahler (Artikel 11) an die dafür vorgesehene Stelle anbringen.
- Überprüfen Sie die Funktion der Beleuchtung (Blinker und Kennzeichenhalterbeleuchtung) vor Gebrauch des Fahrzeuges.

AUSGABE 1 19/04/2018 (NSY)

CONSUMER NOTICE

The catalogue description and any exhibition of samples are only broad indications of the Products and R&G may make design changes which do not diminish their performance or visual appeal and supplying them in such state shall conform to the order. The Buyer acknowledges no representation or warranty (other than as to title) has been given or will apply to the Products other than those in R&G's order or confirmation and the Buyer confirms it has chosen the Products as being of merchantable quality and suitable for its particular purposes. Where R&G fits the Products or undertakes other services it shall exercise reasonable skill and care and rectify any fault free of charge unless the workmanship has been disturbed. The Buyer is responsible for ensuring that the warranty on the motorcycle is not affected by the fitting of the Products. On return of any defective Products R&G shall at its option either supply a replacement or refund the purchase money but shall not be liable if the Products have been modified or used or maintained otherwise than in accordance with R&G's or manufacturer's instructions and good engineering practice or if the defect arises from accident or neglect. Other than identified above and subject to R&G not limiting its liability for causing death and personal injury, it shall not be liable for indirect or consequential loss and otherwise its liability shall be limited to the amounts paid by the Buyer for the Products or the fitting or service concerned. These terms do not affect the Buyer's statutory rights.

R&G RACING RETURNS POLICY (NON-FAULTY GOODS)

Returns must be pre-authorized (if not pre-authorized the return will be rejected). Goods may only be returned direct to us if they were purchased direct from us (customer must prove if necessary). Otherwise to be returned to original vendor. Goods must be in re-sellable condition, in the opinion of R&G Racing. All returns are subject to a 25% restocking and handling fee (25% of the gross value exc. P&P – at the prevailing price at time of purchase). The customer must pay any and all carriage charges. No returns of discontinued products, unless within 14 days of purchase. This policy does not affect your statutory rights and does not refer to faulty goods.

R&G Racing

Unit 1, Shelley's Lane, East Worldham, Alton, Hampshire, GU34 3AQ

Tel: +44 (0)1420 89007 Fax: +44 (0)1420 87301 www.rg-racing.com Email: info@rg-racing.com