



**FITTING INSTRUCTIONS FOR FP0129BK FORK PROTECTORS**  
**KAWASAKI NINJA 250 '08-**



**THIS KIT CONTAINS THE ITEMS PICTURED AND LABELLED BELOW.**  
**DO NOT PROCEED UNTIL YOU ARE SURE ALL PARTS ARE PRESENT.**

**Please note that the way the kit is packed does not necessarily represent the way of mounting to the bike**

Please note that in cases where kits are packed with a plastic tube separating components on the spindle bar (this tube should be discarded).

THE PARTS SHOWN MAY BE REPRESENTATIVE ONLY (FOR CLARITY OF INSTRUCTIONS ONLY)

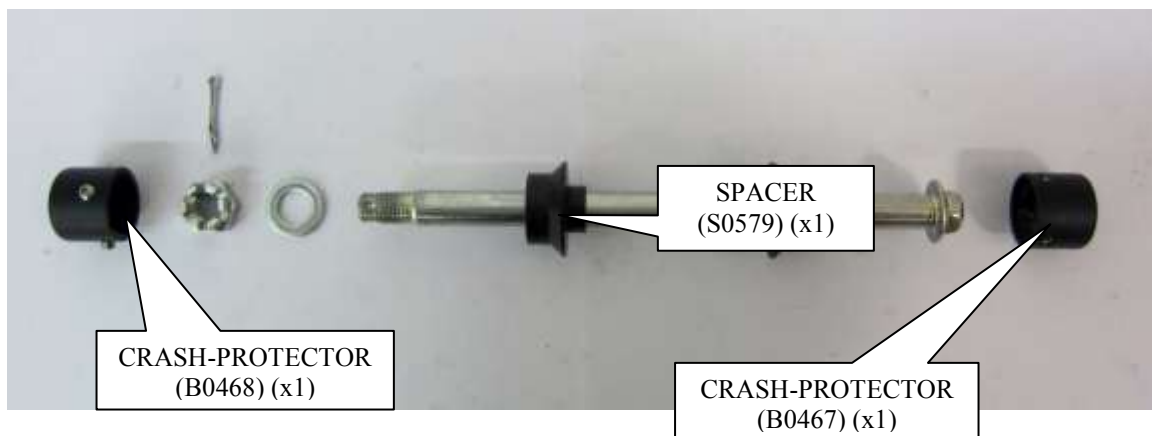



Picture 1



Picture 2

#### **TOOLS REQUIRED**

- Socket set to include 17 & 22mm sockets.
  - 3mm A/F Allen key.
  - Pliers
  - Torque wrench

#### **FITTING INSTRUCTIONS**

- Remove the front wheel. To do this, remove the split pin from the wheel axle nut and undo the nut. With the front of the bike securely supported, remove the axle.
- With the wheel clear of the fork leg, remove the bearing spacer from the right side, as shown in picture 1.
- Fit the spacer (S0579) into the bearing seal (smaller diameter first), as shown in picture 2.
- Re-position the wheel in line with the fork leg (ensuring the disc fits between the pads) and re-insert the original front axle.
- Fit the original washer, nut and split pin, ensuring to tighten the nut to the manufacturers recommended torque.
- Now fit one crash protector (B0468) (this can be identified by having the larger hexagon machined internally) over the nut, making sure the hexagon edge with a groove sits over the split pin head, and tighten the three grub screws equally onto the nut surface.
- On the left side of the bike, fit the remaining bobbin (B0467) over the bolt head and tighten the grub screws equally.
- Ensure all grub screws are tightened equally and the bobbins are secure and fitting flush against the fork leg.

ISSUE 1 21/11/2012 (AR)

#### **CONSUMER NOTICE**

The catalogue description and any exhibition of samples are only broad indications of the Products and R&G may make design changes which do not diminish their performance or visual appeal and supplying them in such state shall conform to the order. The Buyer acknowledges no representation or warranty (other than as to title) has been given or will apply to the Products other than those in R&G's order or confirmation and the Buyer confirms it has chosen the Products as being of merchantable quality and suitable for its particular purposes. Where R&G fits the Products or undertakes other services it shall exercise reasonable skill and care and rectify any fault free of charge unless the workmanship has been disturbed. The Buyer is responsible for ensuring that the warranty on the motorcycle is not affected by the fitting of the Products. On return of any defective Products R&G shall at its option either supply a replacement or refund the purchase money but shall not be liable if the Products have been modified or used or maintained otherwise than in accordance with R&G's or manufacturer's instructions and good engineering practice or if the defect arises from accident or neglect. Other than identified above and subject to R&G not limiting its liability for causing death and personal injury, it shall not be

R&G Racing

Unit 1, Shelley's Lane, East Worldham, Alton, Hampshire, GU34 3AQ

Tel: +44 (0)1420 89007 Fax: +44 (0)1420 87301 [www.rg-racing.com](http://www.rg-racing.com) Email: [info@rg-racing.com](mailto:info@rg-racing.com)



liable for indirect or consequential loss and otherwise its liability shall be limited to the amounts paid by the Buyer for the Products or the fitting or service concerned. These terms do not affect the Buyer's statutory rights.

**R&G RACING RETURNS POLICY (NON-FAULTY GOODS)**

Returns must be pre-authorized (if not pre-authorized the return will be rejected). Goods may only be returned direct to us if they were purchased direct from us (customer must prove if necessary). Otherwise to be returned to original vendor. Goods must be in resellable condition, in the opinion of R&G Racing. All returns are subject to a 25% restocking and handling fee (25% of the gross value exc. P&P – at the prevailing price at time of purchase). The customer must pay any and all carriage charges. No returns of discontinued products, unless within 14 days of purchase. This policy does not affect your statutory rights and does not refer to faulty goods.



**Instructions de montage pour FP0129BK Protections fourche**  
**KAWASAKI NINJA 250 '08-**



**LE KIT CONTIENT LES ARTICLES EXPOSES CI-DESSOUS, VERIFIER QUE TOUTES LES PIECES SOIENT PRESENTES AVANT DE PROCEDER AU MONTAGE.**

**LA FAÇON DONT LE KIT EST EMBALLE NE CORRESPOND PAS FORCEMENT A LA FAÇON DE MONTER LES PIECES SUR LA MOTO.**

Notez que si les kits sont emballés avec un tube en plastique séparant les composants de l'axe, *ce tube doit être jeté.*

Les pièces présentées peuvent n'être que représentatives, afin de faciliter et clarifier les instructions de montage.

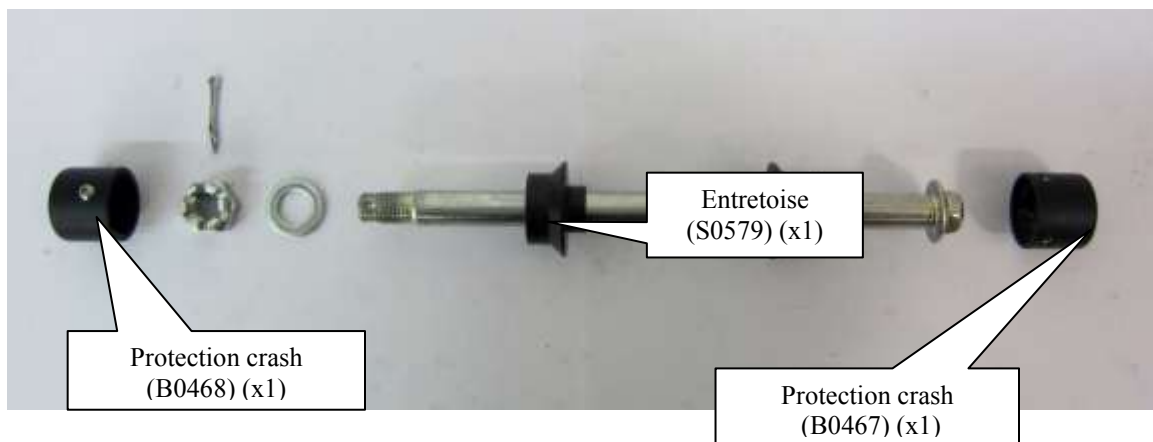



Photo 1



Photo2

- **Outils requis**
- Clés 17 & 22mm
- Clé Allen 3mm.
  - Pincés
- Clé dynamométrique

**Instructions de montage:**

- Enlever la roue avant. Pour cela, enlever the split pin de l'axe d'écrou et enlever l'écrou. Une fois l'avant de la moto bien supporté, de façon sûre, retire l'axe.
  - Une fois la roue détachée du pied de fourche, enlever l'entretoise du coté droit (Photo 1).
  - Passer l'entretoise (S0579) dans le joint d'étanchéité (le plus petit diamètre d'abord), (Photo 2).
  - Remettre la roue bien centre avec la fourche (en vous assurant que le disque passe bien dans la fente) puis remettre l'axe d'origine.
  - Mettre la rondelle, écrou et goupille, en vous assurant de bien fixer l'écrou aux couples de serrage recommandés.
  - Installer une protection crash (B0468) (elle peut être identifiée par le grand hexagone usiné intérieurement) autour de l'écrou, en étant sûr que le bord hexagonal avec une rainure aille autour de la tête de la goupille, et serrer les 3 vis sans tête de façon égale sur la surface d'écrou.
  - Du coté gauche de la moto, installer la bobine restante (B0467) autour de la tête du boulon et fixer les vis de façon égale.
- Assurez vous que les vis soient bien serrées de façon égale et que les bobines soient fixées et contre le pied de fourche.

ISSUE 1 21/11/2012 (AR)

**CONSUMER NOTICE**

The catalogue description and any exhibition of samples are only broad indications of the Products and R&G may make design changes which do not diminish their performance or visual appeal and supplying them in such state shall conform to the order. The Buyer acknowledges no representation or warranty (other than as to title) has been given or will apply to the Products other than those in R&G's order or confirmation and the Buyer confirms it has chosen the Products as being of merchantable quality and suitable for its particular purposes. Where R&G fits the Products or undertakes other services it shall exercise reasonable skill and care and rectify any fault free of charge unless the workmanship has been disturbed. The Buyer is responsible for ensuring that the warranty on the motorcycle is not affected by the fitting of the Products. On return of any defective Products R&G shall at its option either supply a replacement or refund the purchase money but shall not be liable if the Products have been modified or used or maintained otherwise than in accordance with R&G's or manufacturer's instructions and good engineering practice or if the defect arises from accident or

R&G Racing

Unit 1, Shelley's Lane, East Worldham, Alton, Hampshire, GU34 3AQ

Tel: +44 (0)1420 89007 Fax: +44 (0)1420 87301 [www.rg-racing.com](http://www.rg-racing.com) Email: [info@rg-racing.com](mailto:info@rg-racing.com)



neglect. Other than identified above and subject to R&G not limiting its liability for causing death and personal injury, it shall not be liable for indirect or consequential loss and otherwise its liability shall be limited to the amounts paid by the Buyer for the Products or the fitting or service concerned. These terms do not affect the Buyer's statutory rights.

**R&G RACING RETURNS POLICY (NON-FAULTY GOODS)**

Returns must be pre-authorized (if not pre-authorized the return will be rejected). Goods may only be returned direct to us if they were purchased direct from us (customer must prove if necessary). Otherwise to be returned to original vendor. Goods must be in resellable condition, in the opinion of R&G Racing. All returns are subject to a 25% restocking and handling fee (25% of the gross value exc. P&P – at the prevailing price at time of purchase). The customer must pay any and all carriage charges. No returns of discontinued products, unless within 14 days of purchase. This policy does not affect your statutory rights and does not refer to faulty goods.