



FITTING INSTRUCTIONS FOR SS0031 SPINDLE SLIDERS



THIS KIT CONTAINS THE ITEMS PICTURED AND LABELLED BELOW.
DO NOT PROCEED UNTIL YOU ARE SURE ALL PARTS ARE PRESENT.

Please note that the way the kit is packed does not necessarily represent the way of mounting to the bike.

THE PARTS SHOWN MAY BE REPRESENTATIVE ONLY (FOR CLARITY OF INSTRUCTIONS ONLY)

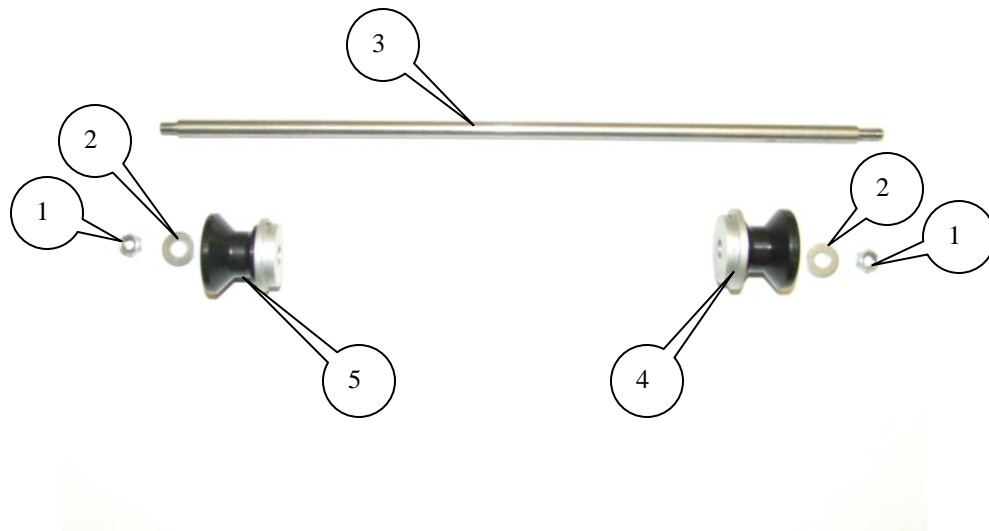



LEGEND

- ITEM 1 = M6 NYLOC NUTS (x2).
ITEM 2 = M6 WASHERS (16mm OUTSIDE DIAMETER) (x2).
ITEM 3 = SPINDLE BAR (SB0065 330mm LONG) (x1)
ITEM 4 = PADDOCK STAND BOBBINS L-H-S (B0301 WITH CS315) (x1).
ITEM 5 = PADDOCK STAND BOBBINS L-H-S (B0301 WITH CS410) (x1).
ITEM 6 = SPINDLE BAR (SB0024) (x1)

Please note that in cases where kits are packed with rubber washers holding the components onto the bolt – *the rubber washers should be thrown away!*

TOOLS REQUIRED

- TWO 10mm A/F SOCKETS AND WRENCHES.

FITTING INSTRUCTIONS

- PLACE PADDOCK STAND BOBBIN WITH SMALLER LOCATION SPIGOT (S0301 WITH CS315, ITEM 5) INTO LEFT-HAND FRONT SPINDLE.
- PLACE PADDOCK STAND BOBBIN WITH LARGER LOCATION SPIGOT (S0301 WITH CS410, ITEM 4) INTO RIGHT-HAND FRONT SPINDLE.
- FEED SPINDLE-BAR (SB065, ITEM 3) THROUGH PADDOCK STAND BOBBINS IN FRONT SPINDLE.
- FIT WASHERS AND NYLOC NUTS ONTO EITHER END OF SPINDLE BAR.
- TIGHTEN UNTIL BOTH NUTS ARE ENGAGED IN NYLON AND EQUAL AMOUNTS PROTRUDE FROM EITHER SIDE. DO NOT OVER-TIGHTEN—THE NYLOC NUTS WILL HOLD IT TIGHT.

CONSUMER NOTICE

The catalogue description and any exhibition of samples are only broad indications of the Products and R&G may make design changes which do not diminish their performance or visual appeal and supplying them in such state shall conform to the order. The Buyer acknowledges no representation or warranty (other than as to title) has been given or will apply to the Products other than those in R&G's order or confirmation and the Buyer confirms it has chosen the Products as being of merchantable quality and suitable for its particular purposes. Where R&G fits the Products or undertakes other services it shall exercise reasonable skill and care and rectify any fault free of charge unless the workmanship has been disturbed. The Buyer is responsible for ensuring that the warranty on the motorcycle is not affected by the fitting of the Products. On return of any defective Products R&G shall at its option either supply a replacement or refund the purchase money but shall not be liable if the Products have been modified or used or maintained otherwise than in accordance with R&G's or manufacturer's instructions and good engineering practice or if the defect arises from accident or neglect. Other than identified above and subject to R&G not limiting its liability for causing death and personal injury, it shall not be liable for indirect or consequential loss and otherwise its liability shall be limited to the amounts paid by the Buyer for the Products or the fitting or service concerned. These terms do not affect the Buyer's statutory rights.

R&G RACING RETURNS POLICY (NON-FAULTY GOODS)

Returns must be pre-authorised (if not pre-authorised the return will be rejected). Goods may only be returned direct to us if they were purchased direct from us (customer must prove if necessary). Otherwise to be returned to original vendor. Goods must be in re-sellable condition, in the opinion of R&G Racing. All returns are subject to a 25% restocking and handling fee (25% of the gross value exc. P&P – at the prevailing price at time of purchase). The customer must pay any and all carriage charges. No returns of discontinued products, unless within 14 days of purchase. This policy does not affect your statutory rights and does not refer to faulty goods.

R&G Racing

Unit 1, Shelley's Lane, East Worldham, Alton, Hampshire, GU34 3AQ

Tel: +44 (0)1420 89007 Fax: +44 (0)1420 87301 www.rg-racing.com Email: info@rg-racing.com



INSTRUCTIONS DE MONTAGE
SS0031
TRIUMPH SPRINT GT 2010-

Merci de noter que les pièces assemblées dans l'emballage ne sont pas nécessairement dans le sens du montage à réaliser sur la moto.

LEGENDE

ARTICLE 1 = Ecrou M6 (x2).

ARTICLE 2 = Rondelles M6 (dia ext 16mm) (x2).

ARTICLE 3 = Barre Inox (SB0065 330mm LONG) (x1)

ARTICLE 4 = Tampons R&G L-H-S (B0301 avec CS315) (x1).

ARTICLE 5 = Tampons R&G L-H-S (B0301 avec CS410) (x1).

OUTILS NECESSAIRES

- 2 clés 10mm à pipe.

INSTRUCTIONS

- Placer le tampon ayant la partie en aluminium le plus petit dans l'axe de roue côté Gauche (article N 5).
- Placer le tampon ayant la partie en aluminium le plus grande dans l'axe de roue côté Droit (article N 4).
- Insérer l'axe R&G à travers l'axe de roue arrière à travers les deux tampons.(Arti. N 3)
- Placer une rondelle et un écrou de chaque côté de l'axe.
- Serrer les deux écrous simultanément à l'aide des deux vis. Ne pas serrer trop fortement, en effet les écrous autobloquants vont garder le montage en place.



R&G Racing
Unit 1, Shelley's Lane, East Worldham, Alton, Hampshire, GU34 3AQ
Tel: +44 (0)1420 89007 Fax: +44 (0)1420 87301 www.rg-racing.com Email: info@rg-racing.com