

812001 Yamaha Tracer 900 Shock Shield Fitting Instructions

Kit includes:

1X	Rubber Moulding	CBOLM60007
1X	Galvanised Bracket	CBOLM60010
3X	M5 x 12mm Button Head Bolt	CGROM60001
3X	M5 Nyloc Nuts	CSPAM60004
3X	M5 Washers	CWASM60003
2X	M8 Acorn Nuts	CGROM60002

If your Tracer 900 is fitted with the Yamaha Panniers, please see product SKU: 812000

This shock shield is designed for use on a bike without the Yamaha panniers fitted.

- The Pyramid Shock Shield is simple to fit. Assemble the rubber moulding to the galvanised bracket using the M5 x 12mm button head bolts, M5 washers & M5 nyloc nuts.
- The M8 acorn nuts are used to attach the galvanised bracket to underside of the bike. The bracket attaches using the back of the rear footpeg mounting bolt on each side. Please use images below as a guide.



Rear footpeg mounting bolts

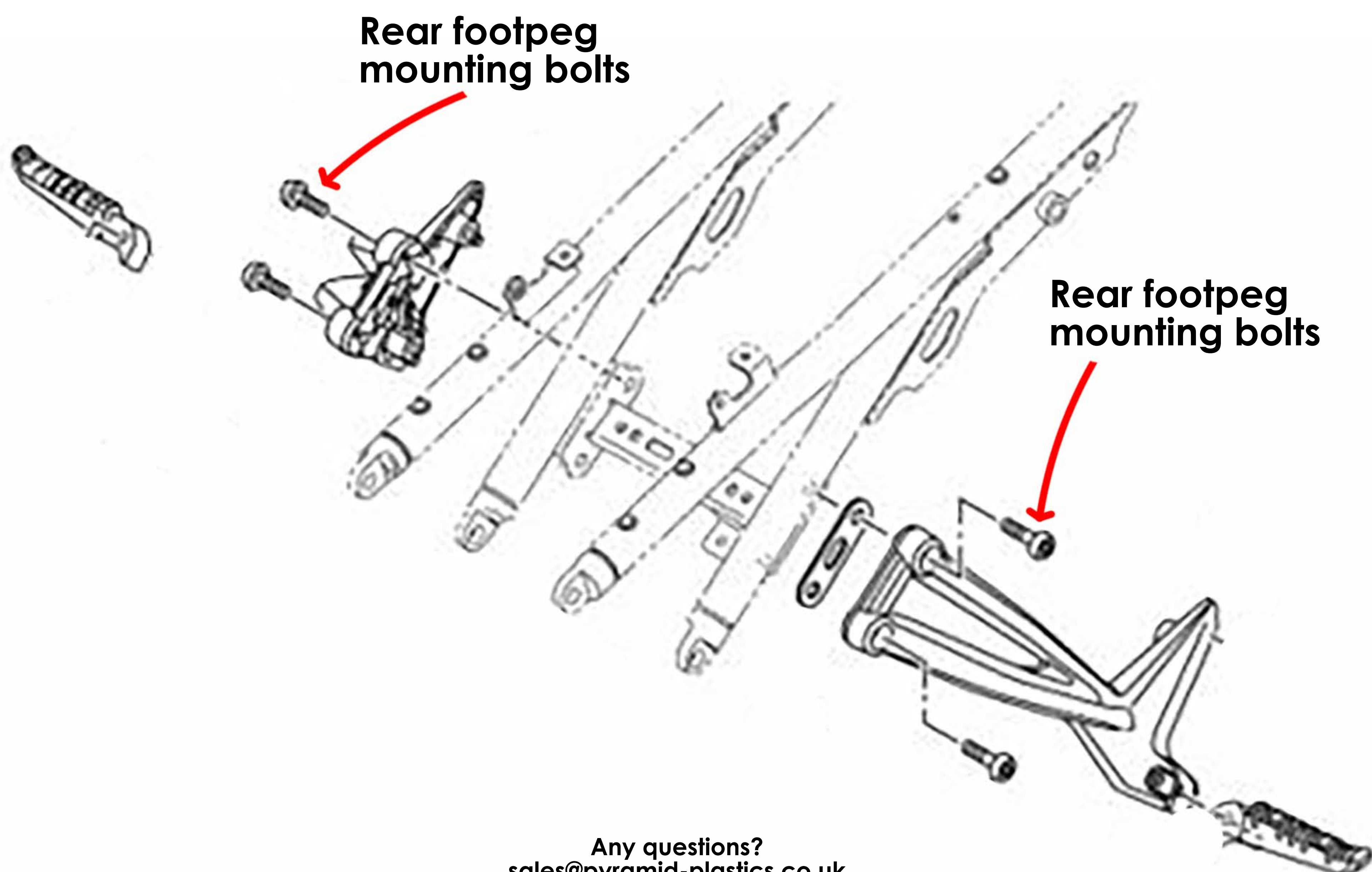

Rear footpeg mounting bolts

Rear footpeg mounting bolts

Any questions?
sales@pyramid-plastics.co.uk
 01427 677990
www.pyramid-plastics.co.uk

Follow us on social media and feel free to leave us a review!

