

814130 BMW R1300R/RS Shock Shield Fitting Instructions

Kit Includes:

| | | | |
|----|----|------------|----------------------------------|
| 1. | X1 | C08061 | Rubber Mudflap |
| 2. | X1 | C814130 | Shock Shield |
| 3. | X2 | CRIV0005 | Rivet |
| 4. | X1 | CTAP0052 | Adhesive Pads |
| 5. | X3 | CBOLM60007 | M6 x 12mm SS Flanged Button Bolt |
| 6. | X3 | CNUTM60002 | M6 SS Serrated Nut |
| 7. | X3 | CCAPM60002 | M6 Plastic Bolt Cap |

Please read these instructions before assembling

Clean the undertray with warm soapy water before fitment - dry thoroughly

Assembly Instructions

- Attach the adhesive pads to the shock shield as shown in **Fig. 1**.
- Secure the rubber mudflap to the shock shield using the M6 fixings shown in **Fig. 2**. Fully tighten all three mounting points.
- Remove the two OEM rivets from the motorcycle undertray (see **Fig. 3** for rivet locations).
- Before removing the backing film from the adhesive pads, position the assembly against the undertray to check alignment.
- Once satisfied with the alignment, remove the backing film and carefully position the shock shield assembly onto the undertray. Ensure the mounting holes in the shock shield align with those in the undertray during installation.
- Apply firm, even pressure across all adhesive pads. Place a flat, rigid pressing surface (such as a block of wood or similar) between the shock shield and tyre to maintain consistent pressure while the adhesive cures (leave in place for few hours).
- Finally, insert the rivets through the mounting points (see **Fig. 2 + 3**). Using the handle end of a small screwdriver can help fully seat the rivets.

Fig 1

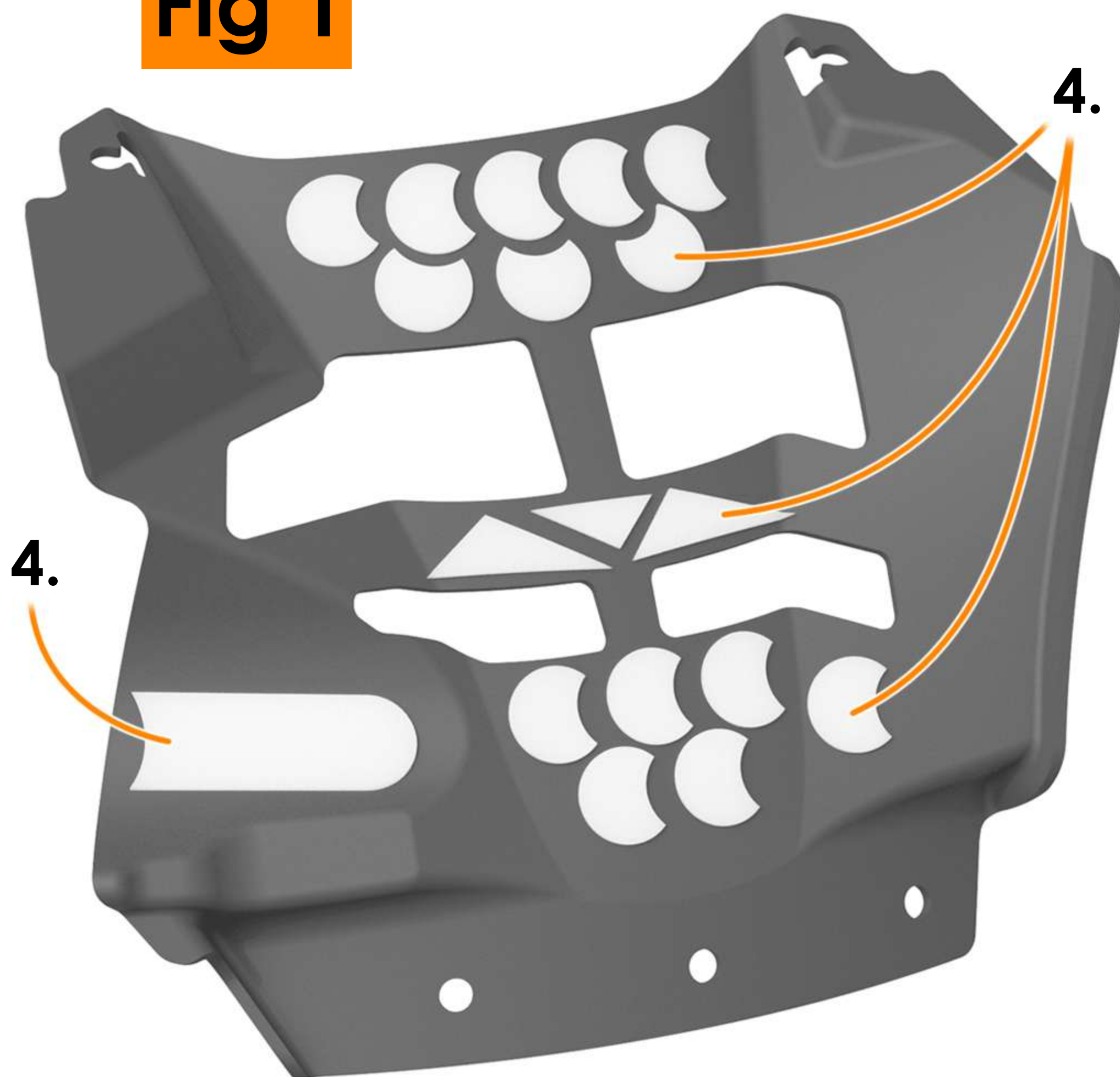

Fig 2

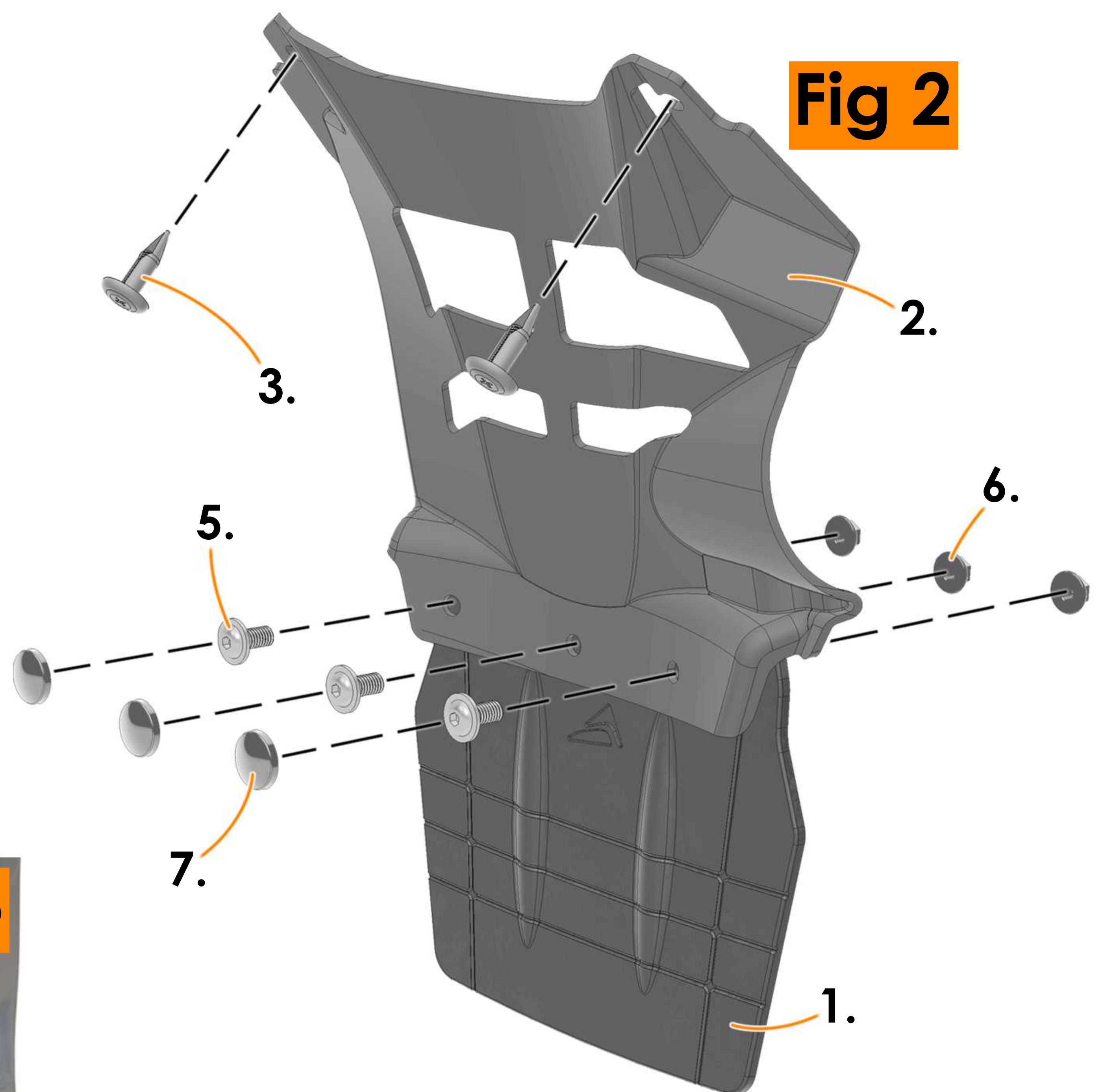
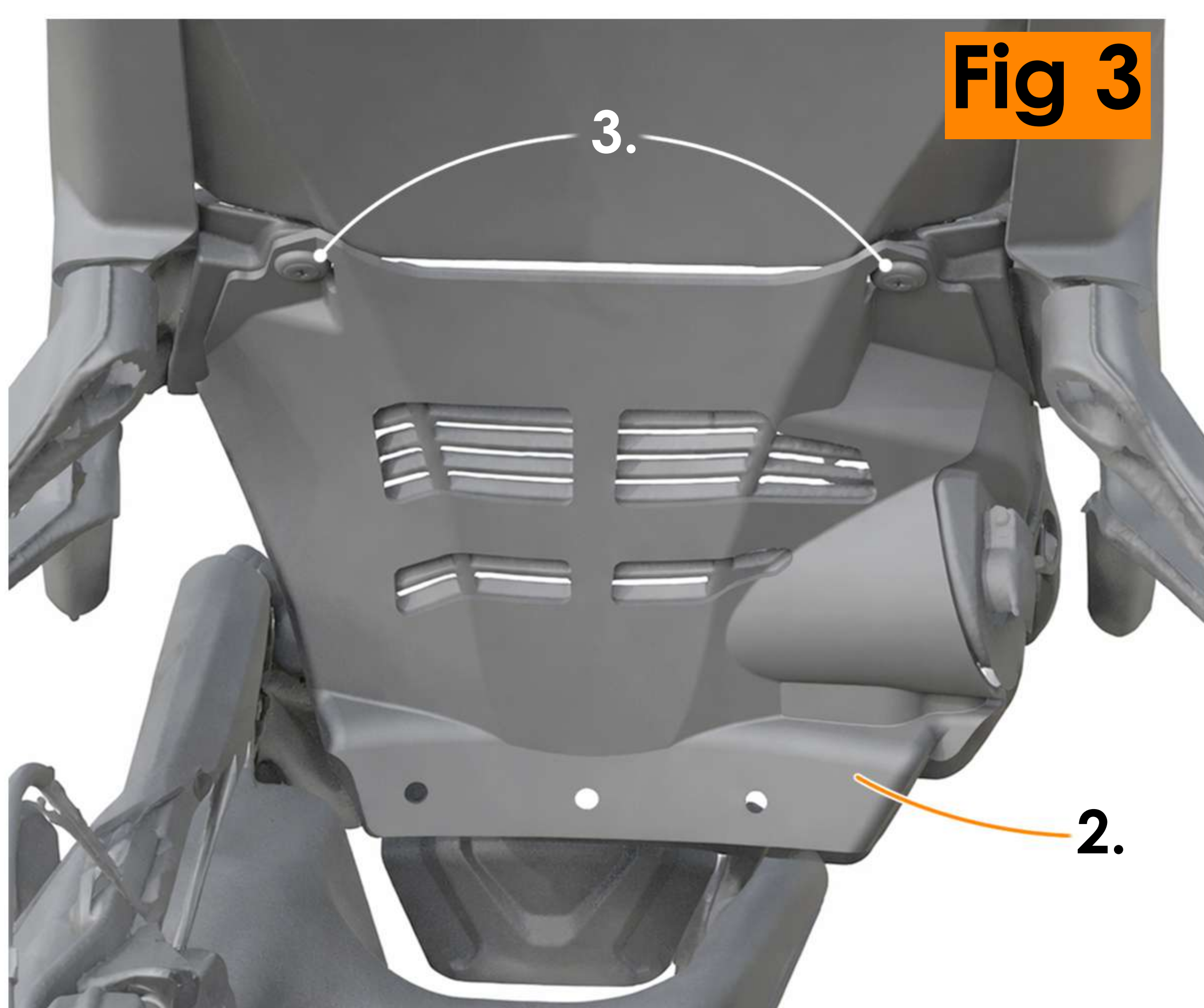

Fig 3



Any questions?
sales@pyramidmoto.co.uk
 +44 (0)1427 677990
www.pyramidmoto.co.uk



Follow us on social media and feel free to leave us a review!