



FITTING INSTRUCTIONS FOR LP0383BK TAIL TIDY



**This kit contains the items pictured and labelled over page.
Some parts may be shown for clarity of instructions only.
Do not proceed until you are sure all parts are present.
Please read all instructions before proceeding.**

**IF IN ANY DOUBT WHEN FITTING OUR PRODUCTS, CONSULT ONE OF OUR DEALERS OR
HAVE FITTED BY A QUALIFIED TECHNICIAN.**

Please note that the way the kit is packed does not necessarily represent the way of mounting to the bike.

In the event of rubber washers being used to hold components onto bolts, these rubber washers can be thrown away.

DIGITAL COPIES OF THESE INSTRUCTIONS ARE AVAILABLE FROM

WWW.RG-RACING.COM



LEGEND

ITEM No.	DESCRIPTION	QTY
ITEM 1	TB0383 PART 1 MAIN BRACKET	1
ITEM 2	TB0330 PART 2 LICENCE PLATE BRACKET	1
ITEM 3	LA0002 – LICENCE PLATE ILLUMINATOR	1
ITEM 4	M6X1.0X6MM BUTTON HEAD BOLT	3
ITEM 5	M8X1.25X25MM HEX HEAD BOLT	4
ITEM 6	M6X12MM O/D WASHER	3
ITEM 7	M8X16MM O/D WASHER	4
ITEM 8	M8 NYLOC NUT	4
ITEM 9	I0037 INDICATOR ADAPTORS	2
ITEM 10	I0016 INDICATOR ADAPTORS	4
ITEM 11	CON0034 INDICATOR WIRES	2
ITEM 12	CON0077 LA0002 CONNECTOR WIRE	1
ITEM 13	HEAT SHRINK 230MM LENGTH	3
ITEM 14	CT100 100MM CABLE TIES	4
ITEM 15	INDICATOR WIREING COVERS	2
ITEM 16	REFLECTOR	1

<u>TOOLS REQUIRED</u>	<u>GENERAL TORQUE SETTINGS</u>
<ul style="list-style-type: none"> • Torx sockets <ul style="list-style-type: none"> • Sockets • Wrench • Small flat bladed screw driver • Loctite or similar thread locker 	<p>M4 BOLT = 8Nm</p> <p>M5 BOLT = 12Nm</p> <p>M6 BOLT = 15Nm</p> <p>M8 BOLT = 20Nm</p> <p>M10 BOLT = 40Nm</p> <p>M12 BOLT = 40Nm</p>



EXPLODED ASSEMBLY DIAGRAM

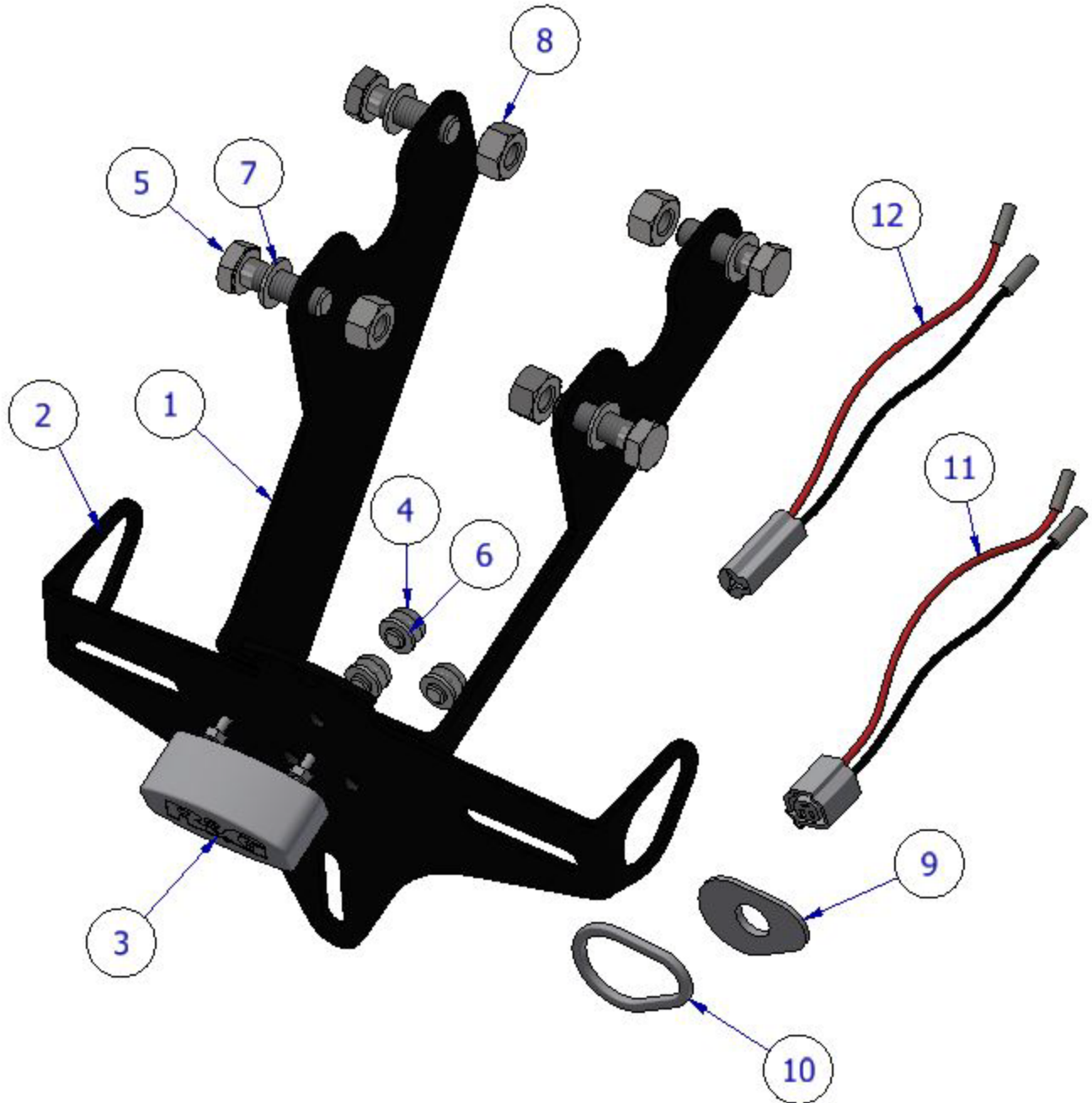



FITTING PICTURES



Picture 1



Picture 2



FITTING INSTRUCTIONS

Before fitting the R&G Tail Tidy, remove the following parts :

- Both seats
- Rear passenger side fairings
 - Rear undertray
 - Number plate bracket
- Indicators from the OEM number plate bracket (re-use with new Tail Tidy)
 - Number plate (re-use with new Tail Tidy)
 - Unplug all rear light connectors/ indicator wires

R&G Tail Tidy Assembly

1. Assemble the tail tidy as shown in the Exploded Assembly Diagram on Page 3.
2. Place the indicator adaptors (**ITEM 10**) on both indicators to adapt for the spacing.
3. Place the indicators into the number plate bracket (**ITEM 2**)
4. Connect CON0077 (**ITEM 12**) To the number plate illuminator (ITEM 2) colour matching wires to each other.
5. Connect CON0034 (**ITEM 11**) To both indicators, colour matching wires to each other.
6. Align the full assembly up to the mounting location (where the OEM number plate bracket was mounted).
7. Place the bolts (**ITEM 5**) With the washers (**ITEM 7**) Through the rear frame and through the main bracket (ITEM 1) to rest it in place.
8. Place the M8 Nyloc Nuts (**ITEM 8**) in the inside of the new tail tidy bracket onto the bolts that were install in step 6. Tighten using the General Torque Settings on Page 2.
9. Feed the indicator wires under the bracket and cable tie them together with the number plate light cable (see Picture 1).
10. Feed the cables through the OEM central undertray cover and feed the cables back into the bikes rear seat tray.
11. Connect the connectors back to the bike and ensure all lights and indicators are working. If not change the rotation of the bullet connectors in case they are the incorrect way around.
12. Now all of the R&G products are fitted, start re-fitting all of the OEM components that were removed. (OEM number plate bracket no longer needed).
13. Once fully installed it should look like Picture 2.

R&G

Unit 1, Shelley's Lane, East Worldham, Alton, Hampshire, GU34 3AQ
 Tel: +44 (0)1420 89007 www.rg-racing.com Email: info@rg-racing.com



**Re-fit the licence plate to the bike (it may require drilling).
Depending on local laws, fit the reflector provided (item 12) to an appropriate
location.**

IMPORTANT: FOR SAFETY, ENSURE THE LICENCE PLATE IS PLACED AS HIGH AS POSSIBLE ON THE TAIL TIDY (IT MAY REQUIRE DRILLING). IF FITTING A LICENCE PLATE OF 200MM OR LONGER (INCLUDING ANY SHROUD OR REFLECTOR ATTACHMENT) TO THE BRACKET, BEFORE RIDING, FULLY COMPRESS THE SUSPENSION TO ENSURE NO PART OF THE ASSEMBLY CAN CONTACT THE TYRE WHILE THE VEHICLE IS IN MOTION OR UNDER LOAD. IT IS YOUR RESPONSIBILITY TO CHECK FOR THIS POSSIBILITY AND TAKE AVOIDING ACTION. FAILURE TO CHECK THIS COULD RESULT IN SERIOUS INJURY OR DAMAGE TO THE MOTORCYCLE.

ISSUE 1 23/09/2024 (JH)

CONSUMER NOTICE

The catalogue description and any exhibition of samples are only broad indications of the Products and R&G may make design changes which do not diminish their performance or visual appeal and supplying them in such state shall conform to the order. The Buyer acknowledges no representation or warranty (other than as to title) has been given or will apply to the Products other than those in R&G's order or confirmation and the Buyer confirms it has chosen the Products as being of merchantable quality and suitable for its particular purposes. Where R&G fits the Products or undertakes other services it shall exercise reasonable skill and care and rectify any fault free of charge unless the workmanship has been disturbed. The Buyer is responsible for ensuring that the warranty on the motorcycle is not affected by the fitting of the Products. On return of any defective Products R&G shall at its option either supply a replacement or refund the purchase money but shall not be liable if the Products have been modified or used or maintained otherwise than in accordance with R&G's or manufacturer's instructions and good engineering practice or if the defect arises from accident or neglect. Other than identified above and subject to R&G not limiting its liability for causing death and personal injury, it shall not be liable for indirect or consequential loss and otherwise its liability shall be limited to the amounts paid by the Buyer for the Products or the fitting or service concerned. These terms do not affect the Buyer's statutory rights.

R&G RETURNS POLICY (NON-FAULTY GOODS)

Returns must be pre-authorized (if not pre-authorized the return will be rejected). Goods may only be returned direct to us if they were purchased direct from us (customer must prove if necessary). Otherwise to be returned to original vendor. Goods must be in re-sellable condition, in the opinion of R&G. All returns are subject to a 25% restocking and handling fee (25% of the gross value exc. P&P – at the prevailing price at time of purchase). The customer must pay any and all carriage charges. No returns of discontinued products, unless within 14 days of purchase. This policy does not affect your statutory rights and does not refer to faulty goods.

R&G

Unit 1, Shelley's Lane, East Worldham, Alton, Hampshire, GU34 3AQ
Tel: +44 (0)1420 89007 www.rg-racing.com Email: info@rg-racing.com



NOTICE DE MONTAGE LP0383BK SUPPORT DE PLAQUE



CE KIT CONTIENT LES ARTICLES ILLUSTRÉS ET ÉTIQUETES SUR LA PAGE.

CERTAINES PARTIES PEUVENT ÊTRE PRÉSENTES UNIQUEMENT POUR LA CLARTÉ DES INSTRUCTIONS.

NE PAS PROCÉDER AU MONTAGE TANT QUE VOUS N'ÊTES PAS SÛR QUE TOUTES LES PIÈCES SOIENT PRÉSENTES.

VEUILLEZ LIRE TOUTES LES INSTRUCTIONS AVANT DE CONTINUER.

**EN CAS DE DOUTE LORS DU MONTAGE DE NOS PRODUITS, CONSULTEZ UN DE NOS
REVENDEURS OU FAITES APPEL À UN TECHNICIEN QUALIFIÉ.**

VEUILLEZ NOTER QUE LA FAÇON DONT LE KIT EST EMBALLÉ NE REPRÉSENTE PAS NECESSAIREMENT LA
MANIÈRE DE LE MONTER SUR LA MOTO.

SI DES RONDELLES EN CAOUTCHOUC SONT UTILISÉES POUR MAINTENIR LES COMPOSANTS SUR LES
BOULONS, ELLES PEUVENT ÊTRE JETÉES.

NOTICE DISPONIBLE AU TÉLÉCHARGEMENT SUR :
WWW.RG-RACING.COM



LÉGENDE

ARTICLE No.	DESCRIPTION	QTÉ
ARTICLE 1	TB0383 PARTIE 1 SUPPORT PRINCIPAL	1
ARTICLE 2	TB0330 PARTIE 2 SUPPORT DE PLAQUE	1
ARTICLE 3	LA0002 - FEU DE PLAQUE	1
ARTICLE 4	M6X1.0X6MM BOULON	3
ARTICLE 5	M8X1.25X25MM BOULON	4
ARTICLE 6	M6X12MM RONDELLE	3
ARTICLE 7	M8X16MM RONDELLE	4
ARTICLE 8	M8 ÉCROU	4
ARTICLE 9	I0037 ADAPTATEURS DE CLIGNOTANT	2
ARTICLE 10	I0016 ADAPTATEURS DE CLIGNOTANT	4
ARTICLE 11	CON0034 FILS DE CLIGNOTANTS	2
ARTICLE 12	CON0077 LA0002 FIL DE CONNECTEUR	1
ARTICLE 13	LONGUEUR DE MANCHON THERMO RÉTRACTABLE 230MM	3
ARTICLE 14	CT100 100MM COLLIERS DE SERRAGE	4
ARTICLE 15	CACHES FILS DE CLIGNOTANTS	2
ARTICLE 16	RÉFLECTEUR	1

<u>OUTILS REQUIS</u>	<u>VALEURS DE SERRAGE</u>
<ul style="list-style-type: none"> • Douilles Torx <ul style="list-style-type: none"> • Douilles <ul style="list-style-type: none"> • Clés • Petit tournevis à lame plate • Loctite ou frein-filet similaire 	M4 BOULON = 8Nm M5 BOULON = 12Nm M6 BOULON = 15Nm M8 BOULON = 20Nm M10 BOULON = 40Nm M12 BOULON = 40Nm

R&G

Unit 1, Shelley's Lane, East Worldham, Alton, Hampshire, GU34 3AQ
 Tel: +44 (0)1420 89007 www.rg-racing.com Email: info@rg-racing.com



SCHÉMA D'ASSEMBLAGE

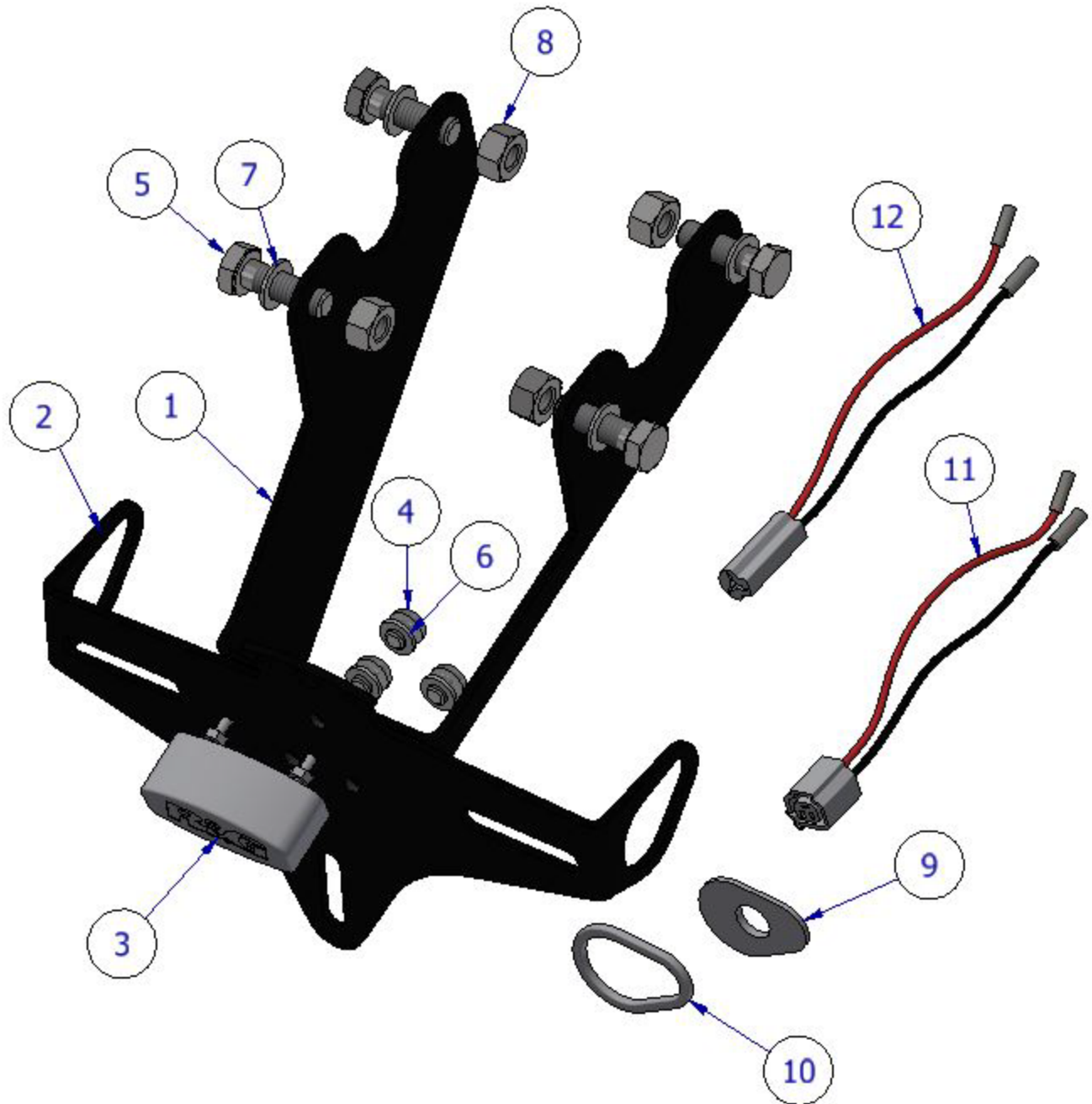

R&G

Unit 1, Shelley's Lane, East Worldham, Alton, Hampshire, GU34 3AQ
Tel: +44 (0)1420 89007 www.rg-racing.com Email: info@rg-racing.com



PHOTOS DE MONTAGE



Photo 1



Photo 2



NOTICE DE MONTAGE

Avant d'installer le R&G Tail Tidy, retirez les pièces suivantes:

- Les deux sièges
- Carénages côté passager arrière
 - Passage de roue arrière
- Support de plaque d'immatriculation
- Clignotants du support de plaque d'immatriculation d'origine (réutilisation avec le nouveau support)
 - Plaque d'immatriculation (réutilisation avec le nouveau support)
 - Débranchez tous les connecteurs de feux arrière/câbles de clignotants

Assemblage de support R&G

14. Assemblez le support arrière comme indiqué sur le schéma d'assemblage éclaté à la page 3.
15. Placez les adaptateurs de clignotant (ARTICLE 10) sur les deux clignotants pour adapter l'espacement.
16. Placez les clignotants dans le support de plaque d'immatriculation (ARTICLE 2)
17. Connectez CON0077 (ARTICLE 12) à l'éclairage de plaque d'immatriculation (ARTICLE 2) en faisant correspondre les fils de couleur entre eux.
18. Connectez CON0034 (ARTICLE 11) aux deux clignotants, en faisant correspondre les fils de couleur entre eux.
19. Alignez l'ensemble complet jusqu'à l'emplacement de montage (où le support de plaque d'immatriculation d'origine a été monté).
20. Placez les boulons (ARTICLE 5) avec les rondelles (ARTICLE 7) à travers le cadre arrière et à travers le support principal (ARTICLE 1) pour le maintenir en place.
21. Placez les écrous Nyloc M8 (ARTICLE 8) à l'intérieur du nouveau support arrière sur les boulons qui ont été installés à l'étape 6. Serrez en utilisant les réglages de couple généraux de la page 2.
22. Faites passer les fils des clignotants sous le support et attachez-les avec le câble d'éclairage de la plaque d'immatriculation (voir l'image 1).
23. Faites passer les câbles à travers le couvercle du sous-plateau central d'origine et faites-les passer dans le plateau de siège arrière de la moto.

R&G

Unit 1, Shelley's Lane, East Worldham, Alton, Hampshire, GU34 3AQ
Tel: +44 (0)1420 89007 www.rg-racing.com Email: info@rg-racing.com



24. Rebranchez les connecteurs à la moto et assurez-vous que tous les feux et clignotants fonctionnent. Sinon, faites tourner les connecteurs au cas où ils seraient dans le mauvais sens.
25. Maintenant que tous les produits R&G sont installés, commencez à remonter tous les composants d'origine qui ont été retirés. (Le support de plaque d'immatriculation d'origine n'est plus nécessaire).
26. Une fois entièrement installé, il devrait ressembler à l'image 2.

**Remontez la plaque d'immatriculation sur la moto (il faudra peut-être percer).
En fonction des lois locales, installez le réflecteur fourni (article 12) à un
emplacement approprié.**

IMPORTANT : SI VOUS MONTEZ UNE PLAQUE D'IMMATRICULATION DE GRANDE TAILLE ET LA PLACEZ BIEN EN BAS SUR LE SUPPORT DE PLAQUE D'IMMATRICULATION, IL Y A UN RISQUE QUE LA PLAQUE D'IMMATRICULATION FRAPPE LA ROUE ARRIÈRE SOUS UNE CHARGE LOURDE ET SUR DE GROSSES BOSSES SUR LA ROUTE. IL EST DE VOTRE RESPONSABILITÉ DE VÉRIFIER CETTE POSSIBILITÉ ET DE PRENDRE DES MESURES POUR ÉVITER. NE PAS VÉRIFIER CELA POURRAIT ENTRAÎNER DES BLESSURES GRAVES.

ISSUE 1 23/09/2024 (JH)

CONSUMER NOTICE

The catalogue description and any exhibition of samples are only broad indications of the Products and R&G may make design changes which do not diminish their performance or visual appeal and supplying them in such state shall conform to the order. The Buyer acknowledges no representation or warranty (other than as to title) has been given or will apply to the Products other than those in R&G's order or confirmation and the Buyer confirms it has chosen the Products as being of merchantable quality and suitable for its particular purposes. Where R&G fits the Products or undertakes other services it shall exercise reasonable skill and care and rectify any fault free of charge unless the workmanship has been disturbed. The Buyer is responsible for ensuring that the warranty on the motorcycle is not affected by the fitting of the Products. On return of any defective Products R&G shall at its option either supply a replacement or refund the purchase money but shall not be liable if the Products have been modified or used or maintained otherwise than in accordance with R&G's or manufacturer's instructions and good engineering practice or if the defect arises from accident or neglect. Other than identified above and subject to R&G not limiting its liability for causing death and personal injury, it shall not be liable for indirect or consequential loss and otherwise its liability shall be limited to the amounts paid by the Buyer for the Products or the fitting or service concerned. These terms do not affect the Buyer's statutory rights.

R&G RETURNS POLICY (NON-FAULTY GOODS)

Returns must be pre-authorized (if not pre-authorized the return will be rejected). Goods may only be returned direct to us if they were purchased direct from us (customer must prove if necessary). Otherwise to be returned to original vendor. Goods must be in re-sellable condition, in the opinion of R&G. All returns are subject to a 25% restocking and handling fee (25% of the gross value exc. P&P - at the prevailing price at time of purchase). The customer must pay any and all carriage charges. No returns of discontinued products, unless within 14 days of purchase. This policy does not affect your statutory rights and does not refer to faulty goods.

R&G

Unit 1, Shelley's Lane, East Worldham, Alton, Hampshire, GU34 3AQ
Tel: +44 (0)1420 89007 www.rg-racing.com Email: info@rg-racing.com