



FITTING INSTRUCTIONS FOR LP0333 - LICENCE PLATE BRACKET



THIS KIT CONTAINS THE ITEMS PICTURED AND LABELLED OVER PAGE.

SOME PARTS MAY BE SHOWN FOR CLARITY OF INSTRUCTIONS ONLY.

DO NOT PROCEED UNTIL YOU ARE SURE ALL PARTS ARE PRESENT.

PLEASE READ ALL INSTRUCTIONS BEFORE PROCEEDING.

**IF IN ANY DOUBT WHEN FITTING OUR PRODUCTS, CONSULT ONE OF OUR DEALERS
OR HAVE FITTED BY A QUALIFIED TECHNICIAN.**

PLEASE NOTE THAT THE WAY THE KIT IS PACKED DOES NOT NECESSARILY REPRESENT THE WAY OF
MOUNTING TO THE BIKE.

IN THE EVENT OF RUBBER WASHERS BEING USED TO HOLD COMPONENTS ONTO BOLTS,
THESE RUBBER WASHERS CAN BE THROWN AWAY.

DIGITAL COPIES OF THESE INSTRUCTIONS ARE AVAILABLE FROM:

WWW.RG-RACING.COM

R&G Racing

Unit 1, Shelley's Lane, East Worldham, Alton, Hampshire, GU34 3AQ

Tel: +44 (0)1420 89007 Fax: +44 (0)1420 87301 www.rg-racing.com Email: info@rg-racing.com



<u>TOOLS REQUIRED</u>	<u>GENERAL TORQUE SETTINGS</u>
<ul style="list-style-type: none"> • METRIC SPANNER SET • METRIC ALLEN SET • METRIC SOCKET AND WRENCH WITH EXTENSION 	M4 BOLT = 8Nm M5 BOLT = 12Nm M6 BOLT = 15Nm M8 BOLT = 20Nm M10 BOLT = 40Nm M12 BOLT = 40Nm

LEGEND

ITEM NO.	DESCRIPTION	QTY
ITEM 1	MAIN BRACKET - LHS (TB0333 PART 1)	1
ITEM 2	MAIN BRACKET - RHS (TB0333 PART 2)	1
ITEM 3	END PLATE (TB0333 PART 3)	1
ITEM 4	M5 x 12mm COUNTERSUNK BOLTS	4
ITEM 5	M5 NUTS	4
ITEM 6	M5 WASHER	4
ITEM 7	M6 WASHER (NOT SHOWN)	4
ITEM 8	NUMBER PLATE ILLUMINATOR (LA0002)	1
ITEM 9	MINI INDICATOR WIRING ADAPTORS (CON0021)	2
ITEM 10	LISCENCE PLATE ILLUMINATOR CONNECTOR (CON0080 - NOT SHOWN)	1
ITEM 11	CABLE TIES	4
ITEM 12	HEAT SHRINK	3
ITEM 13	SELF ADHESIVE CLIP	2
ITEM 14	REFLECTOR	1

R&G Racing

Unit 1, Shelley's Lane, East Worldham, Alton, Hampshire, GU34 3AQ

Tel: +44 (0)1420 89007 Fax: +44 (0)1420 87301 www.rg-racing.com Email: info@rg-racing.com



MAIN ASSEMBLY EXPLODED VIEW

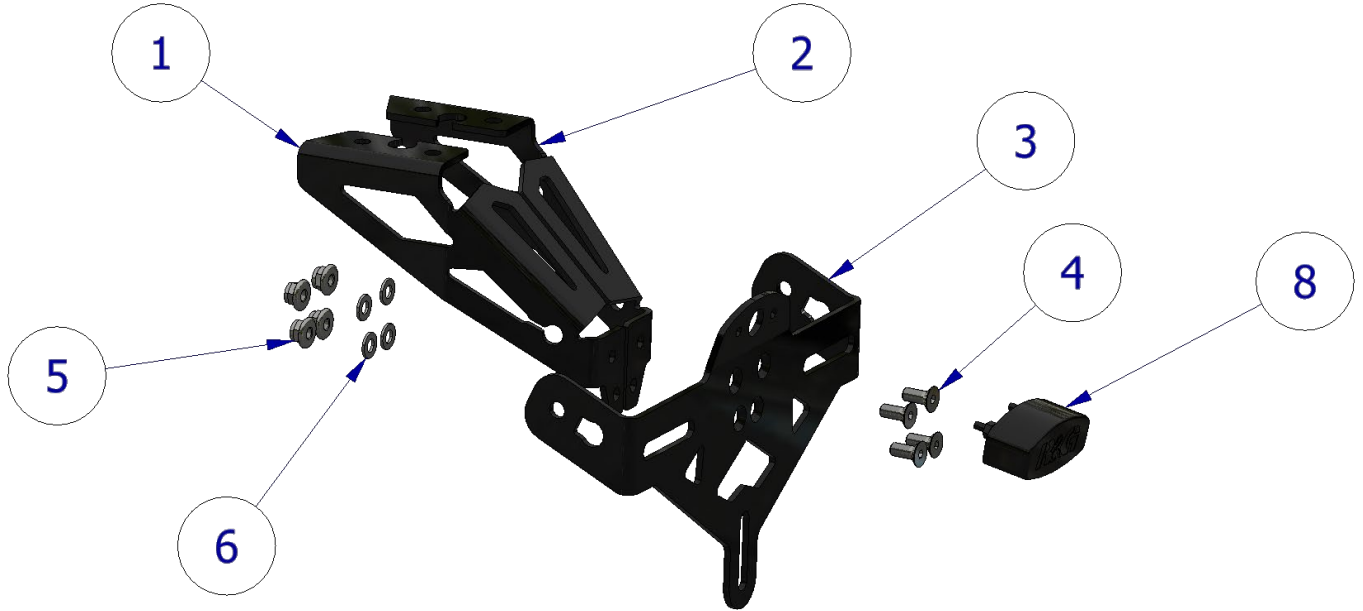

ADDITIONAL COMPONENTS

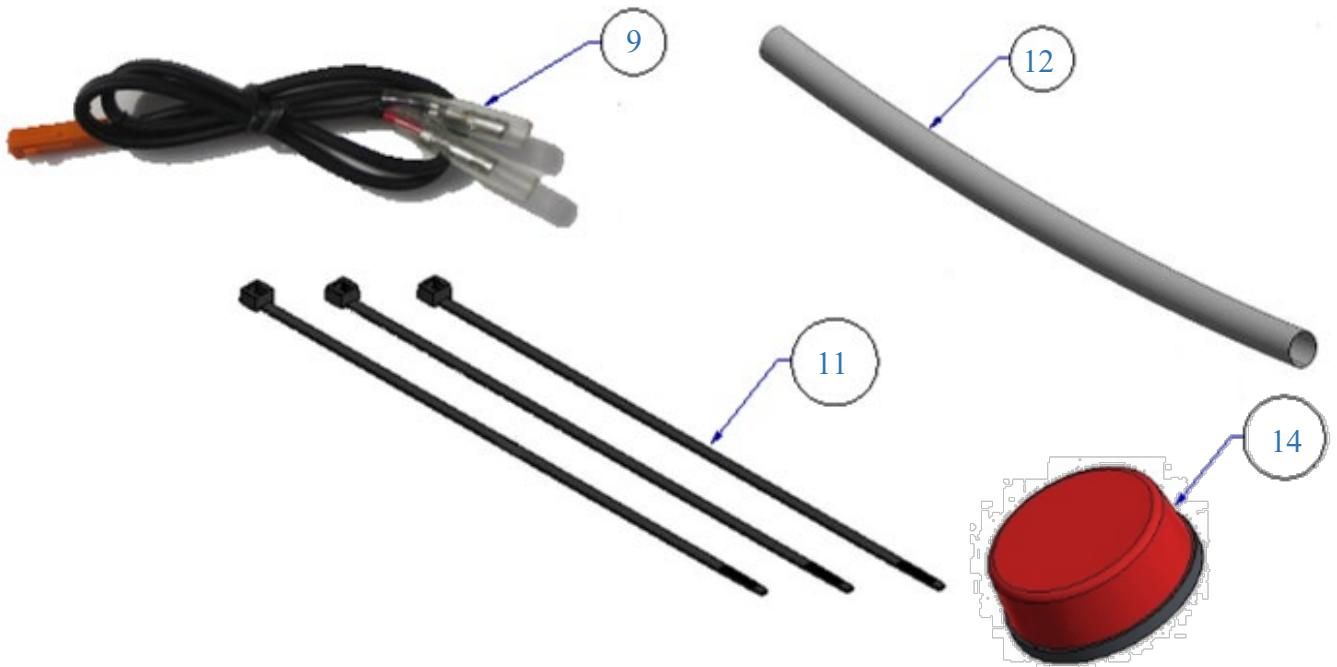



FITTING PICTURES



Picture 1



Picture 2

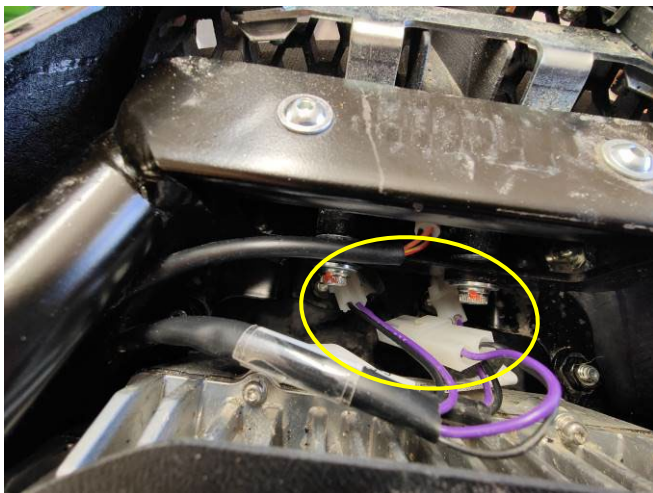

Picture 3



Picture 4



Picture 5

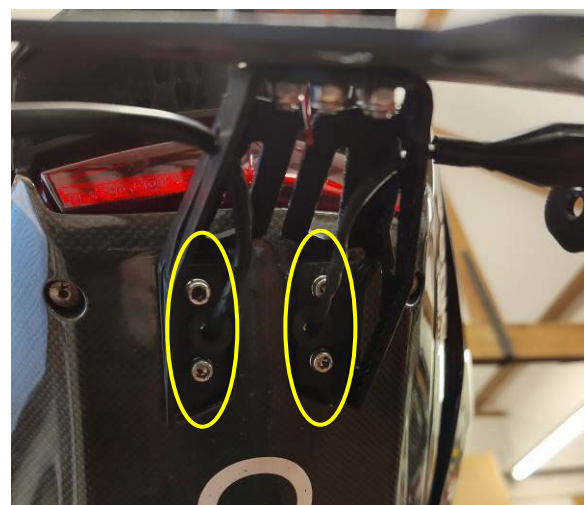

Picture 6



FITTING INSTRUCTIONS

- Begin by removing the passenger seat using the key, as shown in **Picture 1**.
- Disconnect all three connectors shown in **Picture 3**, noting the application of each.
- Remove the 4x bolts on the underside of the undertray (shown in **Picture 2**) and carefully remove the OEM tail bracket.
- Fit the brake light bracket (**Item 3**) to the main brackets (**Item 1 & 2**) using the 4x M5 bolts & 4x M5 nuts & washers (**Items 4, 5 & 6**) in the orientation shown in the main assembly diagram.
- Re-assemble the indicator assemblies as original, if using R&G mini-indicators use the indicator wiring adaptors (**Item 9**) to connect them to the OEM harness, & use the heatshrink & wiring covers to hide the wires.
- Secure the license plate light (**Item 8**) to the bracket (as shown in **Picture 5**), then fit the remaining wiring connector to the license plate light bullet connectors & cover with the heatshrink, then thread the 3x wires through the small hole in the centre of the main bracket & brake light bracket.
- The wires can be secured to the main bracket with the cable ties & clips (**Items 11 & 13**) and passed through the grommets (Shown in **Picture 4**).
- Offer the tail bracket assembly up to the original mountings, with the wiring fed through the cut-out.
- Secure the tail bracket to the bike with the 4x OEM M6 bolts and included washers (**Item 7**) as shown in **Picture 6**.
- Correctly reconnect all wiring and refit passenger seat.
- Test operation of all lights.
- Mount the licence plate (it may require drilling) to the bracket in a central position.
- Depending on local laws, attach enclosed reflector (**Item 14**) in an appropriate location.
- **IMPORTANT: IF FITTING A FULL-SIZE LICENCE PLATE AND PLACING IT FAR DOWN ON THE LICENCE PLATE HANGER, THERE IS A SMALL CHANCE OF THE LICENCE PLATE HITTING THE BACK WHEEL UNDER HEAVY LOAD AND OVER LARGE BUMPS IN THE ROAD. IT IS YOUR RESPONSIBILITY TO CHECK FOR THIS POSSIBILITY AND TAKE AVOIDING ACTION. FAILURE TO CHECK THIS COULD RESULT IN SERIOUS INJURY.**

See more R&G products for your Motorcycle in the link below:

[R&G Racing | All Products for ENERGICA - EGO \(2021\) \(rg-racing.com\)](http://www.rg-racing.com)

ISSUE 1 – 29/11/2022 (MH)



CONSUMER NOTICE

The catalogue description and any exhibition of samples are only broad indications of the Products and R&G may make design changes which do not diminish their performance or visual appeal and supplying them in such state shall conform to the order. The Buyer acknowledges no representation or warranty (other than as to title) has been given or will apply to the Products other than those in R&G's order or confirmation and the Buyer confirms it has chosen the Products as being of merchantable quality and suitable for its particular purposes. Where R&G fits the Products or undertakes other services it shall exercise reasonable skill and care and rectify any fault free of charge unless the workmanship has been disturbed. The Buyer is responsible for ensuring that the warranty on the motorcycle is not affected by the fitting of the Products. On return of any defective Products R&G shall at its option either supply a replacement or refund the purchase money but shall not be liable if the Products have been modified or used or maintained otherwise than in accordance with R&G's or manufacturer's instructions and good engineering practice or if the defect arises from accident or neglect. Other than identified above and subject to R&G not limiting its liability for causing death and personal injury, it shall not be liable for indirect or consequential loss and otherwise its liability shall be limited to the amounts paid by the Buyer for the Products or the fitting or service concerned. These terms do not affect the Buyer's statutory rights.

R&G RACING RETURNS POLICY (NON-FAULTY GOODS)

Returns must be pre-authorized (if not pre-authorized the return will be rejected). Goods may only be returned direct to us if they were purchased direct from us (customer must prove if necessary). Otherwise to be returned to original vendor. Goods must be in re-sellable condition, in the opinion of R&G Racing. All returns are subject to a 25% restocking and handling fee (25% of the gross value exc. P&P – at the prevailing price at time of purchase). The customer must pay any and all carriage charges. No returns of discontinued products, unless within 14 days of purchase. This policy does not affect your statutory rights and does not refer to faulty goods.

R&G Racing

Unit 1, Shelley's Lane, East Worldham, Alton, Hampshire, GU34 3AQ

Tel: +44 (0)1420 89007 Fax: +44 (0)1420 87301 www.rg-racing.com Email: info@rg-racing.com



NOTICE DE MONTAGE POUR LP0333 - SUPPORT DE PLAQUE



CE KIT CONTIENT LES ARTICLES ILLUSTRÉS ET ÉTIQUETES SUR LA PAGE.

CERTAINES PARTIES PEUVENT ÊTRE PRÉSENTES UNIQUEMENT POUR LA CLARTE DES INSTRUCTIONS.

NE PAS PROCÉDER AU MONTAGE TANT QUE VOUS N'ÊTES PAS SÛR QUE TOUTES LES PIÈCES SOIENT PRÉSENTES.

VEUILLEZ LIRE TOUTES LES INSTRUCTIONS AVANT DE CONTINUER.

EN CAS DE DOUTE LORS DU MONTAGE DE NOS PRODUITS, CONSULTEZ UN DE NOS REVENDEURS OU FAITES APPEL A UN TECHNICIEN QUALIFIÉ.

VEUILLEZ NOTER QUE LA FAÇON DONT LE KIT EST EMBALLÉ NE REPRÉSENTE PAS NECESSAIREMENT LA MANIÈRE DE LE MONTER SUR LA MOTO.

SI DES RONDELLES EN CAOUTCHOUC SONT UTILISÉES POUR MAINTENIR LES COMPOSANTS SUR LES BOULONS, ELLES PEUVENT ÊTRE JETÉES.

NOTICE DISPONIBLE AU TÉLÉCHARGEMENT SUR : WWW.RG-RACING.COM



<u>OUTILS REQUIS</u>	<u>VALEURS DE SERRAGE</u>
<ul style="list-style-type: none"> • CLÉ MÉTRIQUE • CLÉ ALLEN • DOUILLE MÉTRIQUE + DOUILLES AVEC RALLONGE 	M4 BOULON = 8Nm M5 BOULON = 12Nm M6 BOULON = 15Nm M8 BOULON = 20Nm M10 BOULON = 40Nm M12 BOULON = 40Nm

LÉGENDE

ARTICLE NO.	DESCRIPTION	QTÉ
ARTICLE 1	SUPPORT PRINCIPAL - GAUCHE (TB0333 PARTIE 1)	1
ARTICLE 2	SUPPORT PRINCIPAL - DROITE (TB0333 PARTIE 2)	1
ARTICLE 3	PLAQUE D'EXTRÉMITÉ (TB0333 PARTIE 3)	1
ARTICLE 4	M5 x 12mm BOULONS	4
ARTICLE 5	M5 ÉCROUS	4
ARTICLE 6	M5 RONDELLE	4
ARTICLE 7	M6 RONDELLE (NON INDIQUÉE)	4
ARTICLE 8	FEU DE PLAQUE (LA0002)	1
ARTICLE 9	ADAPTATEURS DE CÂBLE DE MINI CLIGNOTANTS (CON0021)	2
ARTICLE 10	CONNECTEUR DE FEU DE PLAQUE (CON0080 - NON INDIQUÉ)	1
ARTICLE 11	COLLIERS DE SERRAGE	4
ARTICLE 12	MANCHON THERMO RÉTRACTABLE	3
ARTICLE 13	CLIP AUTOCOLLANT	2
ARTICLE 14	RÉFLECTEUR	1



ASSEMBLAGE PRINCIPAL

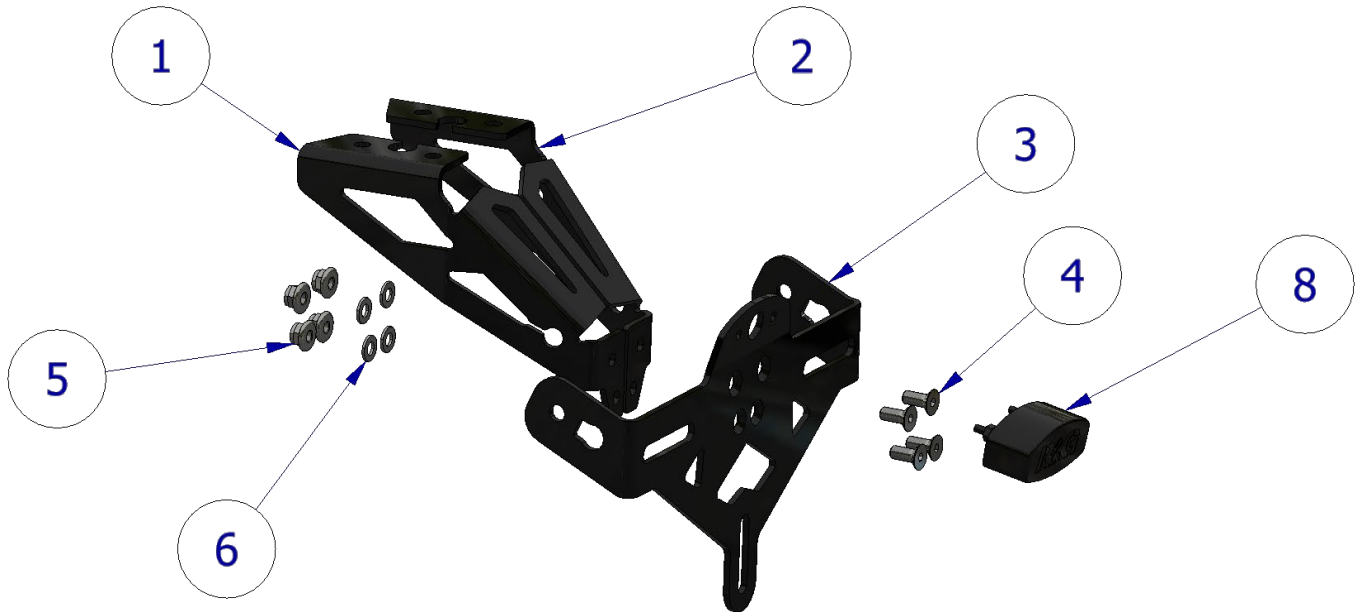

COMPOSANTS ADDITIONNELS

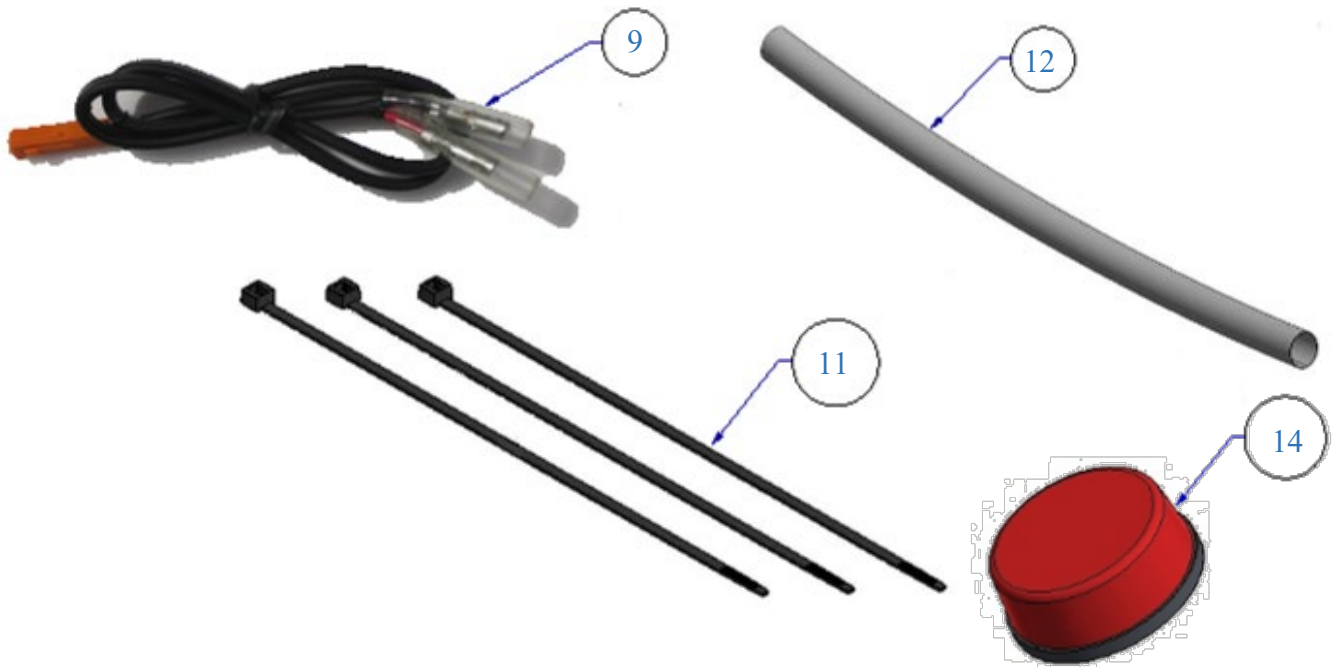



PHOTOS DE MONTAGE



Photo 1



Photo 2



Photo 3



Photo 4



Photo 5

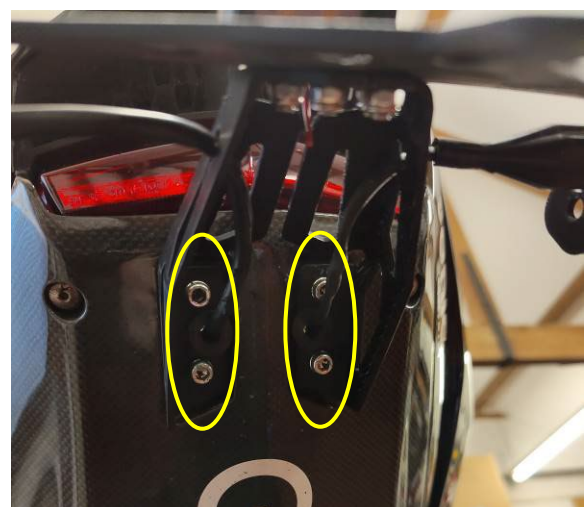

Photo 6



NOTICE DE MONTAGE

- Commencez par retirer la selle passager à l'aide de la clé, comme indiqué sur la Photo 1.
- Débranchez les trois connecteurs illustrés sur la photo 3, en notant l'application de chacun.
- Retirez les boulons 4x sur la face inférieure du passage de roue (illustré sur la photo 2) et retirez soigneusement le support de queue OEM.
- Montez le support de feu stop (article 3) sur les supports principaux (articles 1 et 2) à l'aide des 4 boulons M5 et des écrous et rondelles 4x M5 (articles 4, 5 et 6) dans l'orientation indiquée sur le schéma de montage principal.
- Réassemblez les ensembles de clignotants comme d'origine, si vous utilisez des mini-clignotants R&G, utilisez les adaptateurs de câblage de clignotant (article 9) pour les connecter au faisceau d'origine, et utilisez les gaines thermo rétractables et de câblage pour cacher les fils.
- Fixez le feu de plaque d'immatriculation (article 8) au support (comme indiqué sur la photo 5), puis installez le connecteur de câblage restant sur les connecteurs de feu de plaque d'immatriculation et couvrez avec la gaine thermo rétractable, puis faites passer les 3 fils à travers le petit trou dans le centre du support principal et du support de feu stop.
- Les fils peuvent être fixés au support principal avec les serre-câbles et les clips (articles 11 et 13) et passés à travers les œilletons (illustrés sur la photo 4).
- Présentez l'assemblage du support sur les fixations d'origine, avec le câblage qui passe à travers l'ouverture.
- Fixez le support sur la moto avec les 4 boulons d'origine M6 et les rondelles incluses (article 7) comme indiqué sur la photo 6.
- Rebranchez correctement tout le câblage et remontez la selle passager.
- Testez le fonctionnement de tous les feux.
- Montez la plaque d'immatriculation (cela peut nécessiter un perçage) sur le support en position centrale.
- En fonction des lois locales, fixez le réflecteur fourni (article 14) à un endroit approprié.
- Commencez par retirer la selle passager à l'aide de la clé, comme indiqué sur la Photo 1.
- Débranchez les trois connecteurs illustrés sur la photo 3, en notant l'application de chacun.
- Retirez les boulons 4x sur la face inférieure du passage de roue (illustré sur la photo 2) et retirez soigneusement le support de queue OEM.
- Montez le support de feu stop (article 3) sur les supports principaux (articles 1 et 2) à l'aide des 4 boulons M5 et des écrous et rondelles 4x M5 (articles 4, 5 et 6) dans l'orientation indiquée sur le schéma de montage principal.

R&G Racing

Unit 1, Shelley's Lane, East Worldham, Alton, Hampshire, GU34 3AQ

Tel: +44 (0)1420 89007 Fax: +44 (0)1420 87301 www.rg-racing.com Email: info@rg-racing.com



- Réassemblez les ensembles d'indicateurs comme d'origine, si vous utilisez des mini-indicateurs R&G, utilisez les adaptateurs de câblage d'indicateur (article 9) pour les connecter au faisceau OEM, et utilisez les gaines thermo rétractables et de câblage pour cacher les fils.
- Fixez l'éclairage de la plaque d'immatriculation (article 8) au support (comme indiqué sur la photo 5), puis installez le connecteur de câblage restant sur les connecteurs de l'éclairage de la plaque d'immatriculation et couvrez avec la gaine thermo rétractable, puis faites passer les 3 fils à travers le petit trou dans le centre du support principal et du support de feu stop.
- Les fils peuvent être fixés au support principal avec les serre-câbles et les clips (articles 11 et 13) et passés à travers les œilletons (illustrés sur la photo 4).
- **IMPORTANT : SI VOUS MONTEZ UNE PLAQUE D'IMMATRICULATION DE GRANDE TAILLE ET LA PLACEZ BIEN EN BAS SUR LE SUPPORT DE PLAQUE D'IMMATRICULATION, IL Y A UN RISQUE QUE LA PLAQUE D'IMMATRICULATION FRAPPE LA ROUE ARRIÈRE SOUS UNE CHARGE LOURDE ET SUR DE GROSSES BOSSES SUR LA ROUTE. IL EST DE VOTRE RESPONSABILITÉ DE VÉRIFIER CETTE POSSIBILITÉ ET DE PRENDRE DES MESURES POUR ÉVITER. NE PAS VÉRIFIER CELA POURRAIT ENTRAÎNER DES BLESSURES GRAVES.**

Voir plus de produits R&G pour votre moto via ce lien :

[R&G Racing | All Products for ENERGICA - EGO \(2021\) \(rg-racing.com\)](http://www.rg-racing.com)

ISSUE 1 - 29/11/2022 (MH)

CONSUMER NOTICE

The catalogue description and any exhibition of samples are only broad indications of the Products and R&G may make design changes which do not diminish their performance or visual appeal and supplying them in such state shall conform to the order. The Buyer acknowledges no representation or warranty (other than as to title) has been given or will apply to the Products other than those in R&G's order or confirmation and the Buyer confirms it has chosen the Products as being of merchantable quality and suitable for its particular purposes. Where R&G fits the Products or undertakes other services it shall exercise reasonable skill and care and rectify any fault free of charge unless the workmanship has been disturbed. The Buyer is responsible for ensuring that the warranty on the motorcycle is not affected by the fitting of the Products. On return of any defective Products R&G shall at its option either supply a replacement or refund the purchase money but shall not be liable if the Products have been modified or used or maintained otherwise than in accordance with R&G's or manufacturer's instructions and good engineering practice or if the defect arises from accident or neglect. Other than identified above and subject to R&G not limiting its liability for causing death and personal injury, it shall not be liable for indirect or consequential loss and otherwise its liability shall be limited to the amounts paid by the Buyer for the Products or the fitting or service concerned. These terms do not affect the Buyer's statutory rights.

R&G RACING RETURNS POLICY (NON-FAULTY GOODS)

Returns must be pre-authorized (if not pre-authorized the return will be rejected). Goods may only be returned direct to us if they were purchased direct from us (customer must prove if necessary). Otherwise to be returned to original vendor. Goods must be in re-sellable condition, in the opinion of R&G Racing. All returns are subject to a 25% restocking and handling fee (25% of the gross value exc. P&P - at the prevailing price at time of purchase). The customer must pay any and all carriage charges. No returns of discontinued products, unless within 14 days of purchase. This policy does not affect your statutory rights and does not refer to faulty goods.

R&G Racing

Unit 1, Shelley's Lane, East Worldham, Alton, Hampshire, GU34 3AQ

Tel: +44 (0)1420 89007 Fax: +44 (0)1420 87301 www.rg-racing.com Email: info@rg-racing.com



MONTAGEANLEITUNG FÜR LP0333 – KENNZEICHENHALTER



ALLE KIT-TEILE SIND AUF DEN NACHFOLGENDEN SEITEN ABGEBILDET UND GEKENNZEICHNET.

DIE ABGEBILDETEN TEILE DIENEN LEDIGLICH ZUR ERKLÄRUNG.

ÜBERPRÜFEN SIE ZUERST, DASS ALLE TEILE VORHANDEN SIND.

LESEN SIE DIE MONTAGEANLEITUNG KOMPLETT DURCH, BEVOR SIE ANFANGEN.

WENN SIE BEI DER MONTAGE DIESES PRODUKTES UNSICHER SIND, BITTE EINEN UNSERER HÄNDLER KONTAKTIEREN ODER DAS KIT VON EINEM QUALIFIZIERTEN ZWEIRAD-MECHANIKER MONTIEREN LASSEN.

DIE VERPACKUNG DER TEILE STELLT NICHT DIE REIHENFOLGE DER MONTAGE DAR.

HINWEIS FÜR KITS MIT PLASTIKUNTERLEGSCHLEIBEN AN DEN SCHRAUBEN –
DIESE PLASTIK-UNTERLEGSCHLEIBEN WERDEN NICHT FÜR DEN EINBAU BENÖTIGT.

EINE DIGITALE VERSION DIESER MONTAGEANLEITUNG KANN AUF FOLGENDER SEITE HERUNTERGELADEN WERDEN:

[WWW.RG-RACING.COM](http://www.rg-racing.com)

R&G Racing

Unit 1, Shelley's Lane, East Worldham, Alton, Hampshire, GU34 3AQ

Tel: +44 (0)1420 89007 Fax: +44 (0)1420 87301 www.rg-racing.com Email: info@rg-racing.com

**SIE BENÖTIGEN FOLGENDES WERKZEUG**

- SATZ SCHRAUBENSCHLÜSSEL
- SATZ INBUSSCHLÜSSEL
- STECKSCHLÜSSEL MIT VERLÄNGERUNG

ALLGEM. ANZUGSDREHMOMENT

M4 SCHRAUBE = 8Nm
 M5 SCHRAUBE = 12Nm
 M6 SCHRAUBE = 15Nm
 M8 SCHRAUBE = 20Nm
 M10 SCHRAUBE = 40Nm
 M12 SCHRAUBE = 40Nm

LIEFERUMFANG

ARTIKEL NR.	BESCHREIBUNG	MENGE
ARTIKEL 1	KENNZEICHENHALTER -LINKE SEITE (TB0333 TEIL 1)	1
ARTIKEL 2	KENNZEICHENHALTER -RECHTE RHS (TB0333 TEIL 2)	1
ARTIKEL 3	ENDPLATTE (TB0333 TEIL 3)	1
ARTIKEL 4	M5 x 12mm SENKSCHRAUBE	4
ARTIKEL 5	M5 MUTTER	4
ARTIKEL 6	M5 UNTERLEGSCHÉIBE	4
ARTIKEL 7	M6 UNTERLEGSCHÉIBE (NICHT ABGEBILDET)	4
ARTIKEL 8	KENNZEICHENBELEUCHTUNG (LA0002)	1
ARTIKEL 9	MINIBLINKER KABEL- ADAPTER (CON0021)	2
ARTIKEL 10	VERBINDER FÜR KENNZEICHENBELEUCHTUNG (CON0080 - NICHT ABGEBILDET)	1
ARTIKEL 11	KABELBINDER	4
ARTIKEL 12	SCHRUMPFSCHLAUCH	3
ARTIKEL 13	SELBSTKLEBENDER CLIP	2
ARTIKEL 14	RÜCKSTRAHLER	1

R&G Racing

Unit 1, Shelley's Lane, East Worldham, Alton, Hampshire, GU34 3AQ

Tel: +44 (0)1420 89007 Fax: +44 (0)1420 87301 www.rg-racing.com Email: info@rg-racing.com



HAUPTZUSAMMENBAU - EXPLOSIONSZEICHNUNG

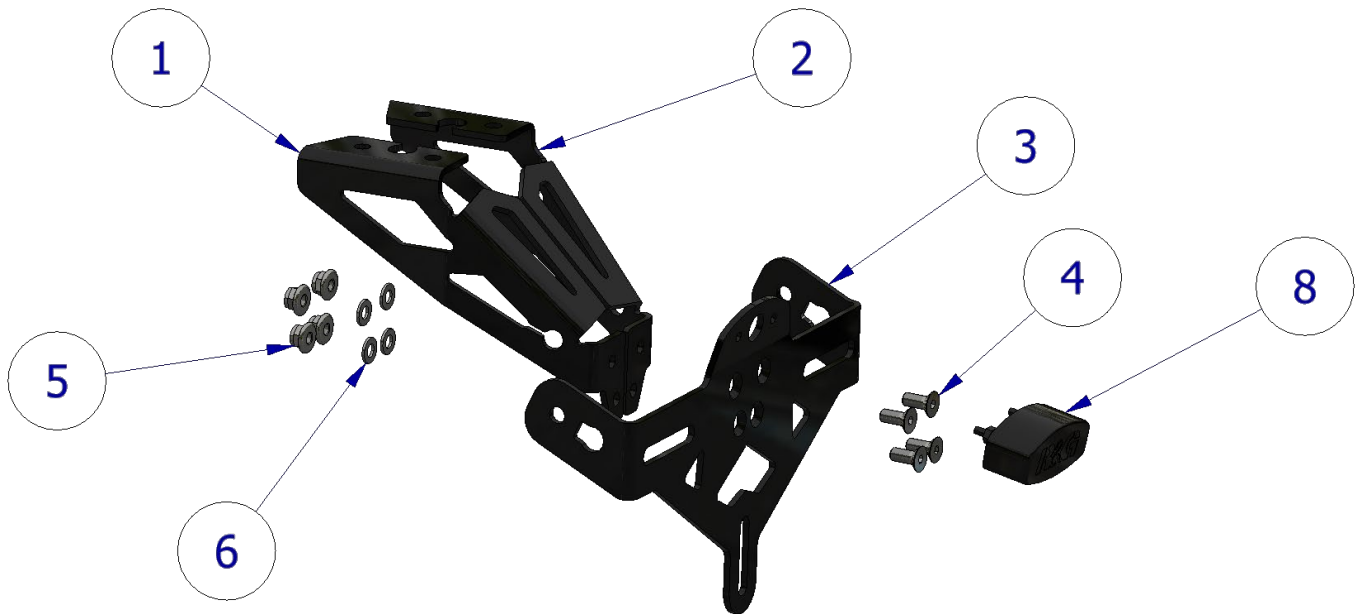

WEITERE KIT-TEILE

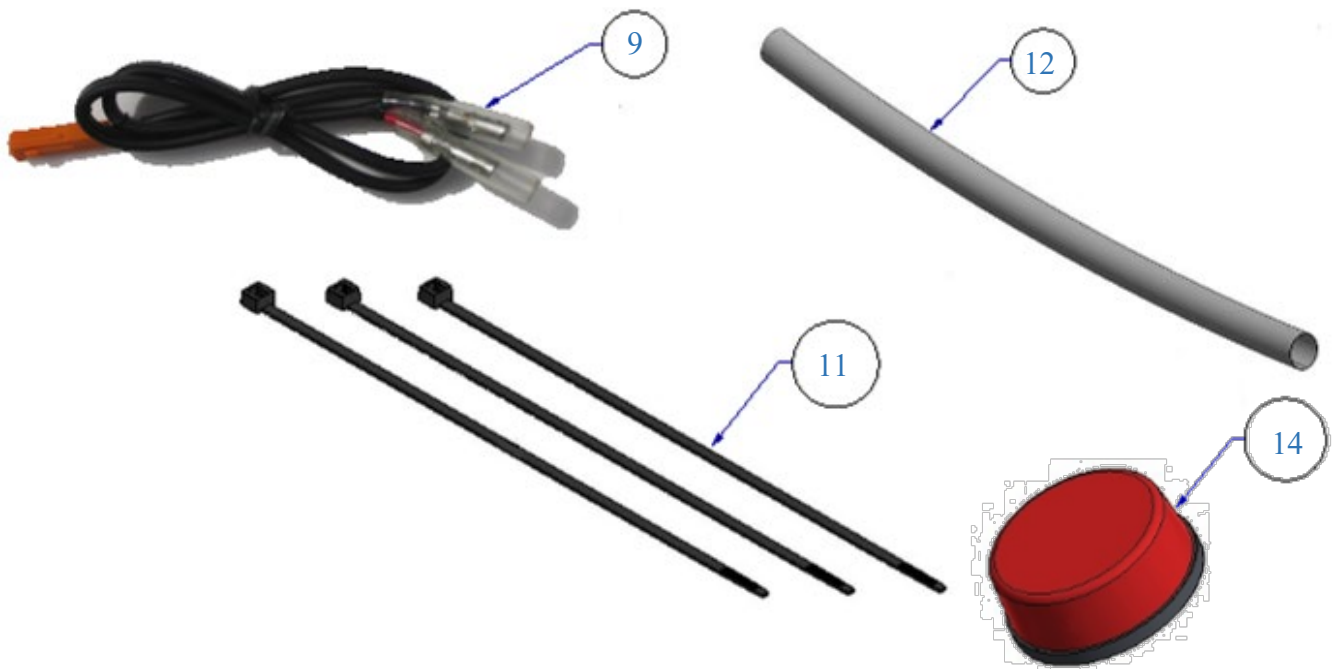



MONTAGE ABILDUNGEN



Abbildung 1



Abbildung 2



Abbildung 3



Abbildung 4



Abbildung 5



Abbildung 6



MONTAGEANLEITUNG

- Entfernen Sie den Sitz (Schlüssel wird benötigt) wie in **Abbildung 1** abgebildet.
- Trennen Sie alle drei Verbinder, die in **Abbildung 3** abgebildet sind und notieren Sie, wie sie angeschlossen waren.
- Entfernen Sie die 4x Schrauben an der Unterseite der unteren Abdeckung (abgebildet in **Abbildung 2**) und den original Kennzeichenhalter vorsichtig entfernen.
- Montieren Sie die Halterung für das Bremslicht (**Artikel 3**) an den Haupthalterungen (**Artikel 1 & 2**) mit den 4x M5 Schrauben & 4x M5 Muttern & Unterlegscheiben (**Artikel 4, 5 & 6**) wie in der Zeichnung für den Zusammenbau abgebildet.
- Die Blinker-Einheiten wie ursprünglich wieder zusammenbauen. Wenn Sie R&G Miniblinker montieren, benutzen Sie die Miniblinker Kabel-Adapter (**Artikel 9**), um sie mit dem original Kabelbaum zu verbinden und benutzen Sie Schrumpfschlauch & Kabelabdeckungen, um die Kabel abzudecken / zu verstecken.
- Die Kennzeichenbeleuchtung (**Artikel 8**) am Halter sichern (siehe **Abbildung 5**), dann verbinden Sie den übrigen Kabelverbinder mit den Verbindern für die Kennzeichenbeleuchtung & mit Schrumpfschlauch abdecken. Danach die 3x Kabel in die kleine Öffnung in der Mitte des Kennzeichenhalters /Bremslichthalterung einführen.
- Die Kabel können mit den Kabelbindern und Clips vom Kit (**Artikel 11 & 13**) gesichert und durch die Gummitüllen geschoben werden (in **Abbildung 4** abgebildet).
- Die Kennzeichenhalter-Einheit an die original Halterungen ansetzen und die Verkabelung durch den Ausschnitt schieben.
- Die Kennzeichenhalter am Motorrad befestigen mit den 4x original M6 Schrauben und Unterlegscheiben vom Kit (**Artikel 7**) wie in **Abbildung 6** abgebildet.
- Alle Kabel ordnungsgemäß wieder verbinden und danach den Beifahrersitz wieder montieren.
- Überprüfen Sie die Funktion der kompletten Beleuchtung.
- Montieren Sie das amtliche Kennzeichen (Bohrungen sind eventuell notwendig) mittig am neuen Kennzeichenhalter.
- Entsprechend der gesetzlichen Vorschriften, den mitgelieferten Rückstrahler (**Artikel 14**) an die dafür vorgesehene Stelle anbringen.
- **WICHTIG: WENN EIN GROSSES KENNZEICHEN ZU WEIT NACH UNTEN MONTIERT WIRD, BESTEHT BEI SCHWERER LAST ODER DURCH GROSSE BODENWELLEN EIN GERINGES RISIKO, DASS DAS KENNZEICHEN ANS HINTERRAD STOSSEN KANN. ES LIEGT IN IHRER VERANTWORTUNG DIES ZU ÜBERPRÜFEN UND, WENN NOTWENDIG, ENTSPRECHENDE MASSNAHMEN ZU ERGREIFEN, UM DIES ZU VERMEIDEN. DIE NICHTBEACHTUNG DIESES SICHERHEITSHINWEISES KANN ZU SCHWEREN VERLETZUNGEN FÜHREN.**

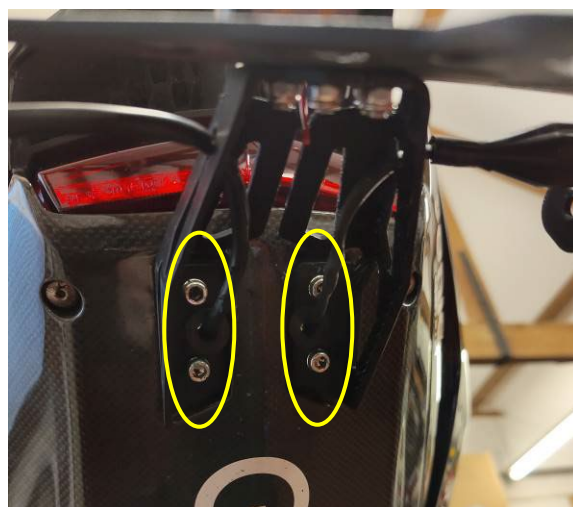
R&G Racing

Unit 1, Shelley's Lane, East Worldham, Alton, Hampshire, GU34 3AQ

Tel: +44 (0)1420 89007 Fax: +44 (0)1420 87301 www.rg-racing.com Email: info@rg-racing.com



Klicken Sie hier, um weitere R&G Produkte für Ihr Motorrad zu finden:

[R&G Racing | Alle Produkte für ENERGICA - EGO \(2021\) \(rg-racing.com\)](http://rg-racing.com)

AUSGABE 1 - 29/11/2022 (MH)

CONSUMER NOTICE

The catalogue description and any exhibition of samples are only broad indications of the Products and R&G may make design changes which do not diminish their performance or visual appeal and supplying them in such state shall conform to the order. The Buyer acknowledges no representation or warranty (other than as to title) has been given or will apply to the Products other than those in R&G's order or confirmation and the Buyer confirms it has chosen the Products as being of merchantable quality and suitable for its particular purposes. Where R&G fits the Products or undertakes other services it shall exercise reasonable skill and care and rectify any fault free of charge unless the workmanship has been disturbed. The Buyer is responsible for ensuring that the warranty on the motorcycle is not affected by the fitting of the Products. On return of any defective Products R&G shall at its option either supply a replacement or refund the purchase money but shall not be liable if the Products have been modified or used or maintained otherwise than in accordance with R&G's or manufacturer's instructions and good engineering practice or if the defect arises from accident or neglect. Other than identified above and subject to R&G not limiting its liability for causing death and personal injury, it shall not be liable for indirect or consequential loss and otherwise its liability shall be limited to the amounts paid by the Buyer for the Products or the fitting or service concerned. These terms do not affect the Buyer's statutory rights.

R&G RACING RETURNS POLICY (NON-FAULTY GOODS)

Returns must be pre-authorized (if not pre-authorized the return will be rejected). Goods may only be returned direct to us if they were purchased direct from us (customer must prove if necessary). Otherwise to be returned to original vendor. Goods must be in re-sellable condition, in the opinion of R&G Racing. All returns are subject to a 25% restocking and handling fee (25% of the gross value exc. P&P - at the prevailing price at time of purchase). The customer must pay any and all carriage charges. No returns of discontinued products, unless within 14 days of purchase. This policy does not affect your statutory rights and does not refer to faulty goods.

R&G Racing

Unit 1, Shelley's Lane, East Worldham, Alton, Hampshire, GU34 3AQ

Tel: +44 (0)1420 89007 Fax: +44 (0)1420 87301 www.rg-racing.com Email: info@rg-racing.com