



FITTING INSTRUCTIONS FOR DA0001BK
DASH GUARD



THIS KIT CONTAINS THE ITEMS PICTURED AND LABELLED OVER PAGE.

SOME PARTS MAY BE SHOWN FOR CLARITY OF INSTRUCTIONS ONLY.

DO NOT PROCEED UNTIL YOU ARE SURE ALL PARTS ARE PRESENT.

PLEASE READ ALL INSTRUCTIONS BEFORE PROCEEDING.

**IF IN ANY DOUBT WHEN FITTING OUR PRODUCTS, CONSULT ONE OF OUR DEALERS
OR HAVE FITTED BY A QUALIFIED TECHNICIAN.**

PLEASE NOTE THAT THE WAY THE KIT IS PACKED DOES NOT NECESSARILY REPRESENT THE WAY OF
MOUNTING TO THE BIKE.

IN THE EVENT OF RUBBER WASHERS BEING USED TO HOLD COMPONENTS ONTO BOLTS,
THESE RUBBER WASHERS CAN BE THROWN AWAY.

DIGITAL COPIES OF THESE INSTRUCTIONS ARE AVAILABLE FROM:

WWW.RG-RACING.COM



| <u>TOOLS REQUIRED</u> | <u>GENERAL TORQUE SETTINGS</u> |
|---|--|
| <ul style="list-style-type: none"> 2.5mm ALLEN KEY | <p>M4 BOLT = 8Nm M5 BOLT = 12Nm M6 BOLT = 15Nm M8 BOLT = 20Nm M10 BOLT = 40Nm M12 BOLT = 40Nm</p> |

LEGEND

| ITEM NO. | DESCRIPTION | QTY |
|----------|---|-----|
| ITEM 1 | M0722 - ALUMINIUM FACE PLATE | 1 |
| ITEM 2 | M0723 - ALUMINIUM BACK PLATE | 1 |
| ITEM 3 | PCS0009 - POLYCARBONATE CLEAR SCREEN | 1 |
| ITEM 4 | RS0005 - 310mm LENGTH OF SELF ADHESIVE SILICONE STRIP | 1 |
| ITEM 5 | FS0003BK - 100mm LENGTH OF SELF ADHESIVE FOAM | 1 |
| ITEM 6 | M4 x 0.7 x 15mm CAP HEAD BOLT | 4 |

FITTING PICTURES

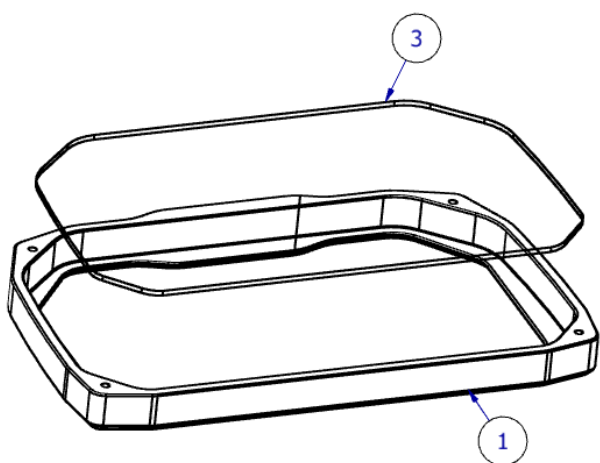

Picture 1

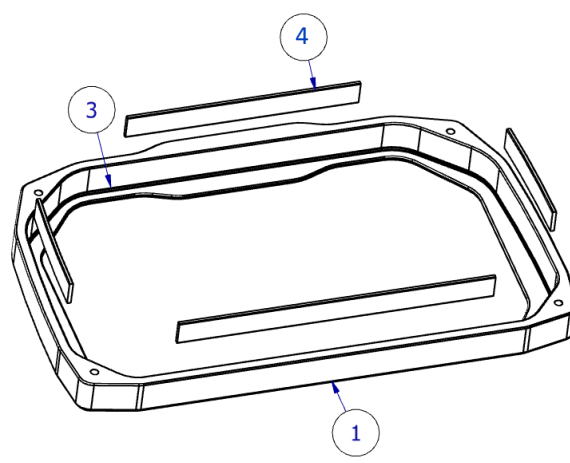

Picture 2

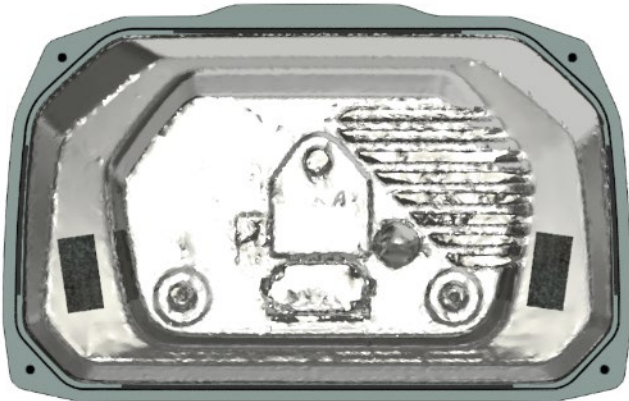

Picture 3

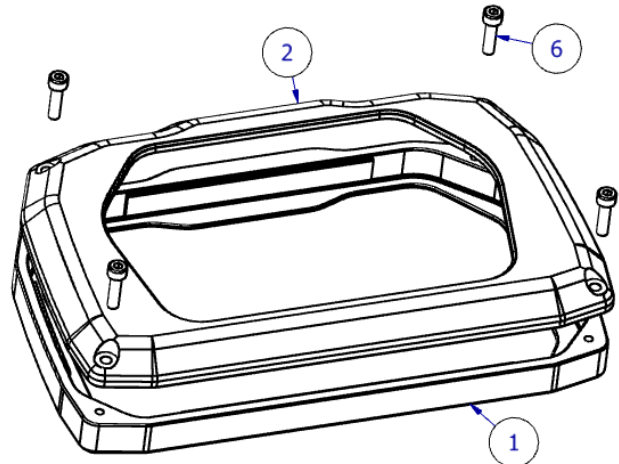

Picture 4

FITTING INSTRUCTIONS

- **DISCONNECT THE BATTERY BEFORE FITTING THIS PRODUCT.**
- Remove all covers and clips securing the dash to the front of the bike and disconnect the large connector from the back and remove from the bike carefully.
- Remove the protective film from the polycarbonate screen (**ITEM 3**) and insert it into the face plate (**ITEM 1**) as shown in **Picture 1**.
- Apply the self-adhesive silicone strip (**ITEM 4**) to the inside of the face plate (**ITEM 1**) as shown in **Picture 2**, this will also hold the polycarbonate screen (**ITEM 3**) in place.
- Cut the self-adhesive foam strip (**ITEM 5**) down into to a suitable size to be placed in the same positions as shown in **Picture 3**.
- Lastly, place the back plate (**ITEM 2**) over the back of the dash as shown in **Picture 4** and secure using the 4 x M4 bolts (**ITEM 6**) provided.

ISSUE 2 – 15/11/2023 (JH)

CONSUMER NOTICE

The catalogue description and any exhibition of samples are only broad indications of the Products and R&G may make design changes which do not diminish their performance or visual appeal and supplying them in such state shall conform to the order. The Buyer acknowledges no representation or warranty (other than as to title) has been given or will apply to the Products other than those in R&G's order or confirmation and the Buyer confirms it has chosen the Products as being of merchantable quality and suitable for its particular purposes. Where R&G fits the Products or undertakes other services it shall exercise reasonable skill and care and rectify any fault free of charge unless the workmanship has been disturbed. The Buyer is responsible for ensuring that the warranty on the motorcycle is not affected by the fitting of the Products. On return of any defective Products R&G shall at its option either supply a replacement or refund the purchase money but shall not be liable if the Products have been modified or used or maintained otherwise than in accordance with R&G's or manufacturer's instructions and good engineering practice or if the defect arises from accident or neglect. Other than identified above and subject to R&G not limiting its liability for causing death and personal injury, it shall not be liable for indirect or consequential loss and otherwise its liability shall be limited to the amounts paid by the Buyer for the Products or the fitting or service concerned. These terms do not affect the Buyer's statutory rights.

R&G RACING RETURNS POLICY (NON-FAULTY GOODS)

Returns must be pre-authorized (if not pre-authorized the return will be rejected). Goods may only be returned direct to us if they were purchased direct from us (customer must prove if necessary). Otherwise to be returned to original vendor. Goods must be in re-sellable condition, in the opinion of R&G Racing. All returns are subject to a 25% restocking and handling fee (25% of the gross value exc. P&P – at the prevailing price at time of purchase). The customer must pay any and all carriage charges. No returns of discontinued products, unless within 14 days of purchase. This policy does not affect your statutory rights and does not refer to faulty goods.

R&G Racing

Unit 1, Shelley's Lane, East Worldham, Alton, Hampshire, GU34 3AQ

Tel: +44 (0)1420 89007 Fax: +44 (0)1420 87301 www.rg-racing.com Email: info@rg-racing.com



NOTICE DE MONTAGE POUR DA0001BK
PROTECTION TABLEAU DE BORD



CE KIT CONTIENT LES ARTICLES ILLUSTRÉS ET ÉTIQUETES SUR LA PAGE.

CERTAINES PARTIES PEUVENT ÊTRE PRÉSENTES UNIQUEMENT POUR LA CLARTE DES INSTRUCTIONS.

NE PAS PROCÉDER AU MONTAGE TANT QUE VOUS N'ÊTES PAS SÛR QUE TOUTES LES PIÈCES SOIENT PRÉSENTES.

VEUILLEZ LIRE TOUTES LES INSTRUCTIONS AVANT DE CONTINUER.

EN CAS DE DOUTE LORS DU MONTAGE DE NOS PRODUITS, CONSULTEZ UN DE NOS REVENDEURS OU FAITES APPEL A UN TECHNICIEN QUALIFIÉ.

VEUILLEZ NOTER QUE LA FAÇON DONT LE KIT EST EMBALLÉ NE REPRÉSENTE PAS NECESSAIREMENT LA MANIÈRE DE LE MONTER SUR LA MOTO.

SI DES RONDELLES EN CAOUTCHOUC SONT UTILISÉES POUR MAINTENIR LES COMPOSANTS SUR LES BOULONS, ELLES PEUVENT ÊTRE JETÉES.

NOTICE DISPONIBLE AU TÉLÉCHARGEMENT SUR :

WWW.RG-RACING.COM

R&G Racing

Unit 1, Shelley's Lane, East Worldham, Alton, Hampshire, GU34 3AQ

Tel: +44 (0)1420 89007 Fax: +44 (0)1420 87301 www.rg-racing.com Email: info@rg-racing.com



| <u>TOOLS REQUIRED</u> | <u>VALEURS DE SERRAGE</u> |
|---|---|
| <ul style="list-style-type: none"> CLÉ ALLEN 2.5mm | BOULON M4 = 8Nm BOULON M5 = 12Nm BOULON M6 = 15Nm BOULON M8 = 20Nm BOULON M10 = 40Nm BOULON M12 = 40Nm |

LÉGENDE

| ARTICLE NO. | DESCRIPTION | QTÉ |
|--------------------|---|------------|
| ARTICLE 1 | M0722 - PLAQUE FAÇADE EN ALUMINIUM | 1 |
| ARTICLE 2 | M0723 - PLAQUE ARRIÈRE EN ALUMINIUM | 1 |
| ARTICLE 3 | PCS0009 - ÉCRAN TRANSPARENT EN POLYCARBONATE | 1 |
| ARTICLE 4 | RS0005 - 310mm LONGUEUR DE LA BANDE DE SILICONE AUTO-ADHÉSIVE | 1 |
| ARTICLE 5 | FS0003BK - 100mm LONGUEUR DE MOUSSE AUTO-ADHÉSIVE | 1 |
| ARTICLE 6 | M4 x 0.7 x 15mm BOULON | 4 |

PHOTOS DE MONTAGE

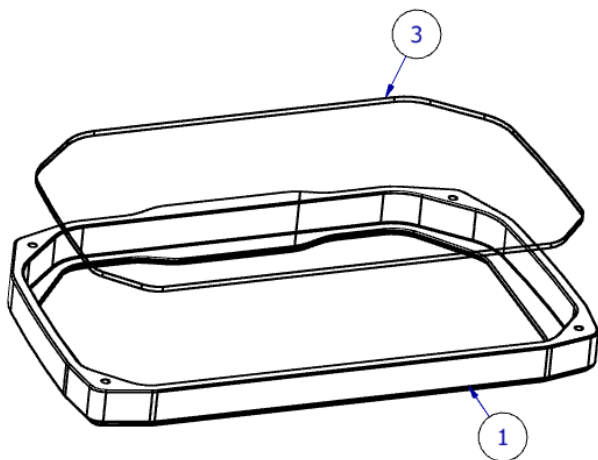

Photo 1

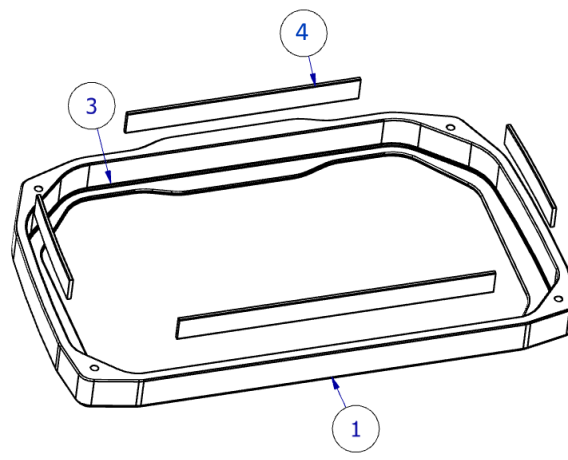

Photo 2

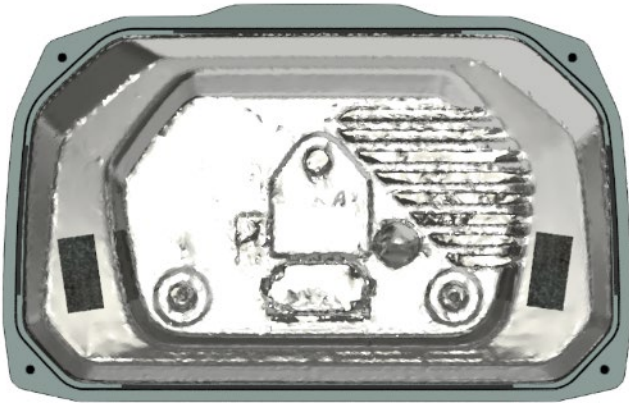

Photo 3

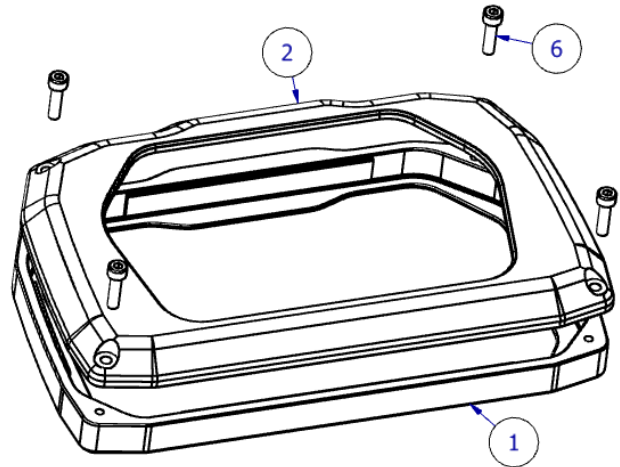

Photo 4

NOTICE DE MONTAGE

• DÉBRANCHEZ LA BATTERIE AVANT D'INSTALLER CE PRODUIT.

- Retirez tous les couvercles et clips fixant le tableau de bord à l'avant de la moto et débranchez le grand connecteur de l'arrière et retirez-le de la moto avec précaution.
- Retirez le film de protection de l'écran en polycarbonate (ARTICLE 3) et insérez-le dans la façade (ARTICLE 1) comme indiqué sur la Photo 1.
- Appliquez la bande autocollante en silicone (ARTICLE 4) à l'intérieur de la façade (ARTICLE 1) comme indiqué sur la Photo 2, cela maintiendra également l'écran en polycarbonate (ARTICLE 3) en place.
- Coupez la bande de mousse autocollante (ARTICLE 5) à une taille appropriée pour être placée dans les mêmes positions comme indiqué sur la Photo 3.
- Enfin, placez la plaque arrière (ARTICLE 2) sur l'arrière du tableau de bord comme indiqué sur la photo 4 et fixez-la à l'aide des 4 boulons M4 (ARTICLE 6) fournis.

Voir plus de produits R&G pour votre moto via ce lien :

[R&G Racing | All Products for BMW - F900R \(2022\) \(rg-racing.com\)](https://www.rg-racing.com)

ISSUE 1 - 25/01/2023 (AO)