



FITTING INSTRUCTIONS FOR CP0354BL CRASH PROTECTORS
YAMAHA MT 09 2013-2016

Page | 1



PICTURE A



PICTURE B



← REAR OF BIKE

FRONT OF BIKE →

PICTURE C

THIS KIT CONTAINS THE ITEMS PICTURED AND LABELLED BELOW.
DO NOT PROCEED UNTIL YOU ARE SURE ALL PARTS ARE PRESENT.

Please note that the way the kit is packed does not necessarily represent the way of mounting to the bike

Please note that in cases where kits are packed with rubber washers holding the components onto the bolt – *the rubber washers should be thrown away!*

THE PARTS SHOWN MAY BE REPRESENTATIVE ONLY (FOR CLARITY OF INSTRUCTIONS ONLY)

Digital copies of these instructions are available to download from www.rg-racing.com



Page 1

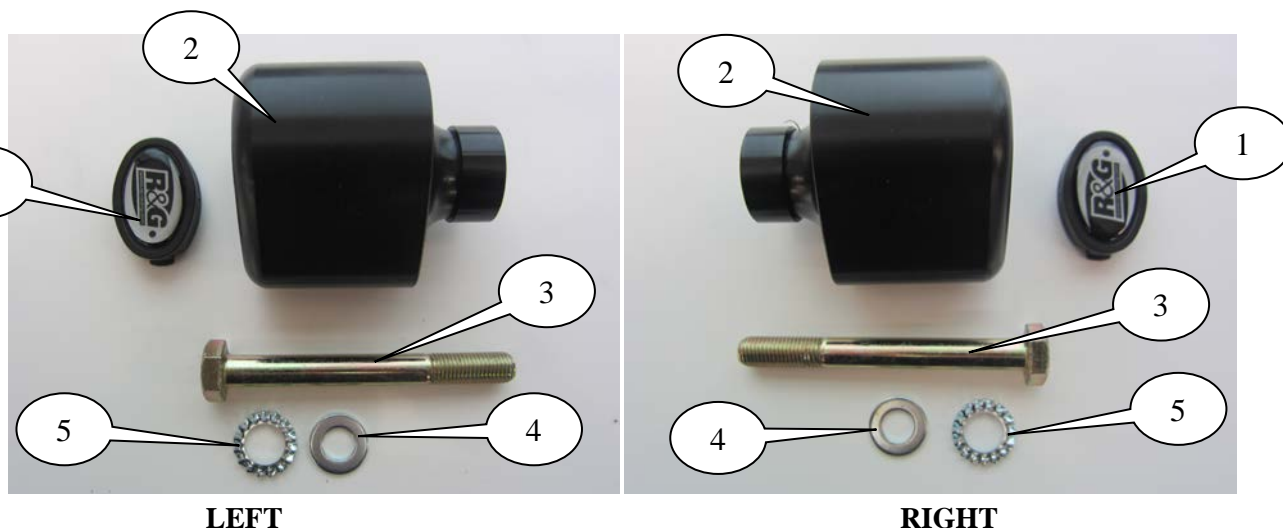

LEFT

RIGHT

TOOLS REQUIRED

- Socket set to include 17mm socket and wrench.
- Socket set to include 8mm A/F socket and wrench.
 - Torque wrench (up to 40 Nm).

LEGEND

ITEM 1 = BC0002 CRASH PROTECTOR CAPS (x2).

ITEM 2 = B0431 with CS341 (10mm) & S0255 SPACER FITTED (CRASH PROTECTORS) (x2).

ITEM 3 = M10x1.25x90mm LONG HEX HEAD BOLT (x2).

ITEM 4 = M10 PLAIN WASHERS (x2).

ITEM 5 = LW0001 (SHAKE PROOF WASHERS) (x2).

FITTING INSTRUCTIONS

Left Side (as you sit on bike)

- Remove the engine bolt on the left side of the bike, as arrowed in picture A.
- Slide one of the 10mm washers (item 4) onto the M10x90mm long hexagon headed bolt (item 3) so the washer sits against head of bolt.
- Slide serrated locking washer (item 5) over the bolt so it sits against washer just fitted.
- Next slide the bolt with washers through either crash protector (item 2) so head of bolt and washers goes into counter-bore in bobbin.
- Offer the crash protector assembly up to the frame mount and begin to tighten the bolt as shown in picture A.
- Tighten the bolt until you feel some compression from inside the protector using 17mm socket and wrench. **PLEASE NOTE THE CRASH PROTECTOR MUST BE POSITIONED AS IN PICTURE 'C' WITH BIGGER END TOWARD FRONT OF BIKE.** Turn a little more so that you feel the compression increase slightly. Then apply a quarter turn. **Tighten to 40Nm of torque (do not exceed this figure, as damage can occur to the motorcycle and the bolt).**
- If not already fitted fit bubble stickers into recess of both crash protector caps.
- Fit crash protector caps (item 1) into both crash protectors.

R&G Racing

Unit 1, Shelley's Lane, East Worldham, Alton, Hampshire, GU34 3AQ

Tel: +44 (0)1420 89007 Fax: +44 (0)1420 87301 www.rg-racing.com Email: info@rg-racing.com



Right Side (as you sit on bike)

- Remove the engine bolt on the left side of the bike, as arrowed in picture B.
- Slide one of the 10mm washers (item 4) onto the M10x90mm long hexagon headed bolt (item 3) so the washer sits against head of bolt.
- Slide serrated locking washer (item 5) over the bolt so it sits against washer just fitted.
- Next slide the bolt with washers through either crash protector (item 2) so head of bolt and washers goes into counter-bore in bobbin.
- Offer the crash protector assembly up to the frame mount and begin to tighten the bolt as shown in picture B.
- Tighten the bolt until you feel some compression from inside the protector using 17mm socket and wrench. **PLEASE NOTE THE CRASH PROTECTOR MUST BE POSITIONED AS IN PICTURE 'C' WITH BIGGER END TOWARD FRONT OF BIKE.** Turn a little more so that you feel the compression increase slightly. Then apply a quarter turn. **Tighten to 40Nm of torque (do not exceed this figure, as damage can occur to the motorcycle and the bolt).**
- If not already fitted fit bubble stickers into recess of both crash protector caps.
- Fit crash protector caps (item 1) into both crash protectors.

GENERAL TORQUE SETTINGS

M4 BOLT = 8Nm
 M5 BOLT = 12Nm
 M6 BOLT = 15Nm
 M8 BOLT = 20Nm
 M10 BOLT = 40Nm

Issue 2 26/08/2016 (NSY)

CONSUMER NOTICE

The catalogue description and any exhibition of samples are only broad indications of the Products and R&G may make design changes which do not diminish their performance or visual appeal and supplying them in such state shall conform to the order. The Buyer acknowledges no representation or warranty (other than as to title) has been given or will apply to the Products other than those in R&G's order or confirmation and the Buyer confirms it has chosen the Products as being of merchantable quality and suitable for its particular purposes. Where R&G fits the Products or undertakes other services it shall exercise reasonable skill and care and rectify any fault free of charge unless the workmanship has been disturbed. The Buyer is responsible for ensuring that the warranty on the motorcycle is not affected by the fitting of the Products. On return of any defective Products R&G shall at its option either supply a replacement or refund the purchase money but shall not be liable if the Products have been modified or used or maintained otherwise than in accordance with R&G's or manufacturer's instructions and good engineering practice or if the defect arises from accident or neglect. Other than identified above and subject to R&G not limiting its liability for causing death and personal injury, it shall not be liable for indirect or consequential loss and otherwise its liability shall be limited to the amounts paid by the Buyer for the Products or the fitting or service concerned. These terms do not affect the Buyer's statutory rights.

R&G RACING RETURNS POLICY (NON-FAULTY GOODS)

Returns must be pre-authorized (if not pre-authorized the return will be rejected). Goods may only be returned direct to us if they were purchased direct from us (customer must prove if necessary). Otherwise to be returned to original vendor. Goods must be in re-sellable condition, in the opinion of R&G Racing. All returns are subject to a 25% restocking and handling fee (25% of the gross value exc. P&P – at the prevailing price at time of purchase). The customer must pay any and all carriage charges. No returns of discontinued products, unless within 14 days of purchase. This policy does not affect your statutory rights and does not refer to faulty goods.

R&G Racing

Unit 1, Shelley's Lane, East Worldham, Alton, Hampshire, GU34 3AQ

Tel: +44 (0)1420 89007 Fax: +44 (0)1420 87301 www.rg-racing.com Email: info@rg-racing.com



**INSTRUCTIONS DE MONTAGE POUR CP0354BL PROTECTIONS CRASH
YAMAHA MT 09 2013-**

Page | 4

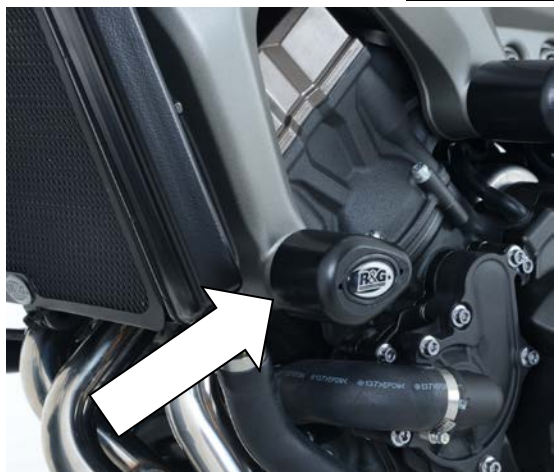

PHOTO A



PHOTO B



ARRIÈRE MOTO

AVANT MOTO

PHOTO C

LE KIT CONTIENT LES ARTICLES EXPOSES CI-DESSOUS, VERIFIER QUE TOUTES LES PIÈCES SOIENT PRÉSENTES AVANT DE PROCÉDER AU MONTAGE.

LA FAÇON DONT LE KIT EST EMBALLE NE CORRESPOND PAS FORCEMENT A LA FAÇON DE MONTER LES PIÈCES SUR LA MOTO.

Notez que si les kits sont emballés avec des rondelles en caoutchouc servant à tenir les composants, *ces rondelles doivent être jetées.*

LES PARTIES PRÉSENTÉES PEUVENT ÊTRE UNIQUEMENT REPRESENTATIVES (POUR LA CLARTE DES INSTRUCTIONS UNIQUEMENT).

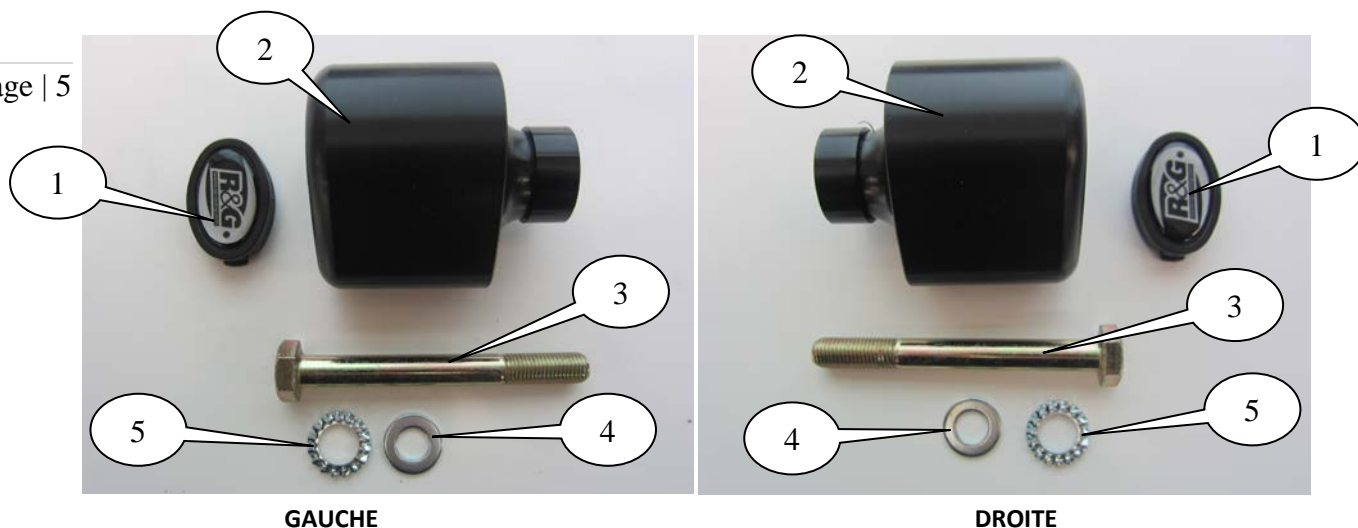

GAUCHE

DROITE

Outils requis :

- Jeu de clés 17mm.
- Jeu de clés 8mm.
- Clé dynamométrique (à 40 Nm).

LEGENDE

ARTICLE 1 = BC0002 CAPUCHONS DE PROTECTION CRASH (x2).

ARTICLE 2 = B0431 avec CS341 (10mm) & S0255 ENTRETOISE (PROTECTION CRASH) (x2).

ARTICLE 3 = M10x1.25x90mm BOULON (x2).

ARTICLE 4 = M10 RONDELLES (x2).

ARTICLE 5 = LW0001(RONDELLES ANTI VIBRATION) (x2).

INSTRUCTIONS DE MONTAGE :

Coté gauche (assis sur la moto) :

- Enlever le boulon moteur coté gauche de la moto (Photo A).
- Glisser une des rondelles 10mm (Article 4) sur le boulon M10x90mm (Article 3) de façon à ce que la rondelle se place contre la tête du boulon.
- Glisser une rondelle de blocage (Article 5) sur le boulon de façon à ce qu'elle se place contre la rondelle qui vient d'être placée.
- Glisser ensuite le boulon avec rondelles à travers la protection crash (Article 2) de façon à ce que la tête du boulon et les rondelles se placent dans le contre alésage de la bobine de protection.
- Monter l'ensemble de protection sur le cadre et commencer à serrer le boulon (Photo A).
- Serrez les boulons jusqu'à ce que vous sentiez une légère compression de l'intérieur de la protection, à l'aide d'une clé de 17 mm. **LA PROTECTION DOIT ETRE POSITIONNEE COMME EN "C" AVEC LE COTE ARRONDI LE PLUS GROS EN DIRECTION DE L'AVANT DE LA MOTO.**

R&G Racing

Unit 1, Shelley's Lane, East Worldham, Alton, Hampshire, GU34 3AQ

Tel: +44 (0)1420 89007 Fax: +44 (0)1420 87301 www.rg-racing.com Email: info@rg-racing.com



Tourner un peu plus afin d'accentuer légèrement la compression. Faire un quart de tour.
Serrer à 40Nm de couple (Ne pas excéder cette valeur, cela pourrait cause des dommages sur la moto et le boulon).

- Mettre le sticker de caoutchouc dans le creux des capuchons de la protection.
- Mettre les 2 capuchons (Article 1) sur les protections.

Page | 6

Coté droit (assis sur la moto)

- Enlever le boulon moteur coté droit de la moto (Photo B).
- Glisser une des rondelles 10mm (Article 4) sur le boulon M10x90mm (Article 3) de façon à ce que la rondelle se place contre la tête du boulon.
- Glisser une rondelle de blocage (Article 5) sur le boulon de façon à ce qu'elle se place contre la rondelle qui vient d'être placée.
- Glisser ensuite le boulon avec rondelles à travers la protection crash (Article 2) de façon à ce que la tête du boulon et les rondelles se placent dans le contre alésage de la bobine de protection.
- Monter l'ensemble de protection sur le cadre et commencer à serrer le boulon (Photo B).
- Serrez les boulons jusqu'à ce que vous sentiez une légère compression de l'intérieur de la protection, à l'aide d'une clé de 17 mm. **LA PROTECTION DOIT ETRE POSITIONNEE COMME EN "C" AVEC LE COTE ARRONDI LE PLUS GROS EN DIRECTION DE L'AVANT DE LA MOTO.**
Tourner un peu plus afin d'accentuer légèrement la compression. Faire un quart de tour.
Serrer à 40Nm de couple (Ne pas excéder cette valeur, cela pourrait cause des dommages sur la moto et le boulon).
- Mettre le sticker de caoutchouc dans le creux de capuchon de la protection.
- Mettre les 2 capuchons (Article 1) sur les protections.

COUPLES DE SERRAGE GENERAUX

M4 BOULON = 8Nm
M5 BOULON = 12Nm
M6 BOULON = 15Nm
M8 BOULON = 20Nm
M10 BOULON = 40Nm

Issue 1 18/10/2013 (NSY)

CONSUMER NOTICE

The catalogue description and any exhibition of samples are only broad indications of the Products and R&G may make design changes which do not diminish their performance or visual appeal and supplying them in such state shall conform to the order. The Buyer acknowledges no representation or warranty (other than as to title) has been given or will apply to the Products other than those in R&G's order or confirmation and the Buyer confirms it has chosen the Products as being of merchantable quality and suitable for its particular purposes. Where R&G fits the Products or undertakes other services it shall exercise reasonable skill and care and rectify any fault free of charge unless the workmanship has been disturbed. The Buyer is responsible for ensuring that the warranty on the motorcycle is not affected by the fitting of the Products. On return of any defective Products R&G shall at its option either supply a replacement or refund the purchase money but shall not be liable if the Products have been modified or used or maintained otherwise than in accordance with R&G's or manufacturer's instructions and good engineering practice or if the defect arises from accident or neglect. Other than identified above and subject to R&G not limiting its liability for causing death and personal injury, it shall not be liable for indirect or consequential loss and otherwise its liability shall be limited to the amounts paid by the Buyer for the Products or the fitting or service concerned. These terms do not affect the Buyer's statutory droites.

R&G RACING RETURNS POLICY (NON-FAULTY GOODS)

Returns must be pre-authorized (if not pre-authorized the return will be rejected). Goods may only be returned direct to us if they were purchased direct from us (customer must prove if necessary). Otherwise to be returned to original vendor. Goods must be in re-sellable condition, in the opinion of R&G Racing. All returns are subject to a 25% restocking and handling fee (25% of the gross value exc. P&P – at the prevailing price at time of purchase). The customer must pay any and all carriage charges. No returns of discontinued products, unless within 14 days of purchase. This policy does not affect your statutory droites and does not refer to faulty goods.

R&G Racing

Unit 1, Shelley's Lane, East Worldham, Alton, Hampshire, GU34 3AQ

Tel: +44 (0)1420 89007 Fax: +44 (0)1420 87301 www.rg-racing.com Email: info@rg-racing.com